

15-113-00614

KANSAS DRILLERS LOG

API No. 15 ————— OWWO
County Number

S. 1 T. 18S R. 4 E
W

Loc. SE SE NE

County McPherson

Operator
Rupe Oil Company, Inc.

Address
P. O. Box 2273, Wichita, Kansas 67201

Well No. 1 Lease Name Underwood

Footage Location
2310 feet from (N) (X) line 330 feet from (E) (W) line

Principal Contractor Mohawk Drilling Company Engineer: John J. Cecil, Jr.

Spud Date March 1, 1977 Total Depth 3535' P.B.T.D. 3535

Date Completed March 10, 1977 Oil Purchaser

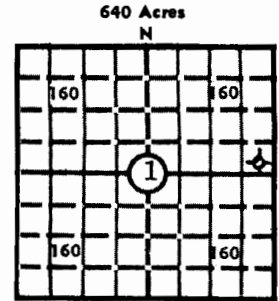

Elev.: Gr. 1365'

DF _____ KB _____

CASING RECORD

Report of all strings set — surface, intermediate, production, etc.

Purpose of string	Size hole drilled	Size casing set (in O.D.)	Weight lbs/ft.	Setting depth	Type cement	Sacks	Type and percent additives
Surface		13 3/8"		157'	Already in Place		
Surface		8 5/8"		374'	Already in Place		
Production		5 1/2"		3547'	Already in Place		

LINER RECORD

PERFORATION RECORD

Top, ft.	Bottom, ft.	Sacks cement	Shots per ft.	Size & type	Depth interval
			2	DP	3392'-96'

Size	Setting depth	Packer set at

ACID, FRACTURE, SHOT, CEMENT SQUEEZE RECORD

Amount and kind of material used	Depth interval treated
Acidized wf 1000 gals. 15% SME Acid	3392-96'

INITIAL PRODUCTION

Date of first production		Producing method (flowing, pumping, gas lift, etc.)			
RATE OF PRODUCTION PER 24 HOURS	Oil	Gas	Water	Gas-oil ratio	
	bbis.	MCF	bbis.	CFPB	
Disposition of gas (vented, used on lease or sold)			Producing interval (s)		

INSTRUCTIONS: As provided in KCC Rule 82-2-125, within 90 days after completion of a well, one completed copy of this Drillers Log shall be transmitted to the State Geological Survey of Kansas, 4150 Monroe Street, Wichita, Kansas 67209. Copies of this form are available from the Conservation Division, State Corporation Commission, 3830 So. Meridian (P.O. Box 17027), Wichita, Kansas 66217. Phone AC 316-522-2206. If confidential custody is desired, please note Rule 82-2-125. Drillers Logs will be on open file in the Oil and Gas Division, State Geological Survey of Kansas, Lawrence, Kansas 66044.

Operator **RUPE OIL COMPANY, INC.** DESIGNATE TYPE OF COMP.: OIL, GAS, DRY HOLE, SWDW, ETC.: **Dry Hole**

Well No. **1** Lease Name **Underwood**

S 1 T 18S R 4 ^X/_W

WELL LOG

Show all important zones of porosity and contents thereof; cored intervals, and all drill-stem tests, including depth interval tested, cushion used, time tool open, flowing and shut-in pressures, and recoveries.

SHOW GEOLOGICAL MARKERS, LOGS RUN, OR OTHER DESCRIPTIVE INFORMATION.

FORMATION DESCRIPTION, CONTENTS, ETC.	TOP	BOTTOM	NAME	DEPTH
No Logs			Mississippi	2926'
			Maquoketa Dolomite	3390'
			Simpson Sand	3514'

USE ADDITIONAL SHEETS, IF NECESSARY, TO COMPLETE WELL RECORD.

Date Received	Rupe Oil Company, Inc.
	<i>William G. Clement</i>
	William G. Clement, Petroleum Geologist
	Title
	July 4, 1977
	Date