

KANSAS

WELL COMPLETION REPORT AND DRILLER'S LOG

State Geological Survey WICHITA BRANCH

S. 30 T. 18s R. 6 W

Loc. NW SE NE

County Rice

API No. 15 - 159 - 21,239 County Number

Operator R & B Petroleum, Inc.

Address P.O. Box 1065, Great Bend, Kansas 67530

Well No. 1 Lease Name Hodgson 'A'

Footage Location 1650 feet from (N) line 990 feet from (E) line

Principal Contractor Allen Drilling Company Geologist Randy Lilak

Spud Date 7-28-81 Date Completed 8-2-81 Total Depth 3225 P.B.T.D. 3203

Directional Deviation 1° Oil and/or Gas Purchaser NCRA

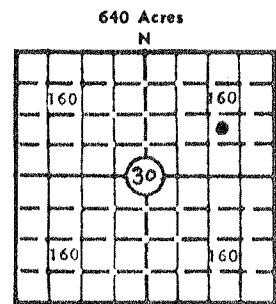

Locate well correctly Elev.: Gr. 1642

DF 1645 KB 1647

CASING RECORD

Report of all strings set - surface, intermediate, production, etc.

Table with 8 columns: Purpose of string, Size hole drilled, Size casing set (in O.D.), Weight lbs/ft., Setting depth, Type cement, Sacks, Type and percent additives. Rows include Surface and Production data.

LINER RECORD

PERFORATION RECORD

Tables for Liner Record (Top, Bottom, Sacks cement) and Perforation Record (Shots per ft., Size & type, Depth interval). Includes Tubing Record (Size, Setting depth, Packer set at).

ACID, FRACTURE, SHOT, CEMENT SQUEEZE RECORD

Table with 2 columns: Amount and kind of material used, Depth interval treated. Rows include Acid 500 gal. and Acid 2000 gal. treatments.

RELEASED AUG 1 1982 FROM CONFIDENTIAL

INITIAL PRODUCTION

Date of first production August 27, 1981 Producing method (flowing, pumping, gas lift, etc.) Pumping

RATE OF PRODUCTION PER 24 HOURS Oil 7 bbls. Gas ----- MCF 26 Water 26 bbls. Gas-oil ratio CFPB

Disposition of gas (vented, used on lease or sold) Producing interval(s) 2987 - 2991

INSTRUCTIONS: As provided in KCC Rule 82-2-125, within 90 days after completion of a well, one completed copy of this Drillers Log shall be transmitted to the State Geological Survey of Kansas, 4150 Monroe Street, Wichita, Kansas 67209.

Operator
R & B Petroleum, Inc.

DESIGNATE TYPE OF COMP.: OIL, GAS,
DRY HOLE, SWDW, ETC.:

Well No. 1 Lease Name Hodgson 'A' Oil Well

S 30 T 18s R 6 W NW SE NE

WELL LOG

Show all important zones of porosity and contents thereof; cored intervals, and all drill-stem tests, including depth interval tested, cushion used, time tool open, flowing and shut-in pressures, and recoveries.

SHOW GEOLOGICAL MARKERS, LOGS RUN, OR OTHER DESCRIPTIVE INFORMATION.

FORMATION DESCRIPTION, CONTENTS, ETC.	TOP	BOTTOM	NAME	DEPTH
DST #1 3018 - 3075 Times: 30"-30"-30"-30" Rec: 5' M/SSO SIP: 79-34# FP: 45-22#/45-22# HP: 1586# DST #2 2977 - 3000 (Straddle) Times: 60"-60"-90"-90" Rec: 182' SGHOCM SIP: 1186-1155# FP: 41-61#/92-103# HP: 1646#			Log Tops: Heebner Douglas Brown Lime Lansing Base KC Marmaton Cherokee Kinderhook TD Welex Log:	2554 2594 2685 2735 3083 3092 3145 3179 3225 Gamma-Guard Sidewall Neutr Caliper

USE ADDITIONAL SHEETS, IF NECESSARY, TO COMPLETE WELL RECORD.

Date Received	<i>Robert D. Dougherty</i> Signature
	Robert D. Dougherty - Geologist Title
	Sept. 14, 1981 Date

MICHELLE BEVICH

30-18-6W

DRILLER'S WELL LOG

State Geological Survey
WICHITA BRANCH

DATE COMMENCED: 07/28/81
DATE COMPLETED: 08/02/81

R & B Petroleum, Inc.
HODGSON "A" No. 1
NW SE NE
Sec. 30, Twp. 18S, Rge. 6W,
Rice County, Kansas

ELEVATION: 1642' G.L.
1647' K.B.

FORMATION DATA:

Tops not released by
company geologist,

SURFACE PIPE:

Ran 5 jts. 20#, new 8-5/8"
casing; tally: 214'; Set
@ 221' w/130 sks 60/40 poz.,
2% gel, 3% cc., cement. circ.
Plug down 7 PM, 8/2/81
By Sun

PRODUCTION PIPE:

Ran 78 jts. 9.5# 4 1/2" csg.
Tally: 3226'
Set @ 3224' w/ 125 sks 60/40
poz., 18% salt, 18 bbl. salt
flush, plug down 2:30 PM,
8/2/81, By Howco

A F F I D A V I T

STATE OF KANSAS)
COUNTY OF BARTON) ss.

Ray Goans, of lawful age, does swear and state that the