

KANSAS

SEP 2nd  
P(

WELL COMPLETION REPORT AND  
DRILLER'S LOG

RELEASED

S. 30 T. 18s R. 6 W

API No. 15 — 159 — 21,193  
County Number Date

Loc. SE SW SE

County Rice

Operator  
R & B Petroleum, Inc.

FROM CONFIDENTIAL

Address  
P.O. Box 1065, Great Bend, Kansas 67530

Well No. 1 Lease Name Perry 'B'

Footage Location  
330 feet from (X) (S) line 1650 feet from (E) (W) line

Principal Contractor Allen Drilling Co. Geologist Randall M. Lilak

Spud Date 6-1-81 Date Completed 6-28-81 Total Depth 3228' P.B.T.D. 3110'

Directional Deviation 2 1/2° Oil and/or Gas Purchaser

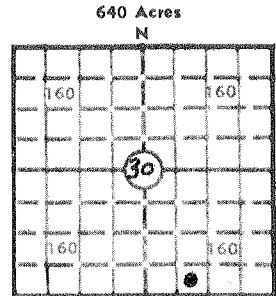

Elev.: Gr. 1641

DF 1643 KB 1646

CASING RECORD

Report of all strings set — surface, intermediate, production, etc.

Purpose of string	Size hole drilled	Size casing set (in O.D.)	Weight lbs/ft.	Setting depth	Type cement	Sacks	Type and percent additives
Surface	12 1/4"	8 5/8"	20#	228	60/40 Pozmix	160	2% gel, 3% CaCl
Production	7 7/8"	4 1/2"	9.5#	3140	60/40 Pozmix	100	18% salt, 75% CFR- 15 bbls. of salt Flush ahead of ceme

LINER RECORD

PERFORATION RECORD

Top, ft.	Bottom, ft.	Sacks cement	Shots per ft.	Size & type	Depth interval
			3	Welex SSB	3058 - 3063
			2	Welex SSB	2990 - 2998

TUBING RECORD

Size	Setting depth	Packer set at

ACID, FRACTURE, SHOT, CEMENT SQUEEZE RECORD

Amount and kind of material used	Depth interval treated
Acid/500 gal. Dowell XW-35, A/2000 gal.	3058 - 3063

INITIAL PRODUCTION

Date of first production 12/9/81	Producing method (flowing, pumping, gas lift, etc.) Pumping
RATE OF PRODUCTION PER 24 HOURS	Oil 4 bbls. Gas MCF 46 bbls. Water Gas-oil ratio CFPB
Disposition of gas (vented, used on lease or sold)	Producing interval (s) 3058 - 63, 2990 - 98

INSTRUCTIONS: As provided in KCC Rule 82-2-125, within 90 days after completion of a well, one completed copy of this Drillers Log shall be transmitted to the State Geological Survey of Kansas, 4150 Monroe Street, Wichita, Kansas 67209. Copies of this form are available from the Conservation Division, State Corporation Commission, 245 No. Water, Wichita, Kansas 67202. Phone AC 316-522-2206. If confidential custody is desired, please note Rule 82-2-125. Drillers Logs will be on open file in the Oil and Gas Division, State Geological Survey of Kansas, Lawrence, Kansas 66044.

Operator  
R & B Petroleum, Inc.

DESIGNATE TYPE OF COMP.: OIL, GAS,  
DRY HOLE, SWDW, ETC.:

Well No. 1 Lease Name Perry 'B' Oil Well

S 30 T 18 S R 6 <sup>K</sup>/<sub>W</sub> SE SW SE

**WELL LOG**

Show all important zones of porosity and contents thereof; cored intervals, and all drill-stem tests, including depth interval tested, cushion used, time tool open, flowing and shut-in pressures, and recoveries.

SHOW GEOLOGICAL MARKERS, LOGS RUN, OR OTHER DESCRIPTIVE INFORMATION.

FORMATION DESCRIPTION, CONTENTS, ETC.	TOP	BOTTOM	NAME	DEPTH
<p>DST #1 2937-2968 ft. (Log=2938-2969)</p> <p>Time: 30''-60''-30''-60''</p> <p>Recovered: 2 ft. heavy oil &amp; gas cut mud</p> <p>300 ft. muddy water</p> <p>ISIP: 1241# IFP: 56-79#</p> <p>FSIP: 1218# FFP: 136-159#</p> <p>HP: 1553#</p>			<p>Heebner 2560</p> <p>Brown Lime 2696</p> <p>'White' Lime 2737</p> <p>Lansing 2746</p> <p>Base KC 3085</p> <p>Cherokee 3150</p> <p>Kinderhook 3180</p> <p>Rotary TD 3225</p> <p>Log TD 3228</p>	
<p>DST #2 2982-3005 ft. (Log=2986-3009)</p> <p>Time: 30''-60''-90''-60''</p> <p>Recovered: 10 ft. oil and gas cut mud (About 10% oil)</p> <p>120 ft. thin mud</p> <p>ISIP: 1386# IFP: 56-45#</p> <p>FSIP: 1352# FFP: 68-68#</p> <p>HP: 1575#</p>				
<p>DST #3 3044-3070 ft. (Log=3047-3073)</p> <p>Time: 30''-60''-60''-60''</p> <p>Recovered: 60 ft. oil &amp; gas cut mud (About 10% oil)</p> <p>60 ft. mud</p> <p>Good show of free oil in tool.</p> <p>ISIP: 1520# IFP: 45-34#</p> <p>FSIP: 1460# FFP: 56-56#</p> <p>HP: 1575-1564#</p>				

USE ADDITIONAL SHEETS, IF NECESSARY, TO COMPLETE WELL RECORD.

Date Received	<p><i>Robert D. Dougherty</i> Signature</p> <p>Robert D. Dougherty - Geologist Title</p> <p>January 7, 1982 Date</p>
---------------	----------------------------------------------------------------------------------------------------------------------------------

P1

30-18-6W

State Geological Survey  
WICHITA BRANCH

SEP

DRILLER'S WELL LOG

DATE COMMENCED: 06/01/81  
DATE COMPLETED: 06/08/81

R. & B Petroleum, Inc.  
PERRY B No. 1  
SE SW SE  
Sec. 30, Twp. 18S, Rge. 6W  
Rice County, KS

ELEVATION: G.L.  
K.B.

FORMATION DATA:

2588 - 2577'	Shale
2577 - 2597'	Lime
2597 - 2694'	Shale
2694 - 2742'	Lime, shale
2742 - 3082'	Lime
3082 - 3146'	Lime, shale
3146 - 3225'	Shale, lime, chert, sand
3225 -	RTD

Heebner	2588'
Toronto	2577'
Douglas	2597'
Brown Lime	2694'
Lansing	2742'
Base KC	3082'
Conglomerate	3146'
RTD	3225'

SURFACE PIPE:

Ran 6 jts. 20# new 8-5/8" casing; tally: 224.50'  
Set @ 231' w/ 160 sks 60/40 poz., 2% gel, 3% c.c., cement. circ., plug down 2:30 A.M., 6/2/81 By Sun

PRODUCTION PIPE:

Ran 79 jts. 4-1/2" casing, Tally: 3140', Set @ 3140' w/100 sks 60/40, 18% salt, 15 Salt Flush, Plug down 4:00 PM, 6/8/81 By Howco

A F F I D A V I T

RECEIVED  
STATE CORPORATION COMMISSION

JUN 15 1981

CONSERVATION DIVISION  
Wichita, Kansas

STATE OF KANSAS )  
COUNTY OF BARTON ) ss.

Roy Goans, of lawful age, does swear and state that the facts and statements herein contained are true and correct to the best