



SIDE ONE

Ind p1

STATE CORPORATION COMMISSION OF KANSAS
OIL & GAS CONSERVATION DIVISION

WELL COMPLETION OR RECOMPLETION FORM
ACO-1 WELL HISTORY

DESCRIPTION OF WELL AND LEASE

Operator: License # 6588
Name Woodman-Iannitti Oil Co.
Address 704 Union Center Bldg.
City/State/Zip Wichita, KS 67202

Purchaser Farmland Industries, Inc.
Kansas City, Missouri

Operator Contact Person K.T. Woodman
Phone (316) 265-7650

Contractor: License # 5122
Name Woodman-Iannitti Drlg. Co.

Wellsite Geologist Don Moore
Phone (316) 265-7541

Designate Type of Completion

- New Well Re-Entry Workover
- Oil SWD Temp Abd
- Gas Inj Delayed Comp.
- Dry Other (Core, Water Supply etc.)

If OWO: old well info as follows:

Operator
Well Name
Comp. Date Old Total Depth.....

WELL HISTORY

Drilling Method:

- Mud Rotary Air Rotary Cable

8-28-85	9-2-85	9-28-85
Spud Date	Date Reached TD	Completion Date
3650'	3399'	
Total Depth	PBTD	

Amount of Surface Pipe Set and Cemented at 255 feet
Multiple Stage Cementing Collar Used? Yes No
If yes, show depth set.....feet
If alternate 2 completion, cement circulated
from.....feet depth to.....w/.....SX cmt

API NO. 15-009-24,043

County Barton

C. E/2 E/2 NE Sec. 26 Twp. 19 Rge. 12 East West

3960 Ft North from Southeast Corner of Section
330 Ft West from Southeast Corner of Section
(Note: Locate well in section plat below)

Lease Name Apel Well # 1

Field Name Cheyenne View

Producing Formation Arbuckle

Elevation: Ground 1800 1805 KB

Section Plat

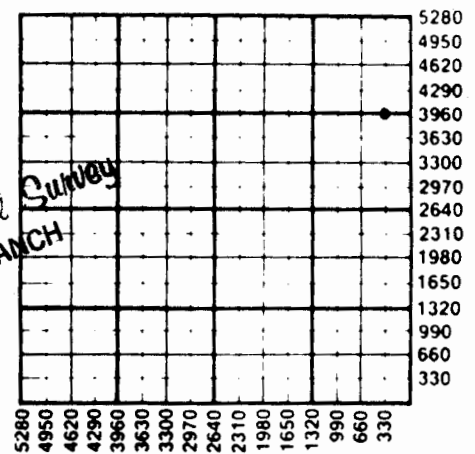

NOV 04 1985
State Geological Survey
WICHITA BRANCH

WATER SUPPLY INFORMATION

Disposition of Produced Water: Disposal
Docket # N/A Repressuring

Questions on this portion of the ACO-1 call:

Water Resources Board (913) 296-3717

Source of Water:

Division of Water Resources Permit # Applied For

Groundwater.....Ft North from Southeast Corner
(Well)Ft West from Southeast Corner of
Sec 26 Twp 19 Rge 12 East West

Surface Water.....Ft North from Southeast Corner
(Stream, pond etc).....Ft West from Southeast Corner
Sec Twp Rge East West

Other (explain).....
(purchased from city, R.W.D. #)

INSTRUCTIONS: This form shall be completed in duplicate and filed with the Kansas Corporation Commission, 200 Colorado Derby Building, Wichita, Kansas 67202, within 90 days after completion or recompletion of any well. Rule 82-3-130 and 82-3-107 apply.

Information on side two of this form will be held confidential for a period of 12 months if requested in writing and submitted with the form. See rule 82-3-107 for confidentiality in excess of 12 months.

One copy of all wireline logs and drillers time log shall be attached with this form. Submit CP-4 form with plugged wells. Submit CP-111 form with all temporarily abandoned wells.

SIDE TWO

Operator Name Woodman-Iannitti Oil Co. Lease Name Apel Well # 1

Sec. 26 Twp. 19S Rge. 12 East West County Barton

WELL LOG

INSTRUCTIONS: Show important tops and base of formations penetrated. Detail all cores. Report all drill stem tests giving interval tested, time tool open and closed, flowing and shut-in pressures, whether shut-in pressure reached static level, hydrostatic pressures, bottom hole temperature, fluid recovery, and flow rates if gas to surface during test. Attach extra sheet if more space is needed. Attach copy of log.

Drill Stem Tests Taken	<input checked="" type="checkbox"/> Yes	<input type="checkbox"/> No
Samples Sent to Geological Survey	<input type="checkbox"/> Yes	<input checked="" type="checkbox"/> No
Cores Taken	<input type="checkbox"/> Yes	<input checked="" type="checkbox"/> No

Sand	0	100
Shale	100	150
Iron Pyrite	150	160
Iron Pyrite	160	170
Shale	170	259
Red Bed, Shale	259	640
Shale	640	1515
Shale	1515	1960
Shale	1960	2360
Shale	2360	2705
Shale	2705	2930
Shale & Lime	2930	3170
Lime	3170	3305
Lime	3305	3364
Lime, Arbuckle	3364	3369
Arbuckle	3369	3372
Arbuckle	3372	3420
Arbuckle	3420	2558
Arbuckle	3558	3650

Formation Description		
<input checked="" type="checkbox"/> Log	<input type="checkbox"/> Sample	
Name	Top	Bottom
Anhydrite	608	(+1197)
Topeka	2621	(-816)
Heebner	2965	(-1160)
Brown Lime	3085	(-1280)
Lansing	3101	(-1296)
B.K.C.	3342	(-1537)
Arbuckle	3348	(-1543)
R.T.D.	3420	(-1615)

NOV 04 1985

State Geological Survey
INDIANA BRANCH

CASING RECORD <input checked="" type="checkbox"/> New <input type="checkbox"/> Used Report all strings set-conductor, surface, intermediate, production, etc.							
Purpose of String	Size Hole Drilled	Size Casing Set (In O.D.)	Weight Lbs/Ft.	Setting Depth	Type of Cement	#Sacks Used	Type and Percent Additives
Surface	12-1/4"	8-5/8"	24#	255'	Common	140	2% Gel, 3% CC
Production	7-7/8"	5-1/2"	15-50#	3432'	Common	125	10% Salt, 20 Bbl Salt. Pre-flush
PERFORATION RECORD				Acid, Fracture, Shot, Cement Squeeze Record (Amount and Kind of Material Used)			
Shots Per Foot	Specify Footage of Each Interval Perforated					Depth	
3	3370-74'	3365-68'	3357-60'	200 gallons	15% Regular		3357-3360'
				1500 gallons	15% MCA		3357-3360'
				Squeezed w/150 sx Common			3399-3650'
3	3378-81' and 3357-60'	3371-74'	3366-69'	300 gallons	15% FE		3357-3399'
TUBING RECORD				Liner Run <input type="checkbox"/> Yes <input type="checkbox"/> No			
Size	Set At	Packer at					

Attached to and Made a Part
of ACO-1 (API #15-009-24,043)
Woodman-Iannitti Oil Company
Apel #1
C E/2 E/2 NE
Sec. 26-19-12W
Barton County, Kansas

26-19-12W

WELL LOG CONT'D

DST #1--3342-3364', open 45-45-45-45, strong blow throughout.
Recovered 120' gas in pipe, 160' oil, 20' muddy gassy oil (55%
oil, 15% gas, 2% water, 28% mud). IFP 31-26; ISIP 322; FFP 72-
72; FSIP 187; T. 104°.

DST #2--3342-69, open 45-45-45-45, moderate blow throughout.
Recovered 60' gas in pipe, 120' oil, 60' muddy gassy oil (55%
oil, 22% gas, 3% water, 20% mud), 60' oil and gas cut mud (7%
oil, 3% gas, 2% water, 88% mud), chlorides 9000 PPM. T. 109°.

Date of First Production 10-24-85	Producing Method <input type="checkbox"/> Flowing <input checked="" type="checkbox"/> Pumping <input type="checkbox"/> Gas Lift <input type="checkbox"/> Other (explain).....				
Estimated Production Per 24 Hours	Oil	Gas	Water	Gas-Oil Ratio	Gravity
	10 Bbls	-0- MCF	-0- Bbls	CFPB	

METHOD OF COMPLETION

Production Interval

Disposition of gas: Vented
 Sold
 Used on Lease

Open Hole Perforation
 Other (Specify)

3357-78'

Dually Completed

NOV 2 1985