

Section 12 Township 19 Range 12-W

Well No. #4 Kultgen "A"

Company Aladdin & Crowe

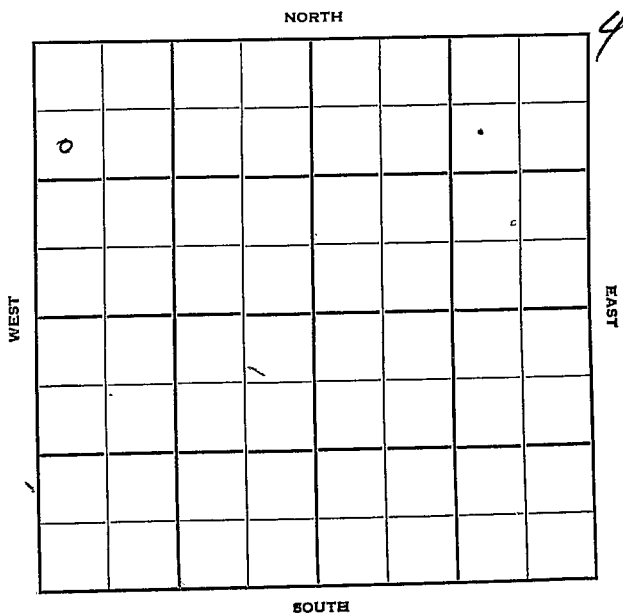

Sec. 12 Twp. 19 R.

Well No. #4 Kultgen "A" Farm

Aladdin & Crowe Company

Crowe Drlg. Contractor

Cheyenne View Pool

990' Ft. from N. Line

_____ Ft. from S. Line

_____ Ft. from E. Line

330' Ft. from W. Line

SW NW NW

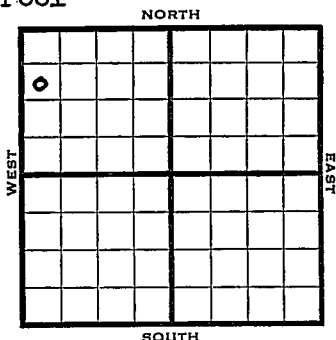

1950

Elev 1797 REPORT

8/16

8" @ 240'
Anhy 615-35'
Drlg. 1960'

10/4

Spud 8-10-50
8" @ 240
Anhy 615-35 Lans 3078
DST 3081-3152 opn 1/2 hr rec 150' o&gcm
DST 3202-54 opn 1 hr rec 120' msw
Cong 3335
DST 3337-50 opn 1/2 hr rec 10' mud
Arb 3390-91
5" @ 3391
TD 3414
18 gwph SP 3260
23/3233-41, 23/3215-23, 18/3209-15
24/3301-09, SSO 2000 A 22 bw 20 boph
SP 3147
18/3138-44 24/3120-28
24/3112-20, 24/3095-3103 24/3086-94
24/3078-86, 22/3070-78
Est 1/4 mcfg 3000 A
F/20 boph
Comp 118 bopd 3% water
Completed

COMPLETED

County Barton State Kansas

Sec. 12 (Blk. Twp.) 19 (Sur. Rge.) 12W Map No.

Operator Aladdin & Crowe

Well No. 4 Farm Kritzen "A"

Elev. Location SW NW NW

FIRST REPORT

990 Ft. From N Line NW

330 Ft. From W Line Quarter

Ist. Report AUG 16 1950

Completion _____

Remarks _____

Spudding Date 8-10-50

Drlg. Data Cheyenne View Pool

8" @ 240 Anhy 615-35 drlg. 1900

J. E. TYRA

