

KANSAS DRILLERS LOG

API No. 15 — 009 — 01389 (OWWO)
 County Number

S. 23 T. 19 R. 14 ^E/_W
 Loc. nwnenw
 County Barton

Operator G. N. Rupe

Address P.O. Box 2273 Wichita, Kans. 67201

Well No. 1 Lease Name Evers

Footage Location
330 feet from (N) line 1550 feet from (W) line

Principal Contractor Red Tiger Drlg. Co. Geologist W. G. Clement

Spud Date 1-25-76 Total Depth 2370 P.B.T.D.

Date Completed Oil Purchaser

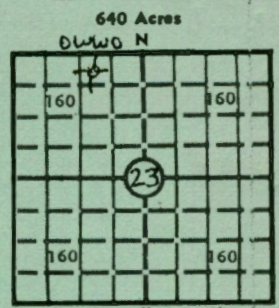

Locate well correctly
 Elev.: Gr. 1873
 DF _____ KB 1878

CASING RECORD

Report of all strings set — surface, intermediate, production, etc.

Purpose of string	Size hole drilled	Size casing set (in O.D.)	Weight lbs/ft.	Setting depth	Type cement	Sacks	Type and percent additives
<u>Surface</u>	<u>8</u>	<u>8 5/8</u>		<u>821</u>	<u>Already set.</u>		

LINER RECORD

PERFORATION RECORD

Top, ft.	Bottom, ft.	Sacks cement	Shots per ft.	Size & type	Depth interval

TUBING RECORD

Size	Setting depth	Packer set at

ACID, FRACTURE, SHOT, CEMENT SQUEEZE RECORD

Amount and kind of material used	Depth interval treated

INITIAL PRODUCTION

Date of first production		Producing method (flowing, pumping, gas lift, etc.)			
RATE OF PRODUCTION PER 24 HOURS		Oil	Gas	Water	Gas-oil ratio
		bbls.	MCF	bbls.	CFPB
Disposition of gas (vented, used on lease or sold)				Producing interval (s)	

mailed 7/14/76

INSTRUCTIONS: As provided in KCC Rule 82-2-125, within 90 days after completion of a well, one completed copy of this Drillers Log shall be transmitted to the State Geological Survey of Kansas, 4150 Monroe Street, Wichita, Kansas 67209. Copies of this form are available from the Conservation Division, State Corporation Commission, 3830 So. Meridian (P.O. Box 17027), Wichita, Kansas 66217. Phone AC 316-522-2206. If confidential custody is desired, please note Rule 82-2-125. Drillers Logs will be on open file in the Oil and Gas Division, State Geological Survey of Kansas, Lawrence, Kansas 66044.

Operator

G.N. Rupe

DESIGNATE TYPE OF COMP.: OIL, GAS, DRY HOLE, SWDW, ETC.:

Dry hole

Well No.

1

Lease Name

Evers (OWWO)

S23 T19 R14 W

WELL LOG

Show all important zones of porosity and contents thereof; cored intervals, and all drill-stem tests, including depth interval tested, cushion used, time tool open, flowing and shut-in pressures, and recoveries.

SHOW GEOLOGICAL MARKERS, LOGS RUN, OR OTHER DESCRIPTIVE INFORMATION.

FORMATION DESCRIPTION, CONTENTS, ETC.	TOP	BOTTOM	NAME	DEPTH
DST #1 2270-2370 (30-30-30-5)				
Rec. 65' water mud				
ISIP 777 # IFF 66-84 # FFP 98-98 #				
DST #2 (SD) 1762-1847 (30-45-60-60)				
Rec. 480' water				
ISIP 524 # IFF 98-178 # FFP 223-290 #				
Logs: GR-N-Gum - caliper, Density				

USE ADDITIONAL SHEETS, IF NECESSARY, TO COMPLETE WELL RECORD.

Date Received

N.G. Clement

Signature

Petr. Geol.

Title

Date

7-4-76