

**LAUGHLIN-SIMMONS & CO. OF KANSAS, INC.**  
 OILWELL ELEVATIONS AND LOCATIONS  
 2121 W. 18TH STREET (313) 3-5351  
 WICHITA, KANSAS 67203

June 8, 1972  
 DATE

Barton      29    19s    15w      SE NW NE  
 COUNTY      S      T      R      LOCATION

Rupe-Cassell et al      1      Gagleman  
 OPERATOR      NO.      FARM

ELEVATION: 1942 ft

Mr. Glen N. Rupe  
 925 Olive Garvey Building  
 Wichita, Kansas 67202

REC'D JUN 9 1972

SCALE: 2" = 1 Mile

*5' iron rod - short  
 wooden stake & pink-  
 white flagging in  
 level spot in pasture  
 (with livestock).*

*30' E of trail & N-S fence*

*15' N of 5' deep draw*

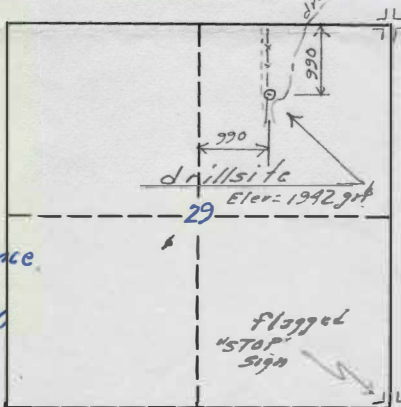

To Gros Bon

'Want this week' Mrs. Leach

MINIMUM STAKING CHARGE: \$50.00  
 EXTRA TIME & MILEAGE: \_\_\_\_\_  
 ELEVATION CHARGE: \_\_\_\_\_  
 TOTAL: \$50.00 ✓

*Thank you,  
 R. C. Boser*  
 L-S ENGINEER