

Wells Sample  
 PI  
 KANSAS

**WELL COMPLETION REPORT AND  
 DRILLER'S LOG**

State Geological Survey

WICHITA BRANCH

S. 16 T. 19 R. 21W E

Loc. NE NE NW

County Ness

API No. 15 — Ness County — 135-21847 Number

Operator  
John Jay Darrah, Jr.

Address  
405 Century Plaza Bldg., Wichita, Kans. 67202

Well No. 1 Lease Name Wilhems

Footage Location  
330 feet from (N) 8 line 2310 from W feet from (E) (W) line

Principal Contractor Merkle Drilling Geologist \_\_\_\_\_

Spud Date 7-14-80 Date Completed 7-21-80 Total Depth 4330 P.B.T.D. \_\_\_\_\_

Directional Deviation \_\_\_\_\_ Oil and/or Gas Purchaser \_\_\_\_\_

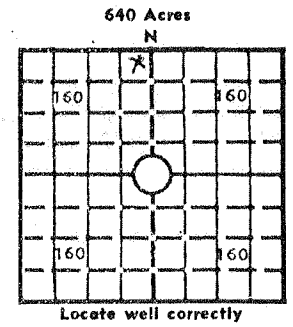

Elev.: Gr. \_\_\_\_\_  
 DF \_\_\_\_\_ KB 2230

**CASING RECORD**

Report of all strings set — surface, intermediate, production, etc.

Purpose of string	Size hole drilled	Size casing set (in O.D.)	Weight lbs/ft.	Setting depth	Type cement	Sacks	Type and percent additives
Surf		8-5/8"		327		200	2% gel, 3% cac1

**LINER RECORD**

**PERFORATION RECORD**

Top, ft.	Bottom, ft.	Sacks cement	Shots per ft.	Size & type	Depth interval

Size	Setting depth	Packer set at

**ACID, FRACTURE, SHOT, CEMENT SQUEEZE RECORD**

Amount and kind of material used	Depth interval treated

**INITIAL PRODUCTION**

Date of first production \_\_\_\_\_ Producing method (flowing, pumping, gas lift, etc.) \_\_\_\_\_

RATE OF PRODUCTION PER 24 HOURS	Oil	Gas	Water	Gas-oil ratio
	bbls.	bbls.	MCF	CFPB

Disposition of gas (vented, used on lease or sold) \_\_\_\_\_ Producing interval (s) \_\_\_\_\_

INSTRUCTIONS: As provided in KCC Rule 82-2-125, within 90 days after completion of a well, one completed copy of this Drillers Log shall be transmitted to the State Geological Survey of Kansas, 4150 Monroe Street, Wichita, Kansas 67209. Copies of this form are available from the Conservation Division, State Corporation Commission, 245 No. Water, Wichita, Kansas 67202. Phone AC 316-522-2206. If confidential custody is desired, please note Rule 82-2-125. Drillers Logs will be on open file in the Oil and Gas Division, State Geological Survey of Kansas, Lawrence, Kansas 66044.

Operator  
John Jay Darrah, Jr.

DESIGNATE TYPE OF COMP.: OIL, GAS,  
DRY HOLE, SWDW, ETC.:  
dry

Well No. 1      Lease Name  
Wilhems

S16 T 19 R 21W E  
W

**WELL LOG**

Show all important zones of porosity and contents thereof; cored intervals, and all drill-stem tests, including depth interval tested, cushion used, time tool open, flowing and shut-in pressures, and recoveries.

SHOW GEOLOGICAL MARKERS, LOGS RUN,  
OR OTHER DESCRIPTIVE INFORMATION.

FORMATION DESCRIPTION, CONTENTS, ETC.	TOP	BOTTOM	NAME	DEPTH
See attached.				

USE ADDITIONAL SHEETS, IF NECESSARY, TO COMPLETE WELL RECORD.

Date Received

*John Jay Darrah Jr*  
Signature

*Owner*  
Title

8-18-81  
Date

PI

16-19-21W

**JOHN JAY DARRAH, JR.**  
PHONE 316-263-2243  
SUITE 1010, CENTURY PLAZA BUILDING  
WICHITA, KANSAS 67202

PROGRESS REPORT

JOHN JAY DARRAH, JR.  
#1 WILHELM  
NE NE NW  
SEC. 16-19-21W  
NESS COUNTY, KANSAS

Contractor: Merckle Drilling

Elevation: 2222 Gr.  
2224 DF  
2230 KB

7-14-80 MIRT. Set surface pipe @ 327', 8-5/8", w common cement, 200sx,  
2% gel, 3% cc, set at 7:30 p.m. WOC.

7-15-80 Drilling @ 6:00 a.m. @ 327'.

7-16-80 Drilling @ 2315' @ 7:00 a.m. Anhydrite  
is 1430' to 1460' +900.

7-17-80 Drilling @ 3150' @ 7:00 a.m.

7-18-80 Drilling @ 3700' @ 7:00 a.m.

7-19-80 Drilling @ 4300'.

DST #1 4317 to 4225

30, 30, 30, 30

Weak blow throughout. Recovered 120' gas in pipe, 90' VSG & OCM.  
Flow pressures-not available.  
SIP 1130-1100

DST #2 4314-4325 Misrun, anchor plug.

7-20-80 Going baek to bottom.

DST #3 4314-4330

Fair blow throughout. Recovered 128' of heavy gas and oil-cut mud.  
(52% gas, 32% oil, 16% mud.) 186' of G & OCM (54% gas, 14% oil &  
32% mud), 186' of water (100% water), 71' net oil and 186' of  
net water, 38% oil, less than 1 barrel of oil.

FP 48-234  
SIP 1188-1169

7-21-80 Coming out of hole to plug and abandon.