

Section 28 Township 19 Range 10-W

Well No. #1 Manke

Company E Adair

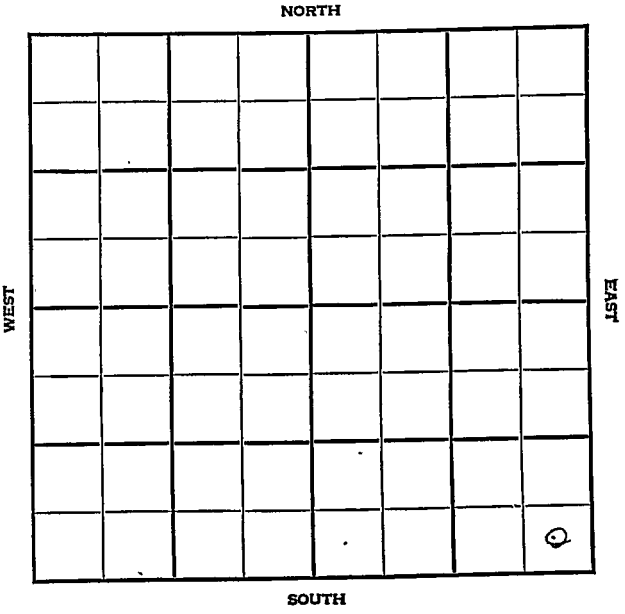

KANSAS

Rice

28

19

10W ✓

Sec. \_\_\_\_\_ Twp. \_\_\_\_\_ R. \_\_\_\_\_

Well No. #1 Manke Farm \_\_\_\_\_

E. Adair Company \_\_\_\_\_

Silica Pool

\_\_\_\_\_ Ft. from N. Line

330' Ft. from S. Line

330' Ft. from E. Line

\_\_\_\_\_ Ft. from W. Line

SE/C

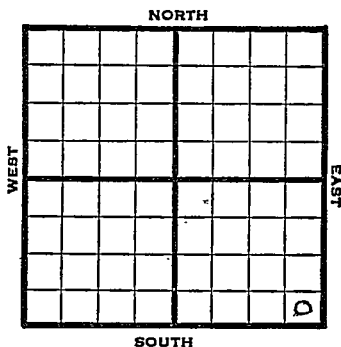

1948

Elev. 1762' REPORT

|       |  |
|-------|--|
| 7/21  | Location                               |
| 7/28  | "                                      |
| 8/4   | "                                      |
| 8/11  | "                                      |
| 8/18  | "                                      |
| 8/25  | "                                      |
| 9/1   | "                                      |
| 9/8   | 8" @ 162'<br>Drlg 1480'                |
| 9/14  | Lansing 2965'<br>Drlg 3143'            |
| 9/21  | Arb 3252-82'<br>TD 3282'<br>5" @ 3253' |
| 9/29  | "                                      |
| 10/6  | "                                      |
| 10/13 | "                                      |
| 10/19 | "                                      |
| 10/26 | "                                      |
| 11/3  | "                                      |
| 11/10 | "                                      |
| 11/16 | "                                      |
| 11/23 | "                                      |
| 11/30 | "                                      |

OVER

1948

12/6 24 shots 3248-56 - 2300' oil

12/15 "

12/22 "

12/29 "

1949

1/5 Arb. 3248'

5" @ 3253'

Pump 50 oil P<sub>o</sub>t.

Gr. 42°

TD 3288'

COMPLETED

Map No. \_\_\_\_\_ Sec. 28 Twp. 19 R. 10<sup>W</sup>

Well No. 1 Manke

E Adair Company

**FIRST REPORT** Contractor

SE/C

SECTION PLAT

\_\_\_\_\_ Ft. from N. Line

330 Ft. from S. Line

330 Ft. from E. Line

\_\_\_\_\_ Ft. from W. Line

|  |  |  |  |
|--|--|--|--|
|  |  |  |  |
|  |  |  |  |
|  |  |  |  |
|  |  |  |  |

Rice County

Location X

Rig up \_\_\_\_\_

Drilling and Remarks:

RECORD

Cased \_\_\_\_\_ in., \_\_\_\_\_ ft.

Sand \_\_\_\_\_

Gas \_\_\_\_\_

Oil \_\_\_\_\_

Total Depth \_\_\_\_\_

PRODUCTION

1st 24 hrs. Nat. \_\_\_\_\_

1st 24 hrs. after shot \_\_\_\_\_

Gas \_\_\_\_\_ Cu. Ft.

Dry Hole \_\_\_\_\_

Abandoned \_\_\_\_\_

Date

JUL 21 1948 19

S. J. LEWIS Scout

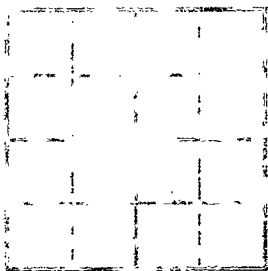

- Misc. Small Maps \_\_\_\_\_
- Cards \_\_\_\_\_
- Tracing \_\_\_\_\_
- France Map \_\_\_\_\_
- Scarborough Map \_\_\_\_\_
- Pierce Map \_\_\_\_\_
- Geological Dept. \_\_\_\_\_
- Pierce Flat Book \_\_\_\_\_

\_\_\_\_\_

\_\_\_\_\_

\_\_\_\_\_

Kansas

Map No. 46 Sec. 28 Twp. 19 R. 10WWell No. 1 MankeE. Adair Company

COMPLETE

Contractor

SE/C

E. 1762

SECTION PLAT

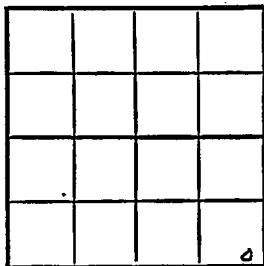
       Ft. from N. Line330 Ft. from S. Line330 Ft. from E. Line       Ft. from W. Line

Rice County

Location       Rig up       

Drilling and Remarks:

CR 82455" @ 8250Prop 50 in 10042<sup>0</sup> SW

## RECORD

Cased        in.,        ft.Sand       Gas       Oil Total Depth 3250

## PRODUCTION

1st 24 hrs. Nat.       1st 24 hrs. after shot       Gas        Cu. Ft.Dry Hole       Abandoned       

Date

JAN 5 1949 19

S. J. LEWIS Scout

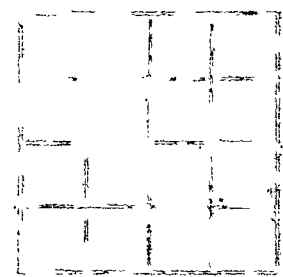

- Scout Cards .....
- Land Small Map .....
- Land Wall Map .....
- Tracings .....
- France Map .....
- Pierce Map .....
- Misc. ....