

Section 28 Township 19 Range 12W

Well No. #9 Johnson A-B

Company G M R Oil

13

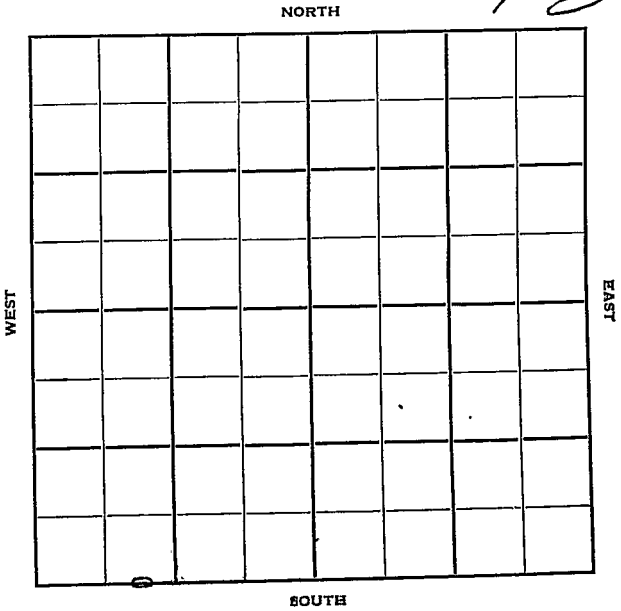

BARTON

KANSAS ✓

Sec. 28 Twp. 19 R. 12W

Well No. #9 Johnson A-B Farm

G-M-R Oil Company

Contractor

Ft. from N. Line

75

Ft. from S. Line

Ft. from E. Line

990

Ft. from W. Line

SW $\frac{1}{4}$ SE SW SW

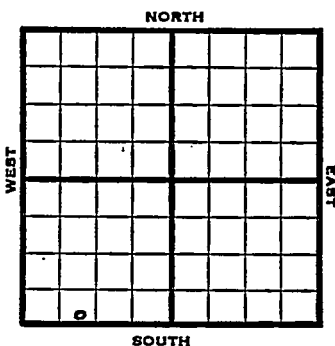

1952 Elev. 1817' REPORT

11/3 8" @ 182'
Anhy 607'
Drlg. 1066'

11/5 Drlg. 1066'

11/12 Heeb 2977' Br li 3094' Lans. 3110'
DST 3252-72, 3/4 hr, 900' gassy oil
825#
DST 3279-3315, 3/4 hr, 1620' oil
600#
Drlg. 3355'

11/20 Arb. 3353' RTD 3357' 5" @ 3355'

11/27 NR

12/4 "

12/15 5/3266-91 1 1/2 BOPH 4000A F 15 BOPH
6 Hrs.

12/18 POP

12/23 Spud 11-3-52
Oil well TD 3357' 8" @ 182
Anhy 607' Heeb. 2977' Br. lime 3094
Lans. 3110'
DST 3252-72, open 3/4 hr. rec 900' gassy
oil 825#
DST 3279-3315, open 3/4 hr, rec 1620'
oil 600# Arb. 3353' TD 3357
5" @ 3355 5/3266-91 S/1 1/2 BOPH
4000 A F/15 BOPH Comp. BHB 2186
BOPD **COMPLETED**

