

State Geological Survey  
WICHITA, BRANCH

**KANSAS DRILLERS LOG**

S. 17 T. 19 R. 31 <sup>K</sup>/<sub>W</sub>

API No. 15 — 171 — 20,122  
County Number

Loc. C NE

Operator  
CAR-REN, Inc.

County Scott

Address Suite 645, 300 West Douglas Wichita, Kansas 67202

Well No. #1-17 Lease Name Watkins

Footage Location  
feet from (N) (S) line feet from (E) (W) line

Principal Contractor Gabbert-Jones, Inc. Geologist W. Walter Scott

Spud Date December 12, 1976 Total Depth 2935' P.B.T.D.

Date Completed Oil Purchaser

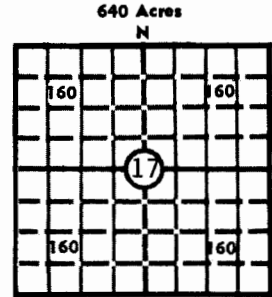

Elev.: Gr. 2978'

DF 2971' KB 2973'

APR 07 1977

**CASING RECORD**

Report of all strings set — surface, intermediate, production, etc.

Purpose of string	Size hole drilled	Size casing set (in O.D.)	Weight lbs/ft.	Setting depth	Type cement	Sacks	Type and percent additives
Surface	12 1/4"	8 5/8"	28#	364'	Class H	265	3% CaCl.

**LINER RECORD**

**PERFORATION RECORD**

Top, ft.	Bottom, ft.	Sacks cement	Shots per ft.	Size & type	Depth interval

**TUBING RECORD**

Size	Setting depth	Packer set at

**ACID, FRACTURE, SHOT, CEMENT SQUEEZE RECORD**

Amount and kind of material used	Depth interval treated

**INITIAL PRODUCTION**

Date of first production		Producing method (flowing, pumping, gas lift, etc.)			
RATE OF PRODUCTION PER 24 HOURS	Oil	Gas	Water	Gas-oil ratio	CFPB
	bbis.	MCF	bbis.		
Disposition of gas (vented, used on lease or sold)			Producing interval (s)		

INSTRUCTIONS: As provided in KCC Rule 82-2-125, within 90 days after completion of a well, one completed copy of this Drillers Log shall be transmitted to the State Geological Survey of Kansas, 4150 Monroe Street, Wichita, Kansas 67209. Copies of this form are available from the Conservation Division, State Corporation Commission, 3830 So. Meridian (P.O. Box 17027), Wichita, Kansas 66217. Phone AC 316-522-2206. If confidential custody is desired, please note Rule 82-2-125. Drillers Logs will be on open file in the Oil and Gas Division, State Geological Survey of Kansas, Lawrence, Kansas 66044.

Operator  
CAR-REN, Inc.

DESIGNATE TYPE OF COMP.: OIL, GAS,  
DRY HOLE, SWDW, ETC.:  
D & A

Well No.  
1-17

Lease Name  
Watkins

S17 T19S R31W<sup>E</sup><sub>W</sub>

### WELL LOG

Show all important zones of porosity and contents thereof; cored intervals, and all drill-stem tests, including depth interval tested, cushion used, time tool open, flowing and shut-in pressures, and recoveries.

SHOW GEOLOGICAL MARKERS, LOGS RUN,  
OR OTHER DESCRIPTIVE INFORMATION.

FORMATION DESCRIPTION, CONTENTS, ETC.	TOP	BOTTOM	NAME	DEPTH
			Stone Corral	+753
			B. Stone Corral	+690
			Herington	+233
			Krider	+207
			Winfield	+157
			Towanda	+ 98
			R.T.D.	+ 38
			L.T.D.	+ 47

USE ADDITIONAL SHEETS, IF NECESSARY, TO COMPLETE WELL RECORD.

Date Received

  
Signature

Vice President

Title

December 29, 1976

Date