

RELEASED

S SIDE ONE

5/18/87

KCC Ind

STATE CORPORATION COMMISSION OF KANSAS
Date: JUN 1 1987
OIL & GAS CONSERVATION DIVISION
FROM CONFIDENTIAL
WELL COMPLETION OR RECOMPLETION FORM
ACO-1 WELL HISTORY

DESCRIPTION OF WELL AND LEASE

Operator: License # 5267
Name K & E Petroleum, Inc
Address 100 S. Main Suite 300 Hardage Ctr
Wichita, Kansas
City/State/Zip 67202

Purchaser.....

Operator Contact Person Wayne L. Brinegar
Phone 316-264-4301

Contractor: License # 5422
Name Abercrombie Drilling, Inc

Wellsite Geologist Curtis Covey
Phone 316-942-2685

Designate Type of Completion

- New Well Re-Entry Workover
- Oil SWD Temp Abd
- Gas Inj Delayed Comp.
- Dry Other (Core, Water Supply etc.)

If ONWO: old well info as follows:

Operator
Well Name
Comp. Date Old Total Depth.....

WELL HISTORY

Drilling Method:

- Mud Rotary Air Rotary Cable

1/28/86 2/8/86 2-8-86
Spud Date Date Reached TD Completion Date
4830'
Total Depth PBTD

Amount of Surface Pipe Set and Cemented at 372.67 feet
Multiple Stage Cementing Collar Used? Yes No
If yes, show depth set.....feet
If alternate 2 completion, cement circulated from.....feet depth to.....w/.....SX cmt

API NO. 15-171-20.321
County Scott
S/2 SE SE Sec. 9 Twp. 19S Rge. 33 East West

310 Ft North from Southeast Corner of Section
610 Ft West from Southeast Corner of Section
(Note: Locate well in section plat below)

Lease Name Hutchins "A" Well # 1

Field Name Wildcat

Producing Formation.....

Elevation: Ground 2954' KB 2959'

Section Plat

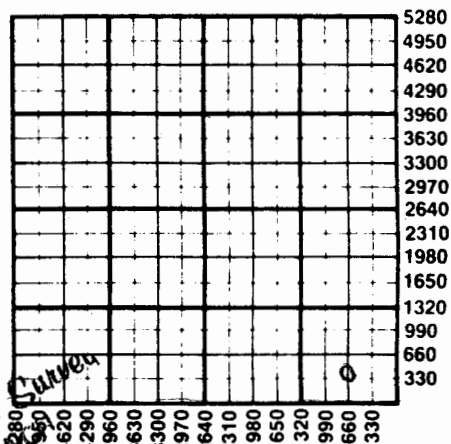

MAR 03 1986
State Geologist
WICHITA BRANCH
Curtis

WATER SUPPLY INFORMATION

Disposition of Produced Water: Disposal Repressuring
Docket #

Questions on this portion of the ACO-1 call:

Water Resources Board (913) 296-3717

Source of Water:

Division of Water Resources Permit #.....

Groundwater 5270 Ft North from Southeast Corner
(Well) 208 Ft West from Southeast Corner of
Sec 5 Twp 20S Rge 33 East West

Surface Water.....Ft North from Southeast Corner
(Stream, pond etc).....Ft West from Southeast Corner
Sec Twp Rge East West

Other (explain).....
(purchased from city, R.W.D. #)

INSTRUCTIONS: This form shall be completed in duplicate and filed with the Kansas Corporation Commission, 200 Colorado Derby Building, Wichita, Kansas 67202, within 90 days after completion or recompletion of any well. Rule 82-3-130 and 82-3-107 apply.

Information on side two of this form will be held confidential for a period of 12 months if requested in writing and submitted with the form. See rule 82-3-107 for confidentiality in excess of 12 months.

m

124584

SIDE TWO

Operator Name ...K. & F. Petroleum, Inc. Lease Name.....Hutchins "A" Well #.....1

Sec...9 Twp...19S Rge...33 East West County.....Scott

WELL LOG

INSTRUCTIONS: Show important tops and base of formations penetrated. Detail all cores. Report all drill stem tests giving interval tested, time tool open and closed, flowing and shut-in pressures, whether shut-in pressure reached static level, hydrostatic pressures, bottom hole temperature, fluid recovery, and flow rates if gas to surface during test. Attach extra sheet if more space is needed. Attach copy of log.

Drill Stem Tests Taken Yes No
 Samples Sent to Geological Survey Yes No
 Cores Taken Yes No

Formation Description
 Log Sample

DST #1 (3761' - 3786') (Straddle) (Topeka)
 45/60/75/90
 Rec. 130' MW. FP's: 40# - 50# - 60# - 81#.
 SIP's: 936#/906#. HSP's: 1839#/1819#. BHT 112°

DST #2 (4595' - 4625') (Morrow Sand)
 45/60/75/90
 Rec. 10' mud. FP's: 40# - 40#/40# - 40#. SIP's:
 50#/50#. HSP's: 2316#/2296#. BHT 128°. Cl
 6,000 ppm.

DST #3 (4597' - 4632') (Morrow Sand)
 30/30/30/30
 Rec. 65' mud, FP's: 71# - 71#/71# - 71#. SIP's:
 101#/81#. HSP's: 2336#/2326#. BHT (not
 recorded) Cl. 6,000 ppm.

Name	Top	Bottom
B/Anhydrite	2224'	+735'
Krider	2662'	+297'
Ft. Riley	2810'	+149'
Topeka	3582'	-623'
Heebner	3839'	-880'
Toronto	3854'	-895'
Lansing	3886'	-927'
B/KC	4300'	-1341'
Marmaton	4330	-1371'
Cherokee	4442'	-1483'
Morrow Sh.	4594'	-1635'
Morrow Sd.	4616'	-1652'
Miss.	4642'	-1683'
Total Depth	4828'	-1865'

CASING RECORD <input checked="" type="checkbox"/> New <input type="checkbox"/> Used							
Report all strings set-conductor, surface, intermediate, production, etc.							
Purpose of String	Size Hole Drilled	Size Casing Set (in O.D.)	Weight Lbs/Ft.	Setting Depth	Type of Cement	#Sacks Used	Type and Percent Additives
Surface	12 1/4"	8 5/8"	23#	372.67'	Common	240	2% gel 3% c.c.
PERFORATION RECORD				Acid, Fracture, Shot, Cement Squeeze Record			
Shots Per Foot	Specify Footage of Each Interval Perforated			(Amount and Kind of Material Used)		Depth	
TUBING RECORD				Liner Run	<input type="checkbox"/> Yes <input type="checkbox"/> No		
	Size	Set At	Packer at				