

007 10 1978

KANSAS DRILLERS LOG

S. 15 T. 19S R. 33W ^E_W
 Loc. C SW
 County Scott

API No. 15 — 171 — 20166
 County Number

Operator
Maurice L. Brown Co.

Address
200 Sutton Place Wichita, Ks. 67202

Well No. # 1 Lease Name Collingwood "B"

Footage Location
1320' feet from XX (S) line 1320' feet from XXX (W) line

Principal Contractor Gabbert-Jones, Inc. Geologist Raymond E. Palmer

Spud Date 10-18-78 Total Depth 2840' P.B.T.D. 2784'

Date Completed 10-24-78 Oil-Purchaser GAS

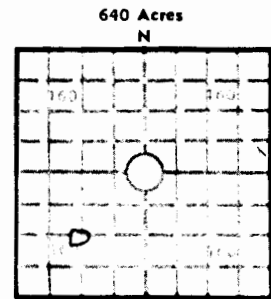

Locate well correctly
 Elev.: Gr. 2961'
 DF 2963' KB 2966'

CASING RECORD

Report of all strings set — surface, intermediate, production, etc.

| Purpose of string | Size hole drilled | Size casing set (in O.D.) | Weight lbs/ft. | Setting depth | Type cement | Sacks | Type and percent additives |
|-------------------|-------------------|---------------------------|----------------|---------------|-------------------|-------|----------------------------|
| Surface | 12 1/4" | 8-5/8" | 24# | 328' | Halcolite Class H | 150 | 1/4# Flocele, 3%cc |
| Production | 7-7/8" | 4 1/2" | 9 1/2# | 2820' | HLC Pozmix 65/35 | 175 | 1/4# Flocele, 3%cc |
| | | | | | | 150 | 10# Gilsonite /sx |
| | | | | | | | 10% Salt, 3/4% |
| | | | | | | | CFR-2 & 10# |
| | | | | | | | Gilsonite /sx |

LINER RECORD

PERFORATION RECORD

| Top, ft. | Bottom, ft. | Sacks cement | Shots per ft. | Size & type | Depth interval |
|----------|-------------|--------------|---------------|-------------|----------------|
| | | | 4 | 4" JJ | 2646-54' |

TUBING RECORD

| Size | Setting depth | Packer set at |
|--------|---------------|---------------|
| 2-3/8" | 2702 | none |

ACID, FRACTURE, SHOT, CEMENT SQUEEZE RECORD

| Amount and kind of material used | Depth interval treated |
|--|------------------------|
| 1250 gals. of 15% Demud Acid, 10,000 gals. 1/2% acid frac w/10,000# 20/40 sand and 5,000# 10/20 sand | 2646-54' |

JAN 17 1983

INITIAL PRODUCTION

| Date of first production | Producing method (flowing, pumping, gas lift, etc.) | | | |
|--|---|-------|---|---------------|
| | | | | |
| RATE OF PRODUCTION PER 24 HOURS | Oil | Gas | Water | Gas-oil ratio |
| | bbls. | bbls. | MCF | CFPB |
| Disposition of gas (vented, used on lease or sold) | | | Producing interval (s) <u>2646-54'</u> <u>Krider</u> | |

INSTRUCTIONS: As provided in KCC Rule 82-2-125, within 90 days after completion of a well, one completed copy of this Drillers Log shall be transmitted to the State Geological Survey of Kansas, 4150 Monroe Street, Wichita, Kansas 67209. Copies of this form are available from the Conservation Division, State Corporation Commission, 3830 So. Meridian (P.O. Box 17027), Wichita, Kansas 66217. Phone AC 316-522-2206. If confidential custody is desired, please note Rule 82-2-125. Drillers Logs will be on open file in the Oil and Gas Division, State Geological Survey of Kansas, Lawrence, Kansas 66044.

Operator: The Maurice L. Brown Company
 DESIGNATE TYPE OF COMP.: OIL, GAS, DRY HOLE, SWDW, ETC.: GAS WELL

Well No. #1 Lease Name Collingwood "B"

S 15 T 19 R 33 XEX
 W

WELL LOG
 Show all important zones of porosity and contents thereof; cored intervals, and all drill-stem tests, including depth interval tested, cushion used, time tool open, flowing and shut-in pressures, and recoveries.
 SHOW GEOLOGICAL MARKERS, LOGS RUN, OR OTHER DESCRIPTIVE INFORMATION.

| FORMATION DESCRIPTION, CONTENTS, ETC. | TOP | BOTTOM | NAME | DEPTH |
|--|-----|--------|--|-------|
| <p>DST #1: 2618-70' (Krider) (55-45-55-90) 1st open, had strong blow in 3", GTS 10", in 45" had stabilized at 110 MCF. 2nd open, GTS immediate, stabilized at end of 45" at 140 MCF. Rec. 310' gsy wtry mud. IFP 97-113, ISIP 518, FFP 97-97, FSIP 518, IHP 1386, FHP 1257, Temp. 94° F.</p> <p>DST #2: 2695-2780' (covered Winfield & Towanda) (60-45-60-90) 1st open, very weak blow, died in 5". 2nd open, no blow. Rec. 40' mud, no shows. IFP 79-93, ISIP 555, FFP 93-106, FSIP 581, IHP 1449, FHP 1449, Temp. 90°.</p> | | | <p>ELECTRIC LOG TOPS:</p> <p>B/Stone Corral 2208' (+ 758)</p> <p>Herington 2616' (+ 350)</p> <p>Krider 2645' (+ 321)</p> <p>Winfield 2692' (+ 274)</p> <p>Towanda 2754' (+ 212)</p> <p>Ft. Riley 2798' (+ 168)</p> <p>TD 2840' (+ 126)</p> | |

RECEIVED
 STATE OCCUPATION COMMISSION
 JAN 17 1980
 CONSERVATION DIVISION
 Wichita, Kansas

USE ADDITIONAL SHEETS, IF NECESSARY, TO COMPLETE WELL RECORD.

Date Received _____
 Vern H. Haselhorst Signature
 Drilling Manager Title
 1-5-80 Date

State Geological Survey
WICHITA, BRANCH

15-171-20166
NOV 1 1978

15-19.33W

GABBERT-JONES, INC.
WICHITA, KANSAS
DRILLERS' WELL LOG

Collingwood B-1
C-SW Sec 15-19S-33W
Scott County Kansas

Commenced: 10-18-78

Completed: 10-24-78

OPERATOR: M. L. BROWN

| Depth | | Formation | Remarks |
|-------|-----------|-------------------|---------------------------------|
| From | to | | |
| 0 | 340 | Sand-Blue Shale | Ran 8 jts of 8 5/8" csg |
| 340 | 1414 | Shale | set @ 328' Cemented w/ |
| 1414 | 1898 | Shale-Sand | 150 sks Howcolite 2% CC |
| 1898 | 2040 | Shale w/Lime Stks | 1/4# Flocele + 150 sks Class H |
| 2040 | 2500 | Shale-Lime | 3% CC 1/4# Flocele |
| 2500 | 2520 | Shale-Lime-Sand | PD @ 3:00 P.M. 10-18-78 |
| 2520 | 2840 | Shale-Lime | |
| | 2840 - TD | | Ran 71 jts of 9 1/2# 4 1/2" csg |
| | | | set @ 2820' Cemented w/ |
| | | | 175 sks Howcolite + 150 sks |
| | | | 35/65 Posmix PD @ 1:00 p.m. |
| | | | 10-24-78 |

STATE OF KANSAS)
) SS
COUNTY OF SEDGWICK)

I, the undersigned, being duly sworn on oath, state that the above Drillers' Well Log is true and correct to the best of my knowledge and belief and according to the records of this office.

GABBERT-JONES, INC.

JAMES S. SUTTON II

Subscribed and sworn to before me this 31st day of October, 1978.

ELIZABETH J. EDWARDS-NOTARY PUBLIC

My Commission expires February 6, 1979.