

STATE CORPORATION COMMISSION OF KANSAS
OIL & GAS CONSERVATION DIVISION
WELL COMPLETION OR RECOMPLETION FORM
ACO-1 WELL HISTORY
DESCRIPTION OF WELL AND LEASE

Operator: License # 5886
Name Chief Drilling Co., Inc.
Address 224 E. Douglas, #350
City/State/Zip Wichita, KS 67202

Purchaser N/A

Operator Contact Person Douglas W. Thimesch
Phone 316 262-3791

Contractor: License # 5883
Name Warrior Drilling Co.

Wellsite Geologist Ron Dulos
Phone 316 267-7270

Designate Type of Completion
 New Well Re-Entry Workover
 Oil SWD Temp Abd
 Gas Inj Delayed Comp.
 Dry Other (Core, water supply etc.)

If ONWO: old well info as follows:
Operator
Well Name
Comp. Date Old Total Depth

WELL HISTORY

Drilling Method:
 Mud Rotary Air Rotary Cable
3-17-89 3-27-89 4-14-89
Spud Date Date Reached TD Completion Date
4750 4390
Total Depth PBDT

Amount of Surface Pipe Set and Cemented at 388 feet
Multiple Stage Cementing Collar Used? Yes No
If yes, show depth set 2134 feet
If alternate 2 completion, cement circulated from feet depth to w/SX cmt
Cement Company Name
Invoice #

API NO. 15-171-20,380
County Scott
C. NW NW 35 19S 33W East
4620 Ft North from Southeast Corner of Section
4620 Ft West from Southeast Corner of Section
(Note: Locate well in section plat below)

Lease Name Smith Well # 1

Field Name N/A

Producing Formation Marmaton

Elevation: Ground 2959 KB 2966

Section Plat

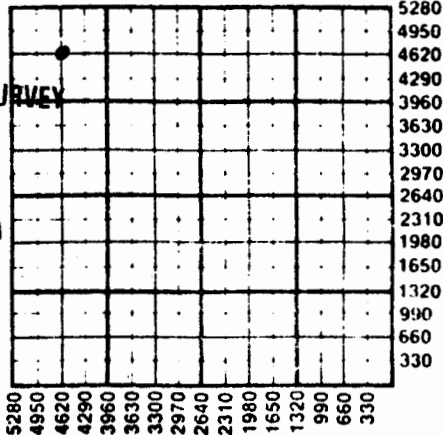

KANSAS GEOLOGICAL SURVEY
WICHITA BRANCH

RECEIVED 5 1989
STATE CORPORATION COMMISSION

APR 27 1989

CONSERVATION DIVISION
Wichita, Kansas

WATER SUPPLY INFORMATION

Disposition of Produced Water: Disposal
Docket # Repressuring

Questions on this portion of the ACO-1 call:

Water Resources Board (913) 296-3717
Source of Water:
Division of Water Resources Permit # 15-00413

Groundwater Ft North from Southeast Corner
(Well) Ft West from Southeast Corner of
SW/4 Sec 24 Twp 19S Rge 29W East West

Surface Water Ft North from Southeast Corner
(Stream, pond etc) Ft West from Southeast Corner
Sec Twp Rge East West

Other (explain)
(purchased from city, R.W.D. #)

INSTRUCTIONS: This form shall be completed in triplicate and filed with the Kansas Corporation Commission, 200 Colorado Derby Building, Wichita, Kansas 67202, within 120 days of the spud date of any well. Rule 82-3-130, 82-3-107 and 82-3-106 apply.

Information on side two of this form will be held confidential for a period of 12 months if requested in writing and submitted with the form. See rule 82-3-107 for confidentiality in excess of 12 months. One copy of all wireline logs and drillers time log shall be attached with this form. Submit CP-4 form with all plugged wells. Submit CP-111 form with all temporarily abandoned wells.

All requirements of the statutes, rules and regulations promulgated to regulate the oil and gas industry have been fully complied with and the statements herein are complete and correct to the best of my knowledge.

Signature Douglas W. Thimesch
Title Vice President/Exploration Date 4-16-89

Subscribed and sworn to before me this 16 day of April 1989
Notary Public Betty M. Abbott

Date Commission Expires January 22, 1991

K.C.C. OFFICE USE ONLY

F Letter of Confidentiality Attached
C Wireline Log Received
C Drillers Timelog Received

Distribution

KCC SWD/Rep NGPA
 KGS Plug Other
(Specify)



Sec 35 Twp 19 Rge 33 W

Operator Name **CHIEF DRILLING CO., INC.** Lease Name **SMITH** Well # **1**

Sec. **35** Twp. **19S** Rge. **33W** East West County **Scott**

WELL LOG

INSTRUCTIONS: Show important tops and base of formations penetrated. Detail all cores. Report all drill stem tests giving interval tested, time tool open and closed, flowing and shut-in pressures, whether shut-in pressure reached static level, hydrostatic pressures, bottom hole temperature, fluid recovery, and flow rates if gas to surface during test. Attach extra sheet if more space is needed. Attach copy of log.

Drill Stem Tests Taken Yes No
 Samples Sent to Geological Survey Yes No
 Cores Taken Yes No

Formation Description
 Log Sample

DST #1 3933-3981
 (Lansing 50-70z) wk bl died in 7 min.
 30-30-30-30 Rec. 30' sl OCM IBHP:
 939#, FBHP: 876#, IFP: 89-89 FFP:

DST 2
 4069-4117 (Lans 160 z) very wk blow
 died in 30", 30-30-30-30 Rec. 30' O
 spk M IBHP: 759#, FBHP 759# IFP 62-62
 FFP 62-62

DST #3 4225-4420
 (Pleasanton-Maraton-Pawnee) very st
 bl immediately 30-30-30-30 Rec. 1000'
 MO (Upper sample - 93% O, 7% M, Trace
 W) IBHP: 1074#, FBHP: 1028#, IFP: 98-
 294 FFP: 357-446 HP: 2123-2077

DST #4 4326-4420 (Marm-C, Pawnee) wk bl
 died 30", 30-30-30-30 Rec. 25' O C M
 IBHP 625#, FBHP 580#, IFP 89-89, FFP
 89-89 HP: 2345-2261 DST #5 4409-4508
 (Ft. Scott-Cherokee) wk bl died 30",
 30-30-30-30 Rec. 5' M, IBHP 715#, FBHP
 446#, IFP 89-89, FFP 89-89, HP 2308-
 2215.

DST #6 4514-4590 (Atoka
 & Morrow) very wk bl died 5", 30-30-30-
 30, Rec. 30' O spk M, IBHP 715#, FBHP
 223#, IFP 44-44, FFP 44-44, HP 2261-2215

Name	Top	Bottom
FORMATION TOPS: E-LOG TOPS:		
Anhydrite	2171 + 795	2174 + 792
Base Anhy	2186 + 780	2190 + 776
Heebner	3816 - 850	3818 - 852
Lansing	3860 - 894	3862 - 896
Stark	4145 -1179	4148 -1182
Hushpuckney	4199 -1233	4200 -1234
BKC	4234 -1268	4233 -1267
B/Pleasanton	4274 -1308	4279 -1313
Marm-A	4298 -1332	4300 -1334
Pawnee	4379 -1413	4384 -1418
Pt. Scott	4419 -1453	4422 -1456
Cherokee	4443 -1477	4446 -1480
Morrow	4560 -1594	4568 -1602
Morrow Sand	4577 -1611	4584 -1618
Miss St. Gen	4624 -1658	4633 -1667
RTD	4750 -1784	4656 -1790

CASING RECORD New Used

Report all strings set-conductor, surface, intermediate, production, etc.

Purpose of String	Size Hole Drilled	Size Casing Set (in O.D.)	Weight Lbs/Ft.	Setting Depth	Type of Cement	#Sacks Used	Type and Percent Additives
Surface		8 5/8"	20#	388	60/40 pozmix	170	3%cc, 2%gel
Production		4 1/2"	10 1/2#	4387	ASC	150	10 bbl IFR
							mud flush & 20 bbl salt flush

PERFORATION RECORD		Acid, Fracture, Shot, Cement Squeeze Record (Amount and Kind of Material Used)	
Shots Per Foot	Specify Footage of Each Interval Perforated		Depth
3/ft 4239	4341', 4245-4248'	500 gal 15%INS w/Servisol	
3/ft 4314	4318', 4324-4329'	250 gal 15%INS	

TUBING RECORD	Size	Set At	Packer at	Liner Run	<input type="checkbox"/> Yes <input checked="" type="checkbox"/> No

Date of First Production	Producing Method
N/A	<input type="checkbox"/> Flowing <input type="checkbox"/> Pumping <input type="checkbox"/> Gas Lift <input type="checkbox"/> Other (explain).....

Estimated Production Per 24 Hours	Oil Bbl's	Gas MCF	Water Bbl's	Gas-Oil Ratio	Gravity
	N/A				13.5

METHOD OF COMPLETION Production Interval

Disposition of gas: Vented Open Hole Perforation
 Sold Other (Specify) 4239-41
 Used on Lease Dually Completed 4245-48
 Commingled