

IMPORTANT
Kans. Geo. Survey request
samples on this well.

S. 11 T. 19 R. 5 ^K _W
Loc. C SW SW
County McPherson

API No. 15 — 113 County — 20,283 Number

Operator
G. N. Rupe

Address
200 West Douglas, Suite 925 Wichita, Kansas 67202

Well No. #1 Lease Name Smyres

Footage Location
feet from (N) (S) line _____ feet from (E) (W) line _____

Principal Contractor Red Tiger No. 3 Geologist E. Mack Stewart

Spud Date 7-2-1975 Total Depth RTD: 1910' P.B.T.D. LTD: 1906'

Date Completed 7-9-1975 Oil Purchaser _____

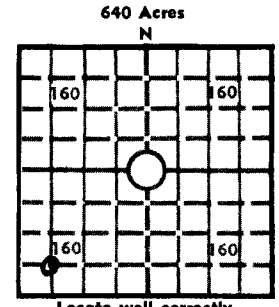

Elev.: Gr. 1577
DF 1579 KB 1582

CASING RECORD

Report of all strings set — surface, intermediate, production, etc. 212' surface casing, 8 5/8" with 140 sacks cement

Purpose of string	Size hole drilled	Size casing set (in O.D.)	Weight lbs/ft.	Setting depth	Type cement	Sacks	Type and percent additives

LINER RECORD

PERFORATION RECORD

Top, ft.	Bottom, ft.	Sacks cement	Shots per ft.	Size & type	Depth interval

TUBING RECORD

Size	Setting depth	Packer set at

ACID, FRACTURE, SHOT, CEMENT SQUEEZE RECORD

Amount and kind of material used	Depth interval treated

INITIAL PRODUCTION

Date of first production _____ Producing method (flowing, pumping, gas lift, etc.) _____

RATE OF PRODUCTION PER 24 HOURS	Oil	Gas	Water	Gas-oil ratio

Disposition of gas (vented, used on lease or sold) _____ Producing interval (s) _____

INSTRUCTIONS: As provided in KCC Rule 82-2-125, within 90 days after completion of a well, one completed copy of this Drillers Log shall be transmitted to the State Geological Survey of Kansas, 4150 Monroe Street, Wichita, Kansas 67209. Copies of this form are available from the Conservation Division, State Corporation Commission, 3830 So. Meridian (P.O. Box 17027), Wichita, Kansas 66217. Phone AC 316-522-2206. If confidential custody is desired, please note Rule 82-2-125. Drillers Logs will be on open file in the Oil and Gas Division, State Geological Survey of Kansas, Lawrence, Kansas 66044.

Operator **G. N. Rupe** DESIGNATE TYPE OF COMP.: OIL, GAS, DRY HOLE, SWDW, ETC.:

Well No. **1** Lease Name **Smyres**

S T R E W

WELL LOG
Show all important zones of porosity and contents thereof; cored intervals, and all drill-stem tests, including depth interval tested, cushion used, time tool open, flowing and shut-in pressures, and recoveries. SHOW GEOLOGICAL MARKERS, LOGS RUN, OR OTHER DESCRIPTIVE INFORMATION.

FORMATION DESCRIPTION, CONTENTS, ETC.	TOP	BOTTOM	NAME	DEPTH
	859		Hollenberg	+723
	903		Herington-Krider	+679
	956		Winfield	+ 626
	1033		Towanda	+ 549

USE ADDITIONAL SHEETS, IF NECESSARY, TO COMPLETE WELL RECORD.

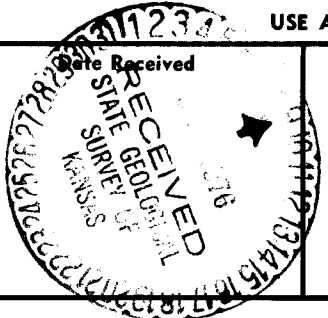

Charles R. King
Signature
Gen. Geol.
Title
8-7-75
Date

DRILLERS LOG

No. 1 Smyres

11-19-5W

CASING RECORD:

COMPANY: Car-Ren, Inc.

DESCRIPTION:

3-5/8" @ 208'
1/140 sx. cmt.

CONTRACTOR: Red Tiger Drilling Company

C SW SW
11-19S-5W
McPherson County,
Kansas

COMMENCED: July 2, 1975

COMPLETED: July 10, 1975

TOTAL DEPTH: 1910'

ELEVATION: 1582' KB

FORMATION

FROM

TO

REMARKS

Surface Hole	0	485	
Shale & Lime	485	910	
Dolomite	910	1057	
Grey Shale	1057	1175	
Lime, Shale & Chert	1175	1350	
Lime & Shale	1350	1490	
Lime	1490	1605	
Lime, Shale & Sand	1605	1910	

I certify that this is a true and correct copy of the above log to the best of my knowledge.

RED TIGER DRILLING COMPANY

Linda H. Dickens
Linda H. Dickens



Subscribed and sworn to before me this 15th day of July, 1975.

D. Ann Drennon
Notary Public

My Commission Expires:

December 28, 1977