

# State Geological Survey

16-1-18W ✓

**KANSAS DRILLERS LOG**

WICHITA, BRANCH

S. 16 T. 1 R. 18 NW

API No. 15 — 147 — 20186  
County Number

Loc. C NE NW

County Phillips

Operator  
**LADD PETROLEUM CORPORATION**

Address  
 P. O. Box 2848, Tulsa, Oklahoma 74101

Well No. 2 Lease Name Flory

Footage Location  
660 feet from (N) (●) line 1980 feet from (●) (W) line

Principal Contractor Red Tiger Geologist Whisler

Spud Date 4-8-75 Total Depth 3582 P.B.T.D. 3554

Date Completed 5-16-75 Oil Purchaser \_\_\_\_\_

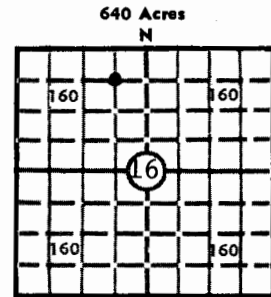

Elev.: Gr. 2141  
 DF \_\_\_\_\_ KB 2146

### CASING RECORD

Report of all strings set — surface, intermediate, production, etc.

Purpose of string	Size hole drilled	Size casing set (in O.D.)	Weight lbs/ft.	Setting depth	Type cement	Sacks	Type and percent additives
Surface	12 1/4	8 5/8	20	257	Common	175	3% Ca
Production	7 7/8	5 1/2	14	3580	Common	250	18% Salt

#### LINER RECORD

#### PERFORATION RECORD

Top, ft.	Bottom, ft.	Sacks cement	Shots per ft.	Size & type	Depth interval
			4	Jet	3539-36
			4	Jet	3496-91
			4	Jet	3397-75

#### TUBING RECORD

Size	Setting depth	Packer set at
2 3/8	3389	

### ACID, FRACTURE, SHOT, CEMENT SQUEEZE RECORD

Amount and kind of material used	Depth interval treated
250 gal. 28% HCL, 1000 gals. 15% HCL	3539-36
250 gal. 28% HCL, 1000 gals. 15% HCL	3496-91
1500 gal. 28% HCL, 6000 gals. 15% HCL, 200 lbs. acid flakes	3397-75

### INITIAL PRODUCTION

Date of first production <u>5-16-75</u>	Producing method (flowing, pumping, gas lift, etc.) <u>pumping</u>		
RATE OF PRODUCTION PER 24 HOURS	Oil <u>120</u> bbls.	Gas ---	Water <u>10</u> bbls. <span style="float: right;">CFPB</span>
Disposition of gas (vented, used on lease or sold)		Producing interval (s) <u>3539-36 3496-91 3397-93 3381-75</u>	

INSTRUCTIONS: As provided in KCC Rule 82-2-125, within 90 days after completion of a well, one completed copy of this Drillers Log shall be transmitted to the State Geological Survey of Kansas, 4150 Monroe Street, Wichita, Kansas 67209. Copies of this form are available from the Conservation Division, State Corporation Commission, 3830 So. Meridian (P.O. Box 17027), Wichita, Kansas 66217. Phone AC 316-522-2206. If confidential custody is desired, please note Rule 82-2-125. Drillers Logs will be on open file in the Oil and Gas Division, State Geological Survey of Kansas, Lawrence, Kansas 66044.

Operator

LADD PETROLEUM CORPORATION

DESIGNATE TYPE OF COMP.: OIL, GAS, DRY HOLE, SWDW, ETC.:

OIL

Well No.

2

Lease Name

Flory

S 16 T 1 R 18 W

WELL LOG

Show all important zones of porosity and contents thereof; cored intervals, and all drill-stem tests, including depth interval tested, cushion used, time tool open, flowing and shut-in pressures, and recoveries.

SHOW GEOLOGICAL MARKERS, LOGS RUN, OR OTHER DESCRIPTIVE INFORMATION.

FORMATION DESCRIPTION, CONTENTS, ETC.	TOP	BOTTOM	NAME	DEPTH
Lime - White, fine crystalline slightly foss. Light stain.	3375	3384	Heebner	3296
			Toronto	3325
			Lansing-K.C.	3344
			Base L-K.C.	3564
Lime - White, crystalline, foss., stained	3408	3415		
Lime - White, crystalline, chalky, cherty Light stain	3419	3427		
Lime - White, crystalline, foss., stained	3430	3442		
Lime - buff, crystalline, dense, light stain	3468	3483		
Lime - Lt. grey, crystalline, foss., stained	3491	3501		
Lime - Lt. grey, crystalline, dense, light stain	3508	3520		
Lime - buff, crystalline, chalky, light stain	3535	3549		

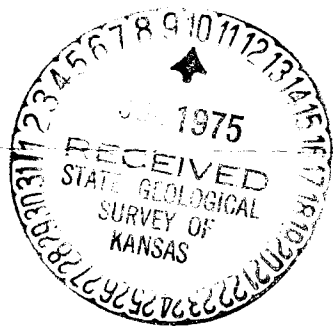

USE ADDITIONAL SHEETS, IF NECESSARY, TO COMPLETE WELL RECORD.

Date Received

*Kenneth Weikel*

Signature

Kenneth Weikel, Production Engineer, Tulsa Division

Title

May 30, 1975

Date

10-1-18m

DRILLERS LOG

No. 2 Flory

CASING RECORD:

8-5/8" @ 255'  
w/175 sx. cmt.

5 1/2" @ 3579'  
w/250 sx. cmt.

COMPANY:

CONTRACTOR:

COMMENCED:

COMPLETED:

Ladd Petroleum Corporation

Red Tiger Drilling Company

4-8-75

4-15-75

DESCRIPTION:

C NE NW  
16-1S-18W  
Phillips County,  
Kansas

TOTAL DEPTH: 3580'

ELEVATION: 2146'

FORMATION

FROM

TO

REMARKS

Shale	0	262
Clay & Shale	262	670
Shale	670	925
Shale & Sand	925	1570
Shale	1570	2515
Shale & Lime	2515	2910
Lime	2910	3010
Lime & Shale	3010	3095
Lime	3095	3580



I certify that this is a true and correct copy of the above log to the best of my knowledge.

RED TIGER DRILLING COMPANY

Gloria P. Fawcett  
Gloria P. Fawcett

Subscribed and sworn to before me this 23rd day of April, 1975.

D'Ann Presman  
Notary Public

My Commission Expires: