

IMPORTANT
 Kans. Geo. Survey request
 samples on this well.

28-1-25W
 State Geological Survey
 WICHITA, BRANCH
 S. 28 T. 1S R. 25 W

KANSAS DRILLERS LOG

API No. 15 — 137 — 20,140
 County Number

Loc. C NE NW
 County Norton

Operator
Cinco Exploration Co.

Address
800 Harwin, Suite 398 Houston, Texas 77036

Well No. #1 Lease Name Marquerite Temple

Footage Location
660 feet from (N) SEX line 1980 feet from (W) SEX line

Principal Contractor Abercrombie Drilling Co. Geologist Alfred W. Stude

Spud Date 3-14-79 Total Depth 3685 P.B.T.D.

Date Completed 3-21-79 Oil Purchaser

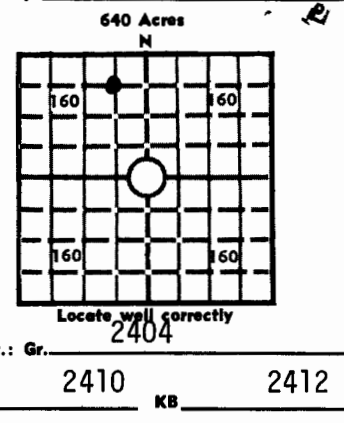

Directional Deviation 1928 **CASING RECORD**

Report of all strings set — surface, intermediate, production, etc.

Purpose of string	Size hole drilled	Size casing set (in O.D.)	Weight lbs/ft.	Setting depth	Type cement	Sacks	Type and percent additives
Surface	12-1/4"	8-5/8"	28#	271	60/40 Poz mix	170	3% CA C/2 2% Gel

LINER RECORD

PERFORATION RECORD

Top, ft.	Bottom, ft.	Sacks cement	Shots per ft.	Size & type	Depth interval

TUBING RECORD

Size	Setting depth	Packer set at

ACID, FRACTURE, SHOT, CEMENT SQUEEZE RECORD

Amount and kind of material used	Depth interval treated

INITIAL PRODUCTION

Date of first production		Producing method (flowing, pumping, gas lift, etc.)			
RATE OF PRODUCTION PER 24 HOURS	Oil	Gas	Water	Gas-oil ratio	
	bbls.	MCF	bbls.	CFPB	
Disposition of gas (vented, used on lease or sold)			Producing interval(s)		

INSTRUCTIONS: As provided in KCC Rule 82-2-125, within 90 days after completion of a well, one completed copy of this Drillers Log shall be transmitted to the State Geological Survey of Kansas, 4150 Monroe Street, Wichita, Kansas 67209. Copies of this form are available from the Conservation Division, State Corporation Commission, 3830 So. Meridian (P.O. Box 17027), Wichita, Kansas 66217. Phone AC 316-522-2206. If confidential custody is desired, please note Rule 82-2-125. Drillers Logs will be on open file in the Oil and Gas Division, State Geological Survey of Kansas, Lawrence, Kansas 66044.

Operator CINCO EXPLORATION COMPANY DESIGNATE TYPE OF COMP.: OIL, GAS, DRY HOLE, SWDW, ETC.:

Well No. L Lease Name Marguerite Temple dry hole

S 28 T 1s R 25 R W

WELL LOG
 Show all important zones of porosity and contents thereof; cored intervals, and all drill-stem tests, including depth interval tested, cushion used, time tool open, flowing and shut-in pressures, and recoveries.
 SHOW GEOLOGICAL MARKERS, LOGS RUN, OR OTHER DESCRIPTIVE INFORMATION.

FORMATION DESCRIPTION, CONTENTS, ETC.	TOP	Subsea	NAME	DEPTH
Anhydrite	1928	- 485		
Base Anhydrite	1954	- 458		
Topeka	3101	- 694		
Heebner	3262	- 851		
Toronto	3296	- 884		
Lansing	3303	- 891		
Base Kansas City	3507	-1094		
Granite Wash	3608	-1196		
Solid Granite	3676	-1264		
T D	3688	-1276		
DST #1 3262-3315 30/45/30/45 IF 42#/157# ISI 1147#/1147# FF 157#/241# FSI 1147#/1147# Recovered 440' Muddy water 105°F. Ran Schlumberger Dual Ind. Laterolog from 3688'to 270'. Ran Compensated GR DN Log from 3688 to 272' No Oil or gas shows P/A 3-21-79				

USE ADDITIONAL SHEETS, IF NECESSARY, TO COMPLETE WELL RECORD.

Date Received

MELVIN KLOTZMAN Signature
 Petroleum Consultant
 8-18-80 Title
 Date

800067

08-1-82

CONTRACTOR'S WELL LOG

OPERATOR:	Cinco Exploration Company
CONTRACTOR:	Abercrombie Drilling, Inc.
WELL NAME:	Marguerite Temple #1
LOCATION:	C NE NW, Section 28-1S-25W Norton County, Kansas
SPUD DATE:	March 14, 1979
COMPLETION DATE:	March 21, 1979

0	270	Surface soil, sand and shale
270	1927	Shale and sand
1927	1954	Anhydrite
1954	2282	Shale and sand
2282	3443	Lime and shale
3443	3492	Lime
3492	3624	Lime and shale
3624	3685	Lime, granite wash
	3685	Rotary Total Depth

Spud hole at 4:00 p.m., March 14, 1979. Drilled 272' of 12 1/4" hole. Ran 6 joints of 8-5/8" - 28# casing. Set at 271' with 170 sacks of 60/40 posmix, 3% Ca.Cl., 2% gel. Cement did circulate. Plug was down at 8:45 p.m., March 14, 1979.

T.D. 3685'. Set 1st plug at 950' with 70 sacks, 2nd plug at 240' with 20 sacks, 3rd plug at 40' solid bridge with 10 sacks, rathole with 5 sacks. Cemented with 50/50 posmix, 6% gel. Job was complete at 9:15 a.m., March 21, 1979.

SAMPLE TOPS:

Anhydrite	1927'
B/Anhydrite	1954'

STATE OF KANSAS)
) ss
COUNTY OF SEDGWICK)

Jack L. Partridge, Assistant Secretary-Treasurer of Abercrombie Drilling, Inc., does hereby state, that the above and foregoing is a true and correct copy of the log of the Marguerite Temple #1, C NE NW, Section 28-1S-25W, Norton County, Kansas.

ABERCROMBIE DRILLING, INC.

BY Jack L. Partridge
Jack L. Partridge
Assistant Secretary-Treasurer

Subscribed and sworn to before me, a Notary Public, in and for the county and state aforesaid, as of this 28th day of March, 1979.



Sherrie L. Brooks
Sherrie Brooks, Notary Public

My commission expires 8-21-82.