

10-1-26 W

KANSAS DRILLERS LOG

S. 10 T. 1S R. 26 ~~XX~~ W

Loc. 50' S of NW SE NE

County Decatur County

API No. 15 — 039 — 20285
County Number

Operator
W. W. SAUVAGE, INC.

Address
P. O. BOX 132, OBERLIN, KANSAS 67749

Well No. #3 (TWIN) Lease Name HUFF "A"

Footage Location
1650 feet from (N) line 990 feet from (E) line

Principal Contractor ABERCROMBIE DRILLING, INC. Geologist JACK K. WHARTON

Spud Date April 19, 1974 Total Depth 3596' K.B. P.B.T.D. 3560'

Date Completed May 20, 1974 Oil Purchaser Koch Oil Company

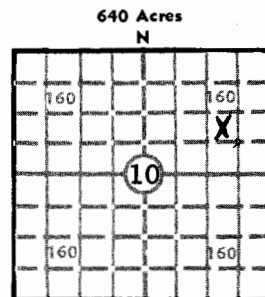

Locate well correctly

Elev.: Gr. 2488'

DF 2494' KB 2496'

CASING RECORD

Report of all strings set— surface, intermediate, production, etc.

Purpose of string	Size hole drilled	Size casing set (in O.D.)	Weight lbs/ft.	Setting depth	Type cement	Sacks	Type and percent additives
Surface	9"	7"		1727'	50/50 Posmix	500	3% gel, 1% Calcium Chloride
Production	6 1/4"	4 1/2"	9 1/2#	3595'	50/50 Posmix	25	2% gel, 12# gilsonite per sack
					Common	75	10% salt, 2% gel

LINER RECORD

PERFORATION RECORD

Top, ft.	Bottom, ft.	Sacks cement	Shots per ft.	Size & type	Depth interval
			4		3466 - 3469
TUBING RECORD			4		3328 - 3332
Size	Setting depth	Packer set at	4		3286 - 3289
2"	3557				

ACID, FRACTURE, SHOT, CEMENT SQUEEZE RECORD

Amount and kind of material used	Depth interval treated
500 gal 15% Non-E	3466 - 3469
3000 gal 15% Non-E	3328 - 3332
	3286 - 3289

INITIAL PRODUCTION

Date of first production		Producing method (flowing, pumping, gas lift, etc.)			
RATE OF PRODUCTION PER 24 HOURS	Oil	Gas	Water	Gas-oil ratio	
	bbls.	MCF	bbls.	CFPB	
Disposition of gas (vented, used on lease or sold)			Producing interval (s)		
			3286 - 3469		

INSTRUCTIONS: As provided in KCC Rule 82-2-125, within 90 days after completion of a well, one completed copy of this Drillers Log shall be transmitted to the State Geological Survey of Kansas, 4150 Monroe Street, Wichita, Kansas 67209. Copies of this form are available from the Conservation Division, State Corporation Commission, 3830 So. Meridian (P.O. Box 17027), Wichita, Kansas 66217. Phone AC 316-522-2206. If confidential custody is desired, please note Rule 82-2-125. Drillers Logs will be on open file in the Oil and Gas Division, State Geological Survey of Kansas, Lawrence, Kansas 66044.

Operator
W. W. SAUVAGE, INC.

DESIGNATE TYPE OF COMP.: OIL, GAS,
DRY HOLE, SWDW, ETC.:
Oil Well

Well No. #3 (Twin) Lease Name HUFF "A"

S 10 T 1S R 26 W

WELL LOG

Show all important zones of porosity and contents thereof; cored intervals, and all drill-stem tests, including depth interval tested, cushion used, time tool open, flowing and shut-in pressures, and recoveries.

SHOW GEOLOGICAL MARKERS, LOGS RUN,
OR OTHER DESCRIPTIVE INFORMATION.

FORMATION DESCRIPTION, CONTENTS, ETC.	TOP	BOTTOM	NAME	DEPTH
Sand & Clay	0	120	<u>Electric Log</u>	
Rock	120	126	Anhydrite	1964
Shale and Sand Streaks	126	1130	B/Anhydrite	1992
Sand	1130	1270	Heebner	3246
Shale	1270	1613	Toronto	3281
Sand	1613	1736	Lansing	3286
Shale	1736	1960	B/ K.C.	3495
Anhydrite	1960	1991	Reagan Sand	3584
Shale	1991	2385	Granite Wash	3591
Lime & Shale	2385	2838	ELTD	3584
Shale & Lime	2838	3050		
Lime and Shale	3050	3297		
Shale and Lime	3297	3370		
Lime	3370	3596		
Rotary Total Depth		3596		
<u>DST #1 (3247-3297) 30"-30"-30"-30"</u> Recovered 65' OCM. Weak flow. IFP 52-52#, IBHP 757#, FFP 73-73#, FBHP 716#. BHT 98°.				
<u>DST #2 (3296-3370) 30"- 45"- 60" -30"</u> Recovered 20' MCO, 60' OCM (50% Oil) IFP 52-52#, IBHP 872#, FFP 73-73#, FBHP 757#. BHT 98°.				
<u>DST #3 (3444-3479) 30"-30"-60"-30"</u> Recovered 300' MCO, 500' SW. IFP 52-190#, IBHP 1008#, FFP 232-413#, FBHP 966#, BHT 102°.				



USE ADDITIONAL SHEETS, IF NECESSARY, TO COMPLETE WELL RECORD.

Date Received	<i>Jack K. Wharton</i> Signature
	Jack K. Wharton Geologist
	Title
	May 20, 1974 Date