

21-1-32w

KANSAS DRILLERS LOG

S. 21 T. 1 R. 32 ^RW
Loc. 1980' FNL & 660' FWL
County Rawlins

API No. 15 — 153 — 20,249
County Number

MAR 17 1977

Operator
Skelly Oil Company

Address
Box 339 Hays, Kansas 67601

Well No. #20 Lease Name Wilhelm Unit

Footage Location
1980 feet from (N) line 660 feet from (W) line

Principal Contractor Murfin Drilling Co. Geologist

Spud Date March 6, 1976 Total Depth 4240' P.B.T.D. 4206'

Date Completed March 27, 1976 Oil Purchaser Koch Oil Ind.

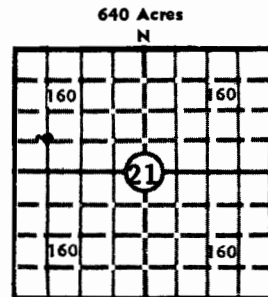

Locate well correctly
Elev.: Gr. 3005'
DF _____ KB 3010'

CASING RECORD

Report of all strings set — surface, intermediate, production, etc.

Purpose of string	Size hole drilled	Size casing set (in O.D.)	Weight lbs/ft.	Setting depth	Type cement	Sacks	Type and percent additives
Surface	12 1/2"	8 5/8"	24	372'	Common	250	2% Ca.C1.
Production	7 7/8"	5 1/2"	14	4240'	Regular	250	3/4% CFR-2 & 18% Salt

LINER RECORD

PERFORATION RECORD

Top, ft.	Bottom, ft.	Sacks cement	Shots per ft.	Size & type	Depth interval
None			4	Super Dyna Jets	4156'-4161'
			4	" " "	4152'-4154'
			4	" " "	4111'-4114'
			4	" " "	4008'-4015'
			4	" " "	3977'-3980'

TUBING RECORD

Size	Setting depth	Packer set at
2 3/8"	4195'	

ACID, FRACTURE, SHOT, CEMENT SQUEEZE RECORD

Amount and kind of material used	Depth interval treated
750 gals. Howco 15% NE Acid	4156'-4161' & 4152-4154'
500 gals. Howco 15% NE Acid	4111-4114'
750 gals. Howco 15% NE HCL Acid	4008-4015'
500 gals. Howco 15% NE HCL Acid	3977-3980

INITIAL PRODUCTION

Date of first production <u>4-1-76</u>	Producing method (flowing, pumping, gas lift, etc.) <u>Pumping</u>
RATE OF PRODUCTION PER 24 HOURS	Oil <u>80</u> bbls. Gas <u>0</u> MCF Water <u>15</u> bbls. Gas-oil ratio _____ CFPB
Disposition of gas (vented, used on lease or sold) <u>None</u>	Producing interval (s) <u>3977-4161'</u>

INSTRUCTIONS: As provided in KCC Rule 82-2-125, within 90 days after completion of a well, one completed copy of this Drillers Log shall be transmitted to the State Geological Survey of Kansas, 4150 Monroe Street, Wichita, Kansas 67209. Copies of this form are available from the Conservation Division, State Corporation Commission, 3830 So. Meridian (P.O. Box 17027), Wichita, Kansas 66217. Phone AC 316-522-2206. If confidential custody is desired, please note Rule 82-2-125. Drillers Logs will be on open file in the Oil and Gas Division, State Geological Survey of Kansas, Lawrence, Kansas 66044.

Operator

DESIGNATE TYPE OF COMP.: OIL, GAS, DRY HOLE, SWDW, ETC.:

Well No.

20

Lease Name

Wilhelm Unit

Oil

S 21 T 1S R 32 W

WELL LOG

Show all important zones of porosity and contents thereof; cored intervals, and all drill-stem tests, including depth interval tested, cushion used, time tool open, flowing and shut-in pressures, and recoveries.

SHOW GEOLOGICAL MARKERS, LOGS RUN, OR OTHER DESCRIPTIVE INFORMATION.

FORMATION DESCRIPTION, CONTENTS, ETC.	TOP	BOTTOM	NAME	DEPTH
Sand & Shale	Surface	374		
Shale	374	1930		
Sand & Shale	1930	3145		
Lime & Shale	3145	4240	Lansing KC "A"	3931'
			"D"	3977'
			"G"	4008'
			"H"	4064'
			"J"	4110'
			"K"	4151'

USE ADDITIONAL SHEETS, IF NECESSARY, TO COMPLETE WELL RECORD.

Date Received

Frank Renard

Signature

Area Superintendent

Title

June 10, 1976

Date

21-1-32W
C SW NW

WELL LOG

COMPANY Skelly Oil

SEC. 21 T. 1S R. 32W
LOC. 1980' fNL & 660' fWL

FARM WILHELM UNIT

NO. 20

RIG. NO. 3

TOTAL DEPTH 4240'

COUNTY Rawlins
KANSAS

COMM. 3/6/76

COMP. 3/13/76

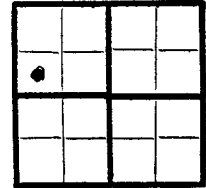

CONTRACTOR Murfin Drilling

CASING

20	10
15	8 5/8" @ 372' w/250 SX
12	6
13	5 1/2" @ 4240' w/250 SX

ELEVATION

PRODUCTION Prod.

FIGURES INDICATE BOTTOM OF FORMATIONS

374 - sand, clay & shale
 1930 - shale
 3145 - sand, shale
 4240 - lime, shale
 4240 - TD

K. G. S. LIBRARY

LOG TOPS	DEPTH
LANS A	3931
LANS D	3977
LANS G	4008-
LANS H	4064
LANS J	4110
LANS K	4151
RTD	4240

