

27-1-34W

**KANSAS DRILLERS LOG**

State Geological Survey  
 WICHITA BRANCH  
 Kans. Geo. Survey request  
 sample 2023 on this well.  
 Number

S. 27 T. 1 R. 34 <sup>E</sup>W  
 Loc. NW NW  
 County Rawlins

API No. 15 — 153  
 County

Operator  
 Sands-American Corp.

Address  
 5889 South Syracuse Circle, #203, Englewood, Colorado 80110

Well No. #1 Lease Name Cech

Footage Location 660' 660'  
 feet from (N) (S) line feet from (E) (W) line

Principal Contractor Globe Drilling Company Geologist Orlin Phelps

Spud Date 3-8-76 Total Depth 4326' P.B.T.D. ---

Date Completed 3-23-76 Oil Purchaser Husky

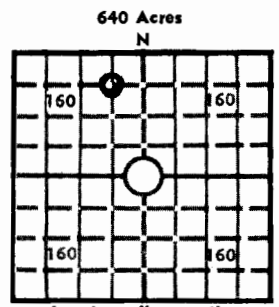

Locate well correctly  
 Elev.: Gr. 3124'  
 DF 3126' KB 3129'

**CASING RECORD**

Report of all strings set — surface, intermediate, production, etc.

Purpose of string	Size hole drilled	Size casing set (in O.D.)	Weight lbs/ft.	Setting depth	Type cement	Sacks	Type and percent additives
Surface	10-3/4"	8-1/8"	24#	240'	Neat	200	3% gel, 3% cal
Production	7-7/8"	4-1/2"	10-1/2#	4330'	50/50 Poz	200	aa

**LINER RECORD**

**PERFORATION RECORD**

Top, ft.	Bottom, ft.	Sacks cement	Shots per ft.	Size & type	Depth interval
---	---	---	2/ft.	D.P.	4116-4121'
<b>TUBING RECORD</b>			2/ft.	D.P.	4164-4171'
Size	Setting depth	Packer set at	2/ft.	D.P.	4224-4229'
2-3/8"	4100'	---	2/ft.	D.P.	4224-4229'

**ACID, FRACTURE, SHOT, CEMENT SQUEEZE RECORD**

Amount and kind of material used	Depth interval treated
250 gel - 15% Non-E-Acid	4224-4229'
250 gel - 15% Non-E-Acid	4164-4171'
250 gel - 15% Non-E-Acid	4116-4121'

**INITIAL PRODUCTION**

Date of first production 4-15-76	Producing method (flowing, pumping, gas lift, etc.) Pumping
RATE OF PRODUCTION PER 24 HOURS	Oil bbls. Gas --- MCF Water bbls. Gas-oil ratio --- CFPB
Disposition of gas (vented, used on lease or sold) Used on lease	Producing interval(s) Lansing/Kansas City 4116-4121'

INSTRUCTIONS: As provided in KCC Rule 82-2-125, within 90 days after completion of a well, one completed copy of this Drillers Log shall be transmitted to the State Geological Survey of Kansas, 4150 Monroe Street, Wichita, Kansas 67209. Copies of this form are available from the Conservation Division, State Corporation Commission, 3830 So. Meridian (P.O. Box 17027), Wichita, Kansas 66217. Phone AC 316-522-2206. If confidential custody is desired, please note Rule 82-2-125. Drillers Logs will be on open file in the Oil and Gas Division, State Geological Survey of Kansas, Lawrence, Kansas 66044.

Operator  
Sands-American Corp. DESIGNATE TYPE OF COMP.: OIL, GAS,  
DRY HOLE, SWDW, ETC.:

Well No. 1 Lease Name Cech Oil

S 27 T 1S R 34 <sup>F</sup>W

**WELL LOG**

Show all important zones of porosity and contents thereof; cored intervals, and all drill-stem tests, including depth interval tested, cushion used, time tool open, flowing and shut-in pressures, and recoveries.

SHOW GEOLOGICAL MARKERS, LOGS RUN, OR OTHER DESCRIPTIVE INFORMATION.

FORMATION DESCRIPTION, CONTENTS, ETC.	TOP	BOTTOM	NAME	DEPTH
Surface Dist.	0	20		
Undifferentiated shale & sand	20	980		
Shale	980	1240		
Undifferentiated shale & sand	1240	1490		
Sand	1490	1538		
Sand and shale	1538	2940		
Anhydrite	2971	3030	Anhydrite	2971-3020
Shale and lime	3030	3950	Hiebner	4003-07
Lime	3950	4000	Lansing	4063-4306
Lime and shale	4000	4326	Base K. C.	
RTD		4326		

USE ADDITIONAL SHEETS, IF NECESSARY, TO COMPLETE WELL RECORD.

Date Received

*James P. McGinnis*  
Signature

James P. McGinnis, Secretary  
Title

April 19, 1976  
Date