

8-1-34w

KANSAS DRILLERS LOG

S. 8 T. 1S R. 34 ~~XX~~W

API No. 15 — 153 — 20,210
County Number

Loc. C NW SW

County Rawlins

Operator
Beren Corporation

Address
970 Fourth Financial Center, Wichita, Ks. 67202

Well No. 1 Lease Name Bartosovsky

Footage Location
1980 feet from ~~XX~~ (S) line 660 feet from ~~XX~~ (W) line

Principal Contractor Geologist
Murfin Drilling Company Bob Lewellyn

Spud Date Total Depth P.B.T.D.
September 10, 1975 4335' -----

Date Completed Oil Purchaser
September 20, 1975 -----

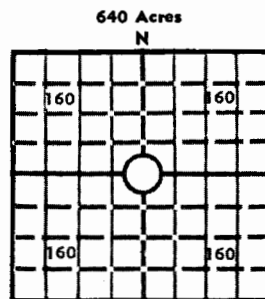

640 Acres
N
Locate well correctly

Elev.: Gr. 3128

DF _____ KB 3133

CASING RECORD

Report of all strings set — surface, intermediate, production, etc.

Purpose of string	Size hole drilled	Size casing set (in O.D.)	Weight lbs/ft.	Setting depth	Type cement	Sacks	Type and percent additives
Surface	12½"	8-5/8"	24#	331'	Common 60/50	25sx. 180sx.	2% Gel, 3% CC

LINER RECORD

PERFORATION RECORD

Top, ft.	Bottom, ft.	Sacks cement	Shots per ft.	Size & type	Depth interval

TUBING RECORD

Size	Setting depth	Packer set at

ACID, FRACTURE, SHOT, CEMENT SQUEEZE RECORD

Amount and kind of material used	Depth interval treated

INITIAL PRODUCTION

Date of first production		Producing method (flowing, pumping, gas lift, etc.)			
RATE OF PRODUCTION PER 24 HOURS	Oil	Gas	Water	Gas-oil ratio	
	bbis.	MCF	bbis.	CFPB	
Disposition of gas (vented, used on lease or sold)			Producing interval(s)		

INSTRUCTIONS: As provided in KCC Rule 82-2-125, within 90 days after completion of a well, one completed copy of this Drillers Log shall be transmitted to the State Geological Survey of Kansas, 4150 Monroe Street, Wichita, Kansas 67209. Copies of this form are available from the Conservation Division, State Corporation Commission, 3830 So. Meridian (P.O. Box 17027), Wichita, Kansas 66217. Phone AC 316-522-2206. If confidential custody is desired, please note Rule 82-2-125. Drillers Logs will be on open file in the Oil and Gas Division, State Geological Survey of Kansas, Lawrence, Kansas 66044.

Operator Beren Corporation DESIGNATE TYPE OF COMP.: OIL, GAS, DRY HOLE, SWDW, ETC.: Dry Hole

Well No. 1 Lease Name Bartosovsky

S 8 T 15 R 34 Ex W

WELL LOG

Show all important zones of porosity and contents thereof; cored intervals, and all drill-stem tests, including depth interval tested, cushion used, time tool open, flowing and shut-in pressures, and recoveries.

SHOW GEOLOGICAL MARKERS, LOGS RUN, OR OTHER DESCRIPTIVE INFORMATION.

FORMATION DESCRIPTION, CONTENTS, ETC.	TOP	BOTTOM	NAME	DEPTH
#1 30/45/120/60 Rec. 120' mud, VSSO 1103/1014 15/54 62/93	3584	3631	Anhydrite Foraker	2982 3615
#2 30/45/120/60 Rec. 185' mud 1155/1108 31/70 62/140	3628	3670	Topeka Oread	3834 3925
#3 30/30/30/30 Rec. 3' mud 0/0 8/8 0/0	4034	4050	Lansing K.C.	4036
#4 30/30/30/30 Rec. 100' SOCM 1006/950 62/101	4040	4105	RTD	4335
#5 30/30/30/30 Weak blow 25 min. Rec. 20' mud 312/171 59/74 62/62	4095	4155		
#6 30/45/30/45 Weak blow 30 min. Rec. 30' MO, 60' OCM 452/398 55/78	4148	4210		
#7 30/30/30/30 Rec. 2' oil, 10' MO 226/125 20/33	4230	4245		
#8 30/30/30/30 Rec. 20' mud 795/686 62/78	4240	4335		

USE ADDITIONAL SHEETS, IF NECESSARY, TO COMPLETE WELL RECORD.

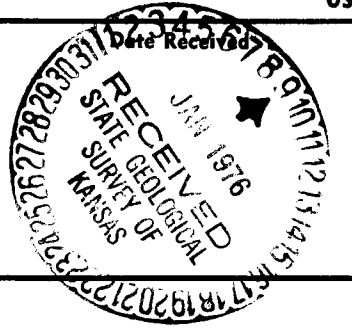

Max S Houston
Signature

Max. S. Houston, Geologist
Title

October 13, 1975
Date

8-1-3600