

STATE CORPORATION COMMISSION OF KANSAS
OIL & GAS CONSERVATION DIVISION

WELL COMPLETION OR RECOMPLETION FORM
ACO-1 WELL HISTORY

DESCRIPTION OF WELL AND LEASE

Operator: license # 5011
name Viking Resources
address 217 E. William
Wichita KS 67202-4005
City/State/Zip

Operator Contact Person Jim Devlin
Phone 316-262-2502

Contractor: license # 5420
name White and Ellis Drilling, Inc.

Wellsite Geologist Jim Maloney
Phone 316-262-2502

Designate Type of Completion
 New Well Re-Entry Workover
 Oil SWD Temp Abd
 Gas Inj Delayed Comp.
 Dry Other (Core, Water Supply etc.)

Old well info as follows:
Operator
Well Name
Comp. Date Old Total Depth

WELL HISTORY

Drilling Method: Mud Rotary Air Rotary Cable
6-8-85 6-17-85 7-1-85
Spud Date Date Reached TD Completion Date
4820 4410
Total Depth PBD

Amount of Surface Pipe Set and Cemented at 281 @ 289 feet

Multiple Stage Cementing Collar Used? Yes No

If Yes, Show Depth Set feet

Alternate 2 completion, cement circulated
from feet depth to w/ SX cmt

API NO. 15 - 153-20,610 **35-1-35W**

County Rawlins

S/2 SE NE (location) Sec 35 Twp 1s Rge 35 East West

2970 Ft North from Southeast Corner of Section
660 Ft West from Southeast Corner of Section
(Note: locate well in section plat below)

Lease Name Prochazka Well# 1

Field Name Wildcat St. John Cemetery

Producing Formation Lansing-Kansas City

Elevation: Ground 3215 KB 3220

Section Plat

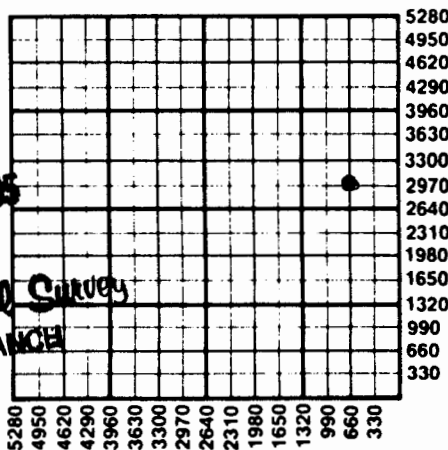

SEP 09 1985
State Geological Survey
WICHITA BRANCH

WATER SUPPLY INFORMATION

Source of Water:
Division of Water Resources Permit #

Groundwater Ft North From Southeast Corner and
(Well) Ft. West From Southeast Corner of
Sec Twp Rge East West

Surface Water Ft North From Southeast Corner and
(Stream, Pond etc.) Ft West From Southeast Corner
Sec Twp Rge East West

Other (explain) City of Atwood
(purchased from city, R.W.D.#)

Disposition of Produced Water: Disposal Repressuring

Docket #

INSTRUCTIONS: This form shall be completed in duplicate and filed with the Kansas Corporation Commission, 200 Colorado Derby Building, Wichita, Kansas 67202, within 90 days after completion or recompletion of any well. Rules 82-3-130 and 82-3-107 apply.

Information on side two of this form will be held confidential for a period of 12 months if requested in writing and submitted with the form. See rule 82-3-107 for confidentiality in excess of 12 months.

A copy of all wireline logs and drillers time log shall be attached with this form. Submit CP-4 form with all plugged wells. Submit CP-111 form with temporarily abandoned wells.

RECEIVED
STATE CORPORATION COMMISSION
JUL 02 1985
CONSERVATION DIVISION

WELL LOG

INSTRUCTIONS: Show important tops and base of formations penetrated. Detail all cores. Report all drill stem tests giving interval tested, time tool open and closed, flowing and shut-in pressures, whether shut-in pressure reached static level, hydrostatic pressures, bottom hole temperature, fluid recovery, and flow rates if gas to surface during test. Attach extra sheet if more space is needed. Attach copy of log.

Drill Stem Tests Taken Yes No
 Samples Sent to Geological Survey Yes No
 Cores Taken Yes No

Formation Description
 Log Sample

DST #1, 4062-4200 - 30-30-60-60, Recovered 20' Oil (28 grav), 15' Heavy Oil Cut Mud, 124' Oil Cut Watery Mud, 124' Oil Cut Watery Mud, 62' Oil Spotted Muddy Water, 186' Muddy Salt Water, BHP: 1201/1212, FP: 119/173 206/282, HP: 2227/2206 BHT: 110°

DST #2, 4290-4340, 30-30-60-60, Recovered 950' Gas in pipe, 132' Mud Cut Oil, 105' Oil (35 grav), 189' Mud Cut Gassy Oil, 63' Oil Cut Mud, BHP: 1255/1255, FP: 76/97 119/184, HP: 2248/2217

Name	Top	Bottom
Heebner	4077 (-857)	
LKC	4128 (-908)	
BKC	4392 (-1172)	
Pawnee	4504 (-1284)	
Ft. Scott	4594 (-1374)	
Cher. Shale	4615 (-1395)	
Cher. Sand	4670 (-1450)	
Mississippian	4761 (-1541)	
LTD	4818 (-1598)	
RTD	4820 (-1600)	

.....

TUBING RECORD size 2-3/8 set at 4340 packer at		Liner Run <input type="checkbox"/> Yes <input type="checkbox"/> No	
Date of First Production	Producing method <input type="checkbox"/> flowing <input checked="" type="checkbox"/> pumping <input type="checkbox"/> gas lift <input type="checkbox"/> Other (explain)		
7-1-85			
Estimated Production Per 24 Hours	Oil	Gas	Water
	112 Bbls	None MCF	None Bbls
			Gas-Oil Ratio CFPB

METHOD OF COMPLETION		PRODUCTION INTERVAL
Disposition of gas: <input type="checkbox"/> vented <input type="checkbox"/> sold	<input type="checkbox"/> open hole <input checked="" type="checkbox"/> perforation <input type="checkbox"/> other (specify)	4321-4326

CASING RECORD <input checked="" type="checkbox"/> new <input type="checkbox"/> used							
Report all strings set - conductor, surface, intermediate, production, etc.							
Purpose of string	size hole drilled	size casing set (in O.D.)	weight lbs/ft.	setting depth	type of cement	# sacks used	type and percent additives
Surface Production	12 1/4	8-5/8	20	289	60/40 Poz	185	2% gel, 3% cc
	7-7/8	4-1/2	105	4453.5	Phixotropic	150	

PERFORATION RECORD		Acid, Fracture, Shot, Cement Squeeze Record	
shots per foot	specify footage of each interval perforated	(amount and kind of material used)	Depth
2	4321 - 4326	1500 gallons 28% NE	4321-26

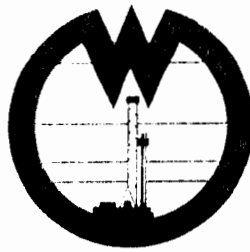

35-1-35W
PI

WHITE

AND ELLIS DRILLING, Inc.

DRILLERS LOG

OPERATOR: Viking Resources
217 E. William
Wichita, KS 67202

CONTRACTOR: White & Ellis Drilling, Inc., 401 E. Douglas, Suite 500,
Wichita, Ks. 67202

Lease Name Prochazka Well No. 1

Sec. 35 T. 1 R. 35W Spot S/2 SW NE

County Rawlins State Kansas Elevation _____

Casing Record:

Surface: 8 5/8 @ 289' with 185 sx.

Production: 4 1/2" @ 4453' with 150 sx.

Type Well: D & A Total Depth 4820'

Drilling Commenced 6-5-85 Drilling Completed 6-17-85

Formation	From	To	Tops
Cellar	0	7	Anhydrite -3056
Shale, Sand	7	40	
Sand, Shale	40	1424	
Shale, Sand	1424	2141	
Shale	2141	2650	
Shale, Lime	2650	2870	
Shale	2870	3056	
Lime	3056	3850	
Shale, Lime	3850	3985	
Lime	3985	4075	
Lime, Shale	4075	4195	
Lime	4195	4820	

1985
State Geological Survey
WICHITA BRANCH