

15-153-20298
36-1-36W

KANSAS DRILLERS LOG

S. 36T. 1 R. 36^E_W
Loc. C SW SE

API No. 15 _____
County _____ Number _____

County _____

Operator
Murfin Drilling Company

Address
617 Union Center, Wichita, KS 67202

Well No. 1 Lease Name RAY

Footage Location
660 feet from (S) line 660 feet from (W) line

Principal Contractor Murfin Drilling Co. Geologist Roger Welty

Spud Date 8/26/77 Total Depth 4850' P.B.T.D. 4448'

Date Completed 9/6/77 Oil Purchaser Husky Oil

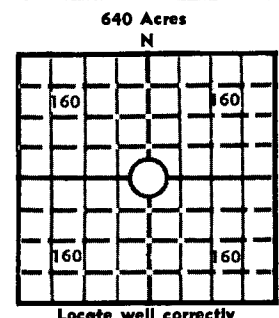

Elev.: Gr. _____
DF _____ KB _____

CASING RECORD

Report of all strings set— surface, intermediate, production, etc.

Purpose of string	Size hole drilled	Size casing set (in O.D.)	Weight lbs/ft.	Setting depth	Type cement	Sacks	Type and percent additives
Surface Csg.	12 1/4"	8 5/8"	24#	260'	60/40 Poz	250	3% CC
Production Csg.	7 7/8"	5 1/2"	15.5#	4491'	Common Common Latex	100 65	3/4% CFR2 +10% Salt

LINER RECORD

PERFORATION RECORD

Top, ft.	Bottom, ft.	Sacks cement	Shots per ft.	Size & type	Depth interval
			4	Super Dyna Jets	4412-16'

TUBING RECORD		
Size	Setting depth	Packer set at
2 7/8"	4420.17'	

ACID, FRACTURE, SHOT, CEMENT SQUEEZE RECORD

Amount and kind of material used	Depth interval treated
None	

INITIAL PRODUCTION

Date of first production <u>10/13/77</u>	Producing method (flowing, pumping, gas lift, etc.) <u>Pumping</u>
RATE OF PRODUCTION PER 24 HOURS	Oil <u>140</u> bbls. MCF <u>1</u> bbls. Gas-oil ratio <u>CFPB</u>
Disposition of gas (vented, used on lease or sold)	Producing interval (s)

INSTRUCTIONS: As provided in KCC Rule 82-2-125, within 90 days after completion of a well, one completed copy of this Drillers Log shall be transmitted to the State Geological Survey of Kansas, 4150 Monroe Street, Wichita, Kansas 67209. Copies of this form are available from the Conservation Division, State Corporation Commission, 3830 So. Meridian (P.O. Box 17027), Wichita, Kansas 66217. Phone AC 316-522-2206. If confidential custody is desired, please note Rule 82-2-125. Drillers Logs will be on open file in the Oil and Gas Division, State Geological Survey of Kansas, Lawrence, Kansas 66044.

Operator **Murfin Drilling Company** DESIGNATE TYPE OF COMP.: OIL, GAS, DRY HOLE, SWDW, ETC.: **Oil**

Well No. **1** Lease Name **Ray**

S 36 T 1S R 36 W

WELL LOG

Show all important zones of porosity and contents thereof; cored intervals, and all drill-stem tests, including depth interval tested, cushion used, time tool open, flowing and shut-in pressures, and recoveries.

SHOW GEOLOGICAL MARKERS, LOGS RUN, OR OTHER DESCRIPTIVE INFORMATION.

FORMATION DESCRIPTION, CONTENTS, ETC.	TOP	BOTTOM	NAME	DEPTH
sand, clay		220	Anhydrite	3152 +126
shale		1780	B/Anhydrite	3189 + 89
shale, sand		3385	Oread	4099 -821
shale, lime		4850	Lansing	4209 -931
RTD		4850	Base K.C.	4477 -999
			Cherokee sh.	4650 -1372
			TD	4850

DST #1: 4070-4120'/30-30-30-30, 1000' G, 1150' Fl., 833' MGO, 217' SOCW, 1255-223-472-1232, 124⁰. DST #2: 4234-75'/30-30-30-30, wk bl to fr in 5", decr. & died in 22", 100' TM, no show, 1224-75-75-1164, 134⁰. DST #3: 4276-94'/30-30-30-30, 190' MCO, 1410' SW, 1297-125-512-1297#. DST #4: 4383-4430'/30-30-30-30, 1400' G, 1702' O (32 d.), 124' MCO, 62' HOGCM, 62' OCMW, 1345-362-753-1321#.

USE ADDITIONAL SHEETS, IF NECESSARY, TO COMPLETE WELL RECORD.

Date Received _____

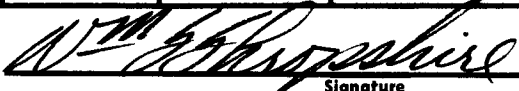
 Signature
 Wm. S. Shropshire Assistant Gen. Mgr.
 Title
 December 1, 1977
 Date