

State Geological Survey  
**KANSAS DRILLERS LOG**  
 WICHITA BRANCH

**IMPORTANT**  
 Kans. Geo. Survey request  
 samples on this well.

S. 30 T. 21 R. 17<sup>XB</sup><sub>W</sub>  
 Loc. C E 1/2 NE  
 County Pawnee

API No. 15 — 145 — 20,292  
 County Number

Operator  
Beren Corporation

Address 1130 Vickers KSB&T Building  
Wichita, Kansas 67202

Well No. #1 Lease Name Gore

Footage Location  
 feet from (N) (S) line feet from (E) (W) line

Principal Contractor Sage Drilling Co. Geologist Don W Beauchamp

Spud Date May 22, 1973 Total Depth 2047 P.B.T.D.

Date Completed May 24, 1973 Oil Purchaser

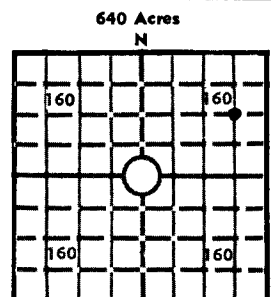

Locate well correctly  
 Elev.: Gr. 2072  
 DF. 2074 KB 2077

**CASING RECORD**

Report of all strings set — surface, intermediate, production, etc.

Purpose of string	Size hole drilled	Size casing set (in O.D.)	Weight lbs/ft.	Setting depth	Type cement	Sacks	Type and percent additives
Surface	12 1/2"	8 5/8	28	276'	60/40 Poz	225	3% C.C. 2% Gel.
Production		4 1/2	9	2046'	60/40 Poz.	75	3% C.C. 2% Gel.

**LINER RECORD**

**PERFORATION RECORD**

Top, ft.	Bottom, ft.	Sacks cement	Shots per ft.	Size & type	Depth interval

Size	Setting depth	Packer set at
2"	2019	

**ACID, FRACTURE, SHOT, CEMENT SQUEEZE RECORD**

Amount and kind of material used	Depth interval treated
3250 gal. acid & 30,000#sd. & 30,000 gal. jelled KCL water with 6000 gal. alcohol	2046 - 60 (open hole)

**INITIAL PRODUCTION**

Date of first production <u>Shut-in gas well</u>	Producing method (flowing, pumping, gas lift, etc.)			
<b>RATE OF PRODUCTION PER 24 HOURS</b>	Oil bbls.	Gas MCF	Water bbls.	Gas-oil ratio CFPB
Disposition of gas (vented, used on lease or sold) <u>shut-in, waiting on market</u>			Producing interval (s) <u>2046 - 60</u>	

INSTRUCTIONS: As provided in KCC Rule 82-2-125, within 90 days after completion of a well, one completed copy of this Drillers Log shall be transmitted to the State Geological Survey of Kansas, 4150 Monroe Street, Wichita, Kansas 67209. Copies of this form are available from the Conservation Division, State Corporation Commission, 3830 So. Meridian (P.O. Box 17027), Wichita, Kansas 66217. Phone AC 316-522-2206. If confidential custody is desired, please note Rule 82-2-125. Drillers Logs will be on open file in the Oil and Gas Division, State Geological Survey of Kansas, Lawrence, Kansas 66044.

31121

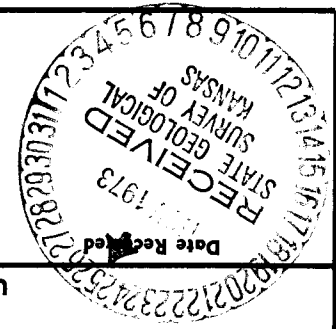

Date: November 16, 1973

Title: Don W. Beauchamp - Geologist

Signature: *Don W. Beauchamp*

USE ADDITIONAL SHEETS, IF NECESSARY, TO COMPLETE WELL RECORD.

SEE ATTACHED			
1086 - 1111	B. Wellington	Stone Corral	Herington
2024			
2040			

Operator	Beren Corporation	Well No.	1
Lease Name	Gore	S 30 T 21 R 17 W	XR
<p><b>WELL LOG</b></p> <p>Show all important zones of porosity and contents thereof; cored intervals, and all drill-stem tests, including depth interval tested, cushion used, time tool open, flowing and shut-in pressures, and recoveries.</p>			
DESIGNATE TYPE OF COMP.: OIL, GAS, DRY HOLE, SWDW, ETC.:	Gas	FORMATION DESCRIPTION, CONTENTS, ETC.	TOP
			BOTTOM
		NAME	DEPTH

KANSAS GEOLOGICAL SOCIETY  
508 East Murdock  
Wichita, Kansas

30-21-17W  
C E 1/2 NE

DRILLERS LOG

30-21-17W  
\*

GORE NO. 1

API # 15-145-20292

CASING RECORD:

OPERATOR: Beren Corporation

DESCRIPTION:

8-5/8" @ 276'  
w/225 sax cement

CONTRACTOR: Sage Drilling Co.

C E 1/2 NE  
Sec. 30-21S-17W  
Pawnee County,  
Kansas.

TOTAL DEPTH:  
2047'

COMMENCED: May 22, 1973

COMPLETED: May 24, 1973

Elev.

<u>FORMATION</u>	<u>FROM</u>	<u>TO</u>	<u>REMARKS</u>
Sand & Shale	0	280	
Shale & Sand	280	1086	
Anhydrite	1086	1111	
Shale	1111	1250	
Shale & Lime	1250	1642	
Shale	1642	1915	
Shale & Lime	1915	2015	
Lime & Shale	2015	2047	4 1/2" @ 2015 w/75 sax cement

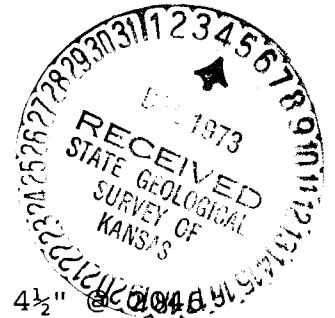

I certify that this is a true and correct copy of the above log to the best of my knowledge.

SAGE DRILLING CO., INC.

By Clarence Michael  
Clarence Michael



Subscribed and sworn to before me this 29th day of May, 1973.

Louise K. Whitted  
Louise K. Whitted, Notary Public

My commission expires:  
November 26, 1974.

tops  
td 2050