

WELL COMPLETION REPORT AND DRILLER'S LOG

KANSAS
State Geological Survey
WICHITA BRANCH

API No. 15 — 145 — 20760
County Number

Operator
Benson Mineral Group, Inc.

Address
1726 Champa St., Suite 600, Denver, CO 80202

Well No. 1-20 Lease Name Hammeke B

Footage Location
1320 feet from (N) (S) line 1320 feet from (E) (W) line

Principal Contractor Geologist

Spud Date 11-24-80 Date Completed 12-24-80 Total Depth 2335' P.B.T.D. 2326'

Directional Deviation None Oil and/or Gas Purchaser

S. 20 T. 21 R. 19 E- W

Loc. C SW

County Pawnee

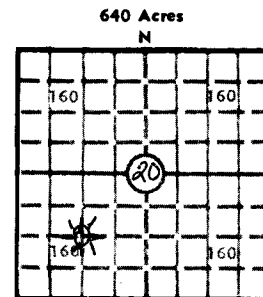

Elev.: Gr. 2080'

DF KB

CASING RECORD

Report of all strings set — surface, intermediate, production, etc.

Purpose of string	Size hole drilled	Size casing set (in O.D.)	Weight lbs/ft.	Setting depth	Type cement	Sacks	Type and percent additives
Surface	9 3/4"	7"		950'	60-40 POZ	300	2% gel 3% CaCl
Production	6 1/4"	4 1/2"		2340'	lite 50-50 POZ	100 80	10% salt

LINER RECORD

PERFORATION RECORD

Top, ft.	Bottom, ft.	Sacks cement	Shots per ft.	Size & type	Depth interval
			1 SPF		2156-68
					2172-79
					2215-28
					2237-42
					2286-2302

TUBING RECORD

Size	Setting depth	Packer set at			

ACID, FRACTURE, SHOT, CEMENT SQUEEZE RECORD

Amount and kind of material used	Depth interval treated
Foam frac x 80 quality foam, 40,000# 20-40 sn 1500 gal 15% HCl.	2156-2242
Pmp 750 gal 15% HCl x 2000 gal pad, 5000 gal 1/2 PPG, 5500 gal 1 PPG, 8000 gal 1 1/2 PPG, 5500 gal 1 PPG, 8000 gal 1 1/2 PPG.	
Flush 1000 gal x 30 MCF Nitrogen.	

INITIAL PRODUCTION

Date of first production SIGW	Producing method (flowing, pumping, gas lift, etc.)
RATE OF PRODUCTION PER 24 HOURS	Oil Gas Water Gas-oil ratio
	bbls. MCF bbls. CFPB
Disposition of gas (vented, used on lease or sold)	Producing interval (s)

INSTRUCTIONS: As provided in KCC Rule 82-2-125, within 90 days after completion of a well, one completed copy of this Drillers Log shall be transmitted to the State Geological Survey of Kansas, 4150 Monroe Street, Wichita, Kansas 67209. Copies of this form are available from the Conservation Division, State Corporation Commission, 245 No. Water, Wichita, Kansas 67202. Phone AC 316-522-2206. If confidential custody is desired, please note Rule 82-2-125. Drillers Logs will be on open file in the Oil and Gas Division, State Geological Survey of Kansas, Lawrence, Kansas 66044.

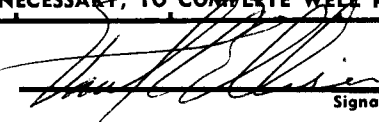
Operator Benson Mineral Group, Inc.		DESIGNATE TYPE OF COMP.: OIL, GAS, DRY HOLE, SWDW, ETC.:		
Well No. 1-20	Lease Name Hammeke B			
S <u>20</u> T <u>21</u> R <u>19</u> E W				
WELL LOG			SHOW GEOLOGICAL MARKERS, LOGS RUN, OR OTHER DESCRIPTIVE INFORMATION.	
Show all important zones of porosity and contents thereof; cored intervals, and all drill-stem tests, including depth interval tested, cushion used, time tool open, flowing and shut-in pressures, and recoveries.				
FORMATION DESCRIPTION, CONTENTS, ETC.	TOP	BOTTOM	NAME	DEPTH
Sand and Gravel	0	842		
Shale	842	926		
Lime and Shale	926	977		
Shale	977	1600		
Lime and Shale	1600	2335		
USE ADDITIONAL SHEETS, IF NECESSARY, TO COMPLETE WELL RECORD.				
Date Received	<div style="text-align: center;">  Signature Paul C. Ellison, Vice President Title May 29, 1981 Date </div>			

201212