

KANSAS DRILLERS LOG

S. 27 T. 21S R. 2 W
Loc. N2 NE NE
County McPherson

API No. 15 — 113 — 20,572
County Number

Operator
John Jay Darrah, Jr.

Address
1010 Century Plaza Bldg. Wichita, Kansas 67202

Well No. #1 Lease Name
Moundridge Townsite (Schrag)

Footage Location
290' feet from (N) line 710' feet from (E) line

Principal Contractor Blackstone Drilling Geologist Walter Innes Phillips

Spud Date 8-9-78 Total Depth 3397' P.B.T.D. -----

Date Completed 8-18-78 Oil Purchaser

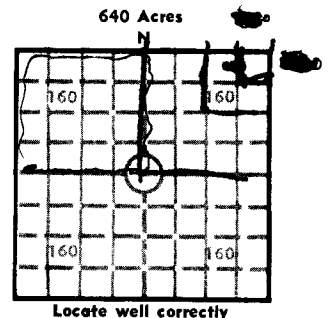

Elev.: Gr. 1486
1489 1491
DF ----- KB -----

CASING RECORD

Report of all strings set — surface, intermediate, production, etc.

Purpose of string	Size hole drilled	Size casing set (in O.D.)	Weight lbs/ft.	Setting depth	Type cement	Sacks	Type and percent additives
Surface		10-3/4		330'	common	100	

LINER RECORD

PERFORATION RECORD

Top, ft.	Bottom, ft.	Sacks cement	Shots per ft.	Size & type	Depth interval

TUBING RECORD

Size	Setting depth	Packer set at

ACID, FRACTURE, SHOT, CEMENT SQUEEZE RECORD

Amount and kind of material used	Depth interval treated

INITIAL PRODUCTION

Date of first production _____ Producing method (flowing, pumping, gas lift, etc.) _____

RATE OF PRODUCTION PER 24 HOURS
Oil _____ bbls. Gas _____ MCF Water _____ Gas-oil ratio _____ CFPB

Disposition of gas (vented, used on lease or sold) _____ Producing interval(s) _____

INSTRUCTIONS: As provided in KCC Rule 82-2-125, within 90 days after completion of a well, one completed copy of this Drillers Log shall be transmitted to the State Geological Survey of Kansas, 4150 Monroe Street, Wichita, Kansas 67209. Copies of this form are available from the Conservation Division, State Corporation Commission, 3830 So. Meridian (P.O. Box 17027), Wichita, Kansas 66217. Phone AC 316-522-2206. If confidential custody is desired, please note Rule 82-2-125. Drillers Logs will be on open file in the Oil and Gas Division, State Geological Survey of Kansas, Lawrence, Kansas 66044.

Operator John Jay Darrab, Jr.		DESIGNATE TYPE OF COMP.: OIL, GAS, DRY HOLE, SWDW, ETC.:
Well No. 1	Lease Name Moundridge Townsite	Dry Hole
S 27 T 21 R 2 ^{EX} _W		

WELL LOG

Show all important zones of porosity and contents thereof; cored intervals, and all drill-stem tests, including depth interval tested, cushion used, time tool open, flowing and shut-in pressures, and recoveries.

SHOW GEOLOGICAL MARKERS, LOGS RUN, OR OTHER DESCRIPTIVE INFORMATION.

FORMATION DESCRIPTION, CONTENTS, ETC.	TOP	BOTTOM	NAME	DEPTH
See attached report				

USE ADDITIONAL SHEETS, IF NECESSARY, TO COMPLETE WELL RECORD.

Date Received	Signature
	Title
	Date

27-21-2W

JOHN JAY DARRAH, JR.
PHONE 316-263-2243
SUITE 1010, CENTURY PLAZA BUILDING
WICHITA, KANSAS 67202

PROGRESS REPORT

MOUNDRIDGE TOWNSITE LEASE

N/2 NE/4 NE/4

Section 27-21-2W

McPherson County, Kansas

Elevation: KB 1491'
DF 1489'
GR 1486'

SAMPLE TOPS

8-8-78 Moved in, rigged up.

8-9-78 Finished rigging up. Drilled rat hole and Kelly down.

8-10-78 Set 330' 10-3/4" surface pipe. Cemented with 100 sx. Plugged down 11:00 a.m.

8-11-78 Drilling under surface (daylights only). Crews will probably start drilling all 3 towers Sunday.

8-14-78 Drilling at 2080' at 7:00 a.m.

8-15-78 Drilling at 2700' at 6:00 a.m.

8-16-78 Drilling at 3216' at 4 p.m.

8-17-78 Drilling @3376' @ 7:00a.m.. Found Hunton at 3378', poor porosity, fair show of oil. Ran Drill Stem Test #1-couldn't get to the bottom of the hole because of cuttings. Reconditioned hole, ran DST #2, 3378-3397. Open 30 minutes, very weak blow, died 1 minute. Flushed tool, no help, closed 30 minutes, came out of hole.

Lansing	2341	-850
Miss-Warsaw	3004	-1513
Osage	3044	-1553
Kindrhk	3306	-1815
Misener	3376	-1885
Hunton	3378	-1887
Maquoketa	3387	-1896
Rotary total depth	3397	-1906

IFP 31#-31#

IBHP 125#

TEMP 104°

Although we were structurally "perfect", the Hunton was tight and so we decided to plug and abandon the hole at 3397'.