

WELL COMPLETION REPORT AND DRILLER'S LOG

KANSAS
State Geological Survey
WICHITA BRANCH
JUN 8 0 RECD

API No. 15 — 083 — 20,721
County Number

S. 1 T. 21S R. 21 *
W

Loc. CNWSE

County HODGEMAN

Operator
Petro-GAS ENERGIES INC

Address
411 FARMERS & BANKERS BLDG WICHITA KS 67202

Well No. 1 Lease Name Steffen

Footage Location
feet from (N) (S) line CNWSE feet from (E) (W) line

Principal Contractor BLUE GOOSE DRLLG Geologist HARVEY GOUGH

Spud Date 5-20-80 Date Completed 5-29-80 Total Depth 4364 P.B.T.D.

Directional Deviation 1° Oil and/or Gas Purchaser NONE

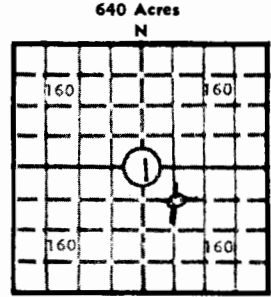

Elev.: Gr. 2163

DF 2165 KB 2168

CASING RECORD

Report of all strings set — surface, intermediate, production, etc.

Purpose of string	Size hole drilled	Size casing set (in O.D.)	Weight lbs/ft.	Setting depth	Type cement	Sacks	Type and percent additives
<u>Surface</u>	<u>12 1/4</u>	<u>8 5/8</u>	<u>24</u>	<u>312'</u>	<u>Common</u>	<u>225</u>	<u>3% cc</u> <u>2% gel</u>

LINER RECORD

PERFORATION RECORD

Top, ft.	Bottom, ft.	Sacks cement	Shots per ft.	Size & type	Depth interval

TUBING RECORD

Size	Setting depth	Packer set at

ACID, FRACTURE, SHOT, CEMENT SQUEEZE RECORD

Amount and kind of material used	Depth interval treated

INITIAL PRODUCTION

Date of first production <u>DEA</u>	Producing method (flowing, pumping, gas lift, etc.)
RATE OF PRODUCTION PER 24 HOURS	Oil bbls. Gas MCF Water bbls. Gas-oil ratio CFPB
Disposition of gas (vented, used on lease or sold)	Producing interval(s)

INSTRUCTIONS: As provided in KCC Rule 82-2-125, within 90 days after completion of a well, one completed copy of this Drillers Log shall be transmitted to the State Geological Survey of Kansas, 4150 Monroe Street, Wichita, Kansas 67209. Copies of this form are available from the Conservation Division, State Corporation Commission, 245 No. Water, Wichita, Kansas 67202. Phone AC 316-522-2206. If confidential custody is desired, please note Rule 82-2-125. Drillers Logs will be on open file in the Oil and Gas Division, State Geological Survey of Kansas, Lawrence, Kansas 66044.

Operator

Petro-Gas Energies Inc

DESIGNATE TYPE OF COMP.: OIL, GAS, DRY HOLE, SWDW, ETC.:

DEA

Well No.

1

Lease Name

Steffen

S 1 T 21 S R 21 E W

WELL LOG

Show all important zones of porosity and contents thereof; cored intervals, and all drill-stem tests, including depth interval tested, cushion used, time tool open, flowing and shut-in pressures, and recoveries.

SHOW GEOLOGICAL MARKERS, LOGS RUN, OR OTHER DESCRIPTIVE INFORMATION.

FORMATION DESCRIPTION, CONTENTS, ETC.	TOP	BOTTOM	NAME	DEPTH

USE ADDITIONAL SHEETS, IF NECESSARY, TO COMPLETE WELL RECORD.

Date Received

Harvey Gough

Signature

Geologist

Title

6-12-1980

Date

1-21-21W

WELL LOG

Steffen #1
C NW SE Sec. 1-21S-21W
Hodgeman Co., KS

Name of Operator: Petro-Gas Energies, Inc.
411 Farmers and Bankers Building
200 East First Street
Wichita, KS 67202

Date Completed: 5-29-80

<u>FROM</u>	<u>TO</u>	
0	5	Cellar
5	321	Clay, Rock and Shale
321	1120	Shale
1120	1330	Red Bed
1330	1357	Anhydrite
1357	1675	Red Bed and Shale
1675	1895	Shale
1895	3650	Shale and Lime
3650	4363	Lime
4363		Total Depth

STATE OF KANSAS

COUNTY OF BARTON ss

George E. Miller, Jr., President of Blue Goose Drilling Co., Inc.,
being first duly sworn on oath says: That I have knowledge of the facts,
statements and matters herein contained and the log of the above described
well as filed and that the same are true and correct.

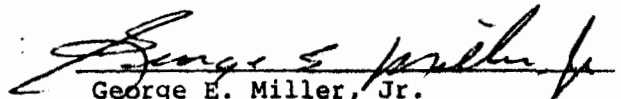
George E. Miller, Jr.

Subscribed and sworn before me this 2nd day of June, 1980.

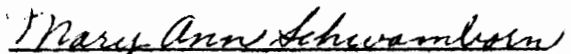
Notary Public

My commission expires 8-1-81.

