

7-18

P2



State Geological Survey WICHITA BRANCH

KANSAS DRILLERS LOG

S. 18 T. 21S R. 22 ~~EX~~ W

API No. 15 _____
County _____ Number _____

Loc. 1600 FNL & 1015 FWL
County Hodgeman

Operator
Coastal Oil & Gas Corporation

Address
P.O. Box 1332 Amarillo, TX 79189

Well No. 2 Lease Name Wieland

Footage Location
1600 feet from (N) ~~(S)~~ line 1015 feet from (E) ~~(W)~~ line

Principal Contractor Lynx Drilling Co. Geologist _____

Spud Date 7-25-81 SWDW Total Depth 1150 P.B.T.D. 1070

Date Completed 7-27-81 Oil Purchaser NA

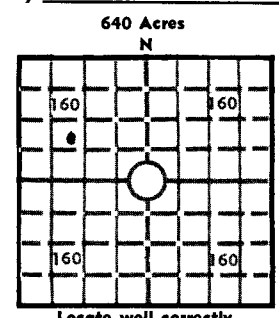

Elev.: Gr. 2280 est.
DF _____ KB _____

CASING RECORD

Report of all strings set — surface, intermediate, production, etc.

Purpose of string	Size hole drilled	Size casing set (in O.D.)	Weight lbs/ft.	Setting depth	Type cement	Sacks	Type and percent additives
surface	12 1/2	8 5/8	24#	367	Class A	360	3% CaCl2
production	7 7/8	5 1/2	15.5#	1109	HLC	135	
					Class A	100	

LINER RECORD

PERFORATION RECORD

Top, ft.	Bottom, ft.	Sacks cement	Shots per ft.	Size & type	Depth interval
			2		924-1060

TUBING RECORD

Size	Setting depth	Packer set at

ACID, FRACTURE, SHOT, CEMENT SQUEEZE RECORD

Amount and kind of material used	Depth interval treated
N/A	

INITIAL PRODUCTION

Date of first production N/A Producing method (flowing, pumping, gas lift, etc.)

RATE OF PRODUCTION PER 24 HOURS	Oil	Gas	Water	Gas-oil ratio
	bbls.	MCF	bbls.	CFPB

Disposition of gas (vented, used on lease or sold) _____ Producing interval(s) _____

INSTRUCTIONS: As provided in KCC Rule 82-2-125, within 90 days after completion of a well, one completed copy of this Drillers Log shall be transmitted to the State Geological Survey of Kansas, 4150 Monroe Street, Wichita, Kansas 67209. Copies of this form are available from the Conservation Division, State Corporation Commission, 3830 So. Meridian (P.O. Box 17027), Wichita, Kansas 66217. Phone AC 316-522-2206. If confidential custody is desired, please note Rule 82-2-125. Drillers Logs will be on open file in the Oil and Gas Division, State Geological Survey of Kansas, Lawrence, Kansas 66044.

Operator Coastal Oil & Gas Corporation

DESIGNATE TYPE OF COMP.: OIL, GAS, DRY HOLE, SWDW, ETC.:
SWDW

Well No.

2

Lease Name

Wieland

S 18 T21S R 22 ~~EX~~
W

WELL LOG

Show all important zones of porosity and contents thereof; cored intervals, and all drill-stem tests, including depth interval tested, cushion used, time tool open, flowing and shut-in pressures, and recoveries.

SHOW GEOLOGICAL MARKERS, LOGS RUN, OR OTHER DESCRIPTIVE INFORMATION.

FORMATION DESCRIPTION, CONTENTS, ETC.	TOP	BOTTOM	NAME	DEPTH
Cedar Hill	900	1150		

USE ADDITIONAL SHEETS, IF NECESSARY, TO COMPLETE WELL RECORD.

Date Received

Bobby A. Smith
Signature

Petroleum Engineer

Title

August 3, 1981

Date