

19-21-23W

API # 15-083-20,291

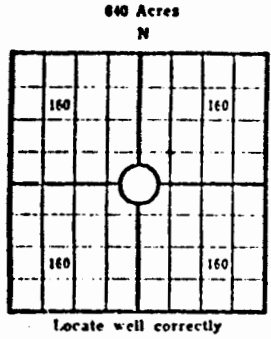

Lease Name: Whipple "B" Well No. 1  
 Well Located: 150' N SE SW  
Hodgeman SEC 19 TWP 21S RGE 23W  
 Operator: Pickrell Drilling Company  
 Address: 705 Fourth National Bank Bldg., Wichita, Kansas  
 Elevation: Ground 2391' D.F. 2394' K.B. 2396'  
 Type Well: (Oil, gas, dry hole) Dry Hole

Drilling Commenced: 3/15 1973 Drilling Completed: 3/24/ 19 73  
 Well Completed: 19 Total Depth 4617'  
 Initial Production: \_\_\_\_\_

Casing Record

Size: 8-5/8" Set at 239' Size: \_\_\_\_\_ Set at \_\_\_\_\_  
 Size: \_\_\_\_\_ Set at \_\_\_\_\_ Size: \_\_\_\_\_ Set at \_\_\_\_\_

Liner Record

Size: \_\_\_\_\_ Set from \_\_\_\_\_ To \_\_\_\_\_

Cementing

<u>Casing Size</u>	<u>Sacks</u>	<u>Type Cement and Additives</u>
<u>8-5/8"</u>	<u>150</u>	<u>3/2</u>
_____	_____	_____
_____	_____	_____

Perforations

<u>Formation</u>	<u>Perforated Interval and Number Shots</u>
_____	_____
_____	_____
_____	_____

Electric Log Run (Show type log and depths covered)

No log run.

(Fill in formation and related information on reverse side)

19-21-23w

FORMATION, TESTING AND COMPLETION RECORD

Show Drill Stem Tests,  
Well Stimulation and  
Production Tests

Formation	Top	Bottom
Clay-Rock Post-Clay	0	150
Sand-Clay	150	240
Shale	240	385
Shale & Sand Streaks	385	800
Shale - Sand	800	1013
Red beds	1013	1050
Blatt	1050	1102
Red Beds - Shale	1102	1320
Sand	1320	1450
Shale - Red Beds	1450	1633
Red - Shale	1633	1672
Anhydrite	1672	1870
Shale - Red Bed Br.Lm.	1870	2280
Shale & Lime	2280	2390
Lime	2390	2565
Shale - Lime	2565	3240
Lim	3240	3420
Lim - Shale	3420	3729
Shale - Lime	3729	3885
Sandy Shale	3885	3980
Shale - Lime	3980	4500
Lime	4500	4550
Lime-Chert-Shale	4550	4605
Lime & Chert	4605	4617
Miss., RTD		

DST # 1 4355-4395: Open 150 minutes, fair blow,  
rec. 30' muddy water w/a scum of oil, 870' water.  
FP's 33#-419#, ISIP 1452#/30", FSIP 1421#/60".  
DST # 2 4602-4617: Open 150", weak steady blow,  
rec. 360' muddy water. FP's 37# to 163#, ISIP 1176#/30'  
FSIP 1077#/60".



**ROTARY DRILLING LOG**

19-21-23W  
150' N, SE SW  
**19-21-23W**  
3/15/73

APR 19 1973  
**COMPANY:** Pickrell Drilling Company  
705 Fourth National Bank Building  
Wichita, Kansas 67202

Rotary Drilling Commenced 3/15/73  
Rotary Drilling Completed 4/2/73

**LOCATION:** Whipple "B" No. 1, 150' N SE SW Sec. 19-21S-23W  
Hodgeman County, Kansas

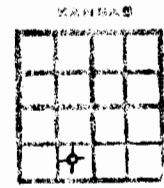

**CONTRACTOR:** PICKRELL DRILLING COMPANY  
Wichita, Kansas

**CASING RECORD:** Run 6 Jts. 8-5/8" surface casing set @ 239' KB. Cemented with 150 sacks. Completed 9:30 P.M. Circulated.  
No oil string run, D & A, Plugged down 11:00 A.M. April 2, 1973.

**LOG**

(Figures indicate bottom of formation — measurements from top of rotary bushing.)

150	Clay, Rock Post, Clay, Sand-Clay	<u>C.F.S.</u>
240	Shale	4385
385	Shale & Sand Streaks	4395
800	Shale - Sand	4525
1013	Red Beds	4585
1050	Blain	4605
1102	Red Beds - Shale	4610
1320	Sand	4617
1450	Shale - Red Beds	
1633	Red Bed - Shale	
1672	Anhydrite	
1870	Shale - Red Bed - Brown Lime	
2280	Shale & Lime	
2390	Lime	
2565	Shale - Lime	
3240	Lime	<u>Slope Tests</u>
3420	Lime - Shale	2000
3729	Shale & Lime	2500
3885	Sandy Shale	3000
3980	Shale - Lime	3500
4500	Lime	4000
4550	Lime - Chert - Shale	4500
4605	Lime - Chert	4600
4617	Mississippi, RTD	

	Smp Tops	Depth	
	Sc	1633	
	Heeb	3900	
her	Lans	3949	NY,
the	Kc	4138	ling
	Stark	4212	
	Bkc	4311	
	Marm	4339	
ST.	Pawn	4429	
CO	Ft Sc	4493	
	Cher	4518	
	Chty Cong	4558	
	Miss Lm	4587	l for
the	Miss Dol	4605	m to
Att	Rtd	4617	s its
and			free

My commission expires: August 19, 1975

*Helen L. Martin*  
Helen L. Martin Notary Public