

33-21-23W

KANSAS DRILLERS LOG

State Geological Survey
WICHITA, BRANCH

S. 33 T. 21S R. 23 W
Loc. C. SW NE
County Hodgeman

API No. 15 - 083 - 20,276
County Number

Operator
Petroleum, Inc.

Address
300 West Douglas, Wichita, Kansas 67202

Well No. 1 Lease Name EWY 'D'

Footage Location
1980 feet from (N) line 1980 feet from (E) line

Principal Contractor Geologist
Garvey Drilling Company Robert G. Brooks

Spud Date Total Depth P.B.T.D.
December 13, 1972 RFD 4587

Date Completed Oil Purchaser
December 24, 1972

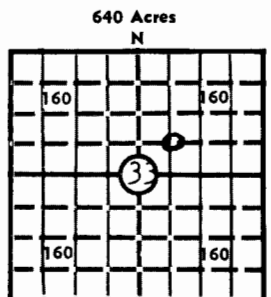

Elev.: Gr. 2319'
DF 2322' KB 2324'

CASING RECORD

Report of all strings set — surface, intermediate, production, etc.

Purpose of string	Size hole drilled	Size casing set (in O.D.)	Weight lbs/ft.	Setting depth	Type cement	Sacks	Type and percent additives
Surface	12-1/4"	8-5/8	20#	636'	Common	325	2% Gel, 3% CC

LINER RECORD

PERFORATION RECORD

Top, ft.	Bottom, ft.	Sacks cement	Shots per ft.	Size & type	Depth interval

Size	Setting depth	Packer set at

ACID, FRACTURE, SHOT, CEMENT SQUEEZE RECORD

Amount and kind of material used	Depth interval treated

INITIAL PRODUCTION

Date of first production	Producing method (flowing, pumping, gas lift, etc.)
RATE OF PRODUCTION PER 24 HOURS	Oil bbls. Gas MCF Water bbls. Gas-oil ratio CFPB
Disposition of gas (vented, used on lease or sold)	Producing interval (s)

INSTRUCTIONS: As provided in KCC Rule 82-2-125, within 90 days after completion of a well, one completed copy of this Drillers Log shall be transmitted to the State Geological Survey of Kansas, 4150 Monroe Street, Wichita, Kansas 67209. Copies of this form are available from the Conservation Division, State Corporation Commission, 3830 So. Meridian (P.O. Box 17027), Wichita, Kansas 66217. Phone AC 316-522-2206. If confidential custody is desired, please note Rule 82-2-125. Drillers Logs will be on open file in the Oil and Gas Division, State Geological Survey of Kansas, Lawrence, Kansas 66044.

Operator
Petroleum, Inc.

DESIGNATE TYPE OF COMP.: OIL, GAS,
DRY HOLE, SWDW, ETC.:

Well No. 1 Lease Name EWY 'D'

Dry Hole

S 33 T 21S R 23 W C. SW NE

WELL LOG

Show all important zones of porosity and contents thereof; cored intervals, and all drill-stem tests, including depth interval tested, cushion used, time tool open, flowing and shut-in pressures, and recoveries.

SHOW GEOLOGICAL MARKERS, LOGS RUN,
OR OTHER DESCRIPTIVE INFORMATION.

FORMATION DESCRIPTION, CONTENTS, ETC.	TOP	BOTTOM	NAME	DEPTH
DST #1: 4547-82: Misrun			Dresser Atlas Gamma Ray- Neutron-Laterolog	
DST #2: 4575-87: Misrun				
DST #3: 4575-87: Packer Failure				
DST #4: 4502-87: 30-30-30-30; Strong Blow; recovered 1025' very slightly oil cut muddy salt water; 1FP 104#-375# 1BHP 1431#, 2FP 375#-552#, 2EHP 1431#			E.L. TOPS: Anhydrite Heebner Lansing BKC Fort Scott Mississippi ELTD RTD	1562 3864 3921 4297 4462 4570 4583 4587
30' Surface Soil & Clay				
318' Shale & Post Rock				
480' Sand				
670' Shale				
793' Red Bed				
1022' Shale				
1225' Sand				
1520' Shale				
1597' Anhydrite				
1975' Shale & Lime				
2530' Lime & Shale				
3967' Lime				
4075' Lime & Shale				
4180' Lime				
4582' Lime & Chert				
4587' Lime & Cherty Lime				
4587' RTD				

USE ADDITIONAL SHEETS, IF NECESSARY, TO COMPLETE WELL RECORD.

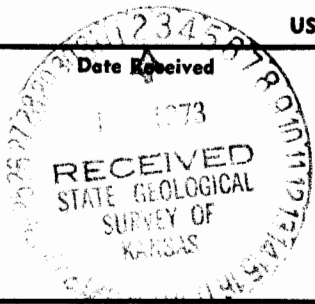

Jay C. McNeil
 Jay C. McNeil Signature
 District Geologist Title
 January 10, 1973 Date