

15-083-20542

State Geological Survey

WICHITA BRANCH
KANSAS DRILLERS LOG

IMPORTANT
Kans. Geo. Survey request
samples on this well.

API No. 15 — 083 — 20,542
County Number

S. 1 T. 21 R. 24 ^KW
Loc. C SW NE
County Hodgeman

Operator
Strata Drilling Company

Address
Box 355 Great Bend, Kansas 67530

Well No. #1 Lease Name Ficken

Footage Location
feet from (N) (S) line _____ feet from (E) (W) line _____

Principal Contractor Strata Drilling Company Geologist Harold Steincamp

Spud Date July 6, 1977 Total Depth 4377' P.B.T.D. _____

Date Completed July 14, 1977 Oil Purchaser _____

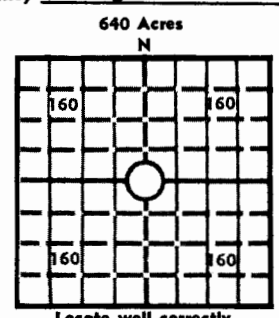

Locate well correctly
Elev.: Gr. 2250
DF _____ KB _____

CASING RECORD

Report of all strings set — surface, intermediate, production, etc.

Purpose of string	Size hole drilled	Size casing set (in O.D.)	Weight lbs/ft.	Setting depth	Type cement	Sacks	Type and percent additives
surface	12½"	8-5/8"		294'	common	185	2% gel, 3% C.C.
production	7-7/8"	4½"	10.5#	4372'	60-40 pozmix	200	18% salt

LINER RECORD

PERFORATION RECORD

Top, ft.	Bottom, ft.	Sacks cement	Shots per ft.	Size & type	Depth interval

TUBING RECORD

Size	Setting depth	Packer set at
2"	4371'	none

ACID, FRACTURE, SHOT, CEMENT SQUEEZE RECORD

Amount and kind of material used	Depth interval treated
300 gal. MOD 202	4372-4379'
1000 gal. MOD 202	4372-4379'

INITIAL PRODUCTION

Date of first production 8-15-77 Producing method (flowing, pumping, gas lift, etc.) pumping

RATE OF PRODUCTION PER 24 HOURS	Oil	Gas	Water	Gas-oil ratio
	<u>51</u> bbls.	<u>none</u> MCF	<u>none</u> bbls.	<u>CFPB</u>

Disposition of gas (vented, used on lease or sold) _____ Producing interval (s) 4372'-4381'

INSTRUCTIONS: As provided in KCC Rule 82-2-125, within 90 days after completion of a well, one completed copy of this Drillers Log shall be transmitted to the State Geological Survey of Kansas, 4150 Monroe Street, Wichita, Kansas 67209. Copies of this form are available from the Conservation Division, State Corporation Commission, 3830 So. Meridian (P.O. Box 17027), Wichita, Kansas 66217. Phone AC 316-522-2206. If confidential custody is desired, please note Rule 82-2-125. Drillers Logs will be on open file in the Oil and Gas Division, State Geological Survey of Kansas, Lawrence, Kansas 66044.

Operator **Strata Drilling Company** DESIGNATE TYPE OF COMP.: OIL, GAS,
DRY HOLE, SWDW, ETC.:
oil

Well No. **1** Lease Name **Ficken**

S 1 T 21S R 24 E W

WELL LOG

Show all important zones of porosity and contents thereof; cored intervals, and all drill-stem tests, including depth interval tested, cushion used, time tool open, flowing and shut-in pressures, and recoveries.

SHOW GEOLOGICAL MARKERS, LOGS RUN,
OR OTHER DESCRIPTIVE INFORMATION.

FORMATION DESCRIPTION, CONTENTS, ETC.	TOP	BOTTOM	NAME	DEPTH
Anhydrite	1466-1502'	+789 KB		
Heebner	3685'	-1849		
Base Kansas City	4104'	-1849		
Marmaton	4114'	-1859		
Pawnee	4192'	-1937		
Fort Scott	4255'	-2000		
Mississippi Lime	4356'	-2106		
Mississippi Dolomite	4365'	-2115		
<p>DST #1 @ 4245-80</p> <p>15-45-60-45 Good Blow</p> <p>Rec. 20' slightly oil cut mud</p> <p>180' slightly gas cut and heavy oil cut mud</p> <p>90' watery oil cut mud</p> <p>320' slightly oil, gas cut water</p> <p>1385-1316</p> <p>72-108 144-325</p> <p>DST #2 @ 4369-4377</p> <p>15-45-60-45 Good Blow</p> <p>Rec. 280' mud cut oil 90%</p> <p>1177 900 72-84 96-120</p>				

USE ADDITIONAL SHEETS, IF NECESSARY, TO COMPLETE WELL RECORD.

Date Received	<div style="border-bottom: 1px solid black; margin-bottom: 5px; text-align: right;">Signature</div> <div style="border-bottom: 1px solid black; margin-bottom: 5px; text-align: right;">Title</div> <div style="border-bottom: 1px solid black; text-align: right;">Date</div>
---------------	--