

KANSAS DRILLERS LOG

API No. 15 — 083 — 20,526  
County Number

S. 34 T. 21 R. 24 <sup>N</sup>/<sub>W</sub>  
 Loc. 660' FNL & 660' FWL  
 County Hodgeman

Operator  
Continental Oil Company

Address  
3535 NW 58th Street Oklahoma City, Oklahoma

Well No. #3 Lease Name Smith

Footage Location  
660 feet from (N) (S) line 660 feet from (E) (W) line

Principal Contractor Rains & Williamson Oil Co. Geologist Robert D. Dougherty

Spud Date 4-7-77 Total Depth 4710' P.B.T.D. 4678'

Date Completed 4-17-77 Oil Purchaser \_\_\_\_\_

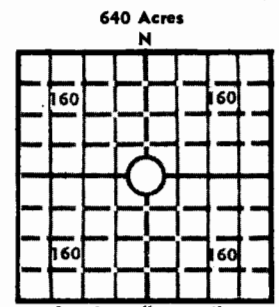

Locate well correctly  
 Elev.: Gr. 2400'  
 DF \_\_\_\_\_ KB 2410'

CASING RECORD

Report of all strings set — surface, intermediate, production, etc.

Purpose of string	Size hole drilled	Size casing set (in O.D.)	Weight lbs/ft.	Setting depth	Type cement	Sacks	Type and percent additives
Surface	12 1/4	8 5/8	24	605'	Common Class H	250 150	4% gel, 3% CaCl 2% CaCl
Production	7 7/8	5 1/2	14	4709'	Lite Wate Class H	150 150	None 10% salt, CFR-2
				Top Stage	Lite Wate	340	No

LINER RECORD

PERFORATION RECORD

Top, ft.	Bottom, ft.	Sacks cement	Shots per ft.	Size & type	Depth interval
	None				
			4	jet	4628-31'
			4	jet	4634-39'

ACID, FRACTURE, SHOT, CEMENT SQUEEZE RECORD

Amount and kind of material used	Depth interval treated
250 gals. 15% HCl	4628-39'
750 gals. 15% HCl	4628-39'
6,000 gals. SW pad followed w/5,000 gals. 28% acid	4628-39'

INITIAL PRODUCTION

Dry Hole

Date of first production \_\_\_\_\_ Producing method (flowing, pumping, gas lift, etc.) \_\_\_\_\_

RATE OF PRODUCTION PER 24 HOURS	Oil	Gas	Water	Gas-oil ratio
	bbls.	MCF	bbls.	CFPB

Disposition of gas (vented, used on lease or sold) \_\_\_\_\_ Producing interval (s) \_\_\_\_\_

INSTRUCTIONS: As provided in KCC Rule 82-2-125, within 90 days after completion of a well, one completed copy of this Drillers Log shall be transmitted to the State Geological Survey of Kansas, 4150 Monroe Street, Wichita, Kansas 67209. Copies of this form are available from the Conservation Division, State Corporation Commission, 3830 So. Meridian (P.O. Box 17027), Wichita, Kansas 66217. Phone AC 316-522-2206. If confidential custody is desired, please note Rule 82-2-125. Drillers Logs will be on open file in the Oil and Gas Division, State Geological Survey of Kansas, Lawrence, Kansas 66044.

Operator Continental Oil Company DESIGNATE TYPE OF COMP.: OIL, GAS, DRY HOLE, SWDW, ETC.:

Well No. 3 Lease Name Smith Dry Hole

S 31 T 21 S R 24 ~~W~~

**WELL LOG**  
 Show all important zones of porosity and contents thereof; cored intervals, and all drill-stem tests, including depth interval tested, cushion used, time tool open, flowing and shut-in pressures, and recoveries. SHOW GEOLOGICAL MARKERS, LOGS RUN, OR OTHER DESCRIPTIVE INFORMATION.

FORMATION DESCRIPTION, CONTENTS, ETC.	TOP	BOTTOM	NAME	DEPTH
No cores or drill stem tests taken.			Toronto Lansing KC Marmaton Fort Scott Miss. Dolo.	3951' 3988' 4452' 4561' 4626'

USE ADDITIONAL SHEETS, IF NECESSARY, TO COMPLETE WELL RECORD.

Date Received

*J. S. Cary*  
 Signature  
 Administrative Supervisor  
 Title  
 May 12, 1977  
 Date

DRILLER'S LOG

COMPANY: Continental Oil Company

SEC. 34 T. 21S R. 24W

WELL NAME: Smith No. 3

LOC. 660' FNL & 660' FWL

COUNTY: Hodgeman

RIG NO. #2

TOTAL DEPTH 4710'

ELEVATION

COMMENCED: 4-7-77

COMPLETED: 4-17-77

CONTRACTOR: Rains & Williamson Oil Co., Inc.

CASING RECORD:

SURFACE: 8 5/8" @ 617' w/250 sx. common, 4% gel, 3% cc. and 150 sx. common, 3% cc.

PRODUCTION: 5 1/2" @ 4709' w/150 sx. HOWECO, 150 sx. common, 10% salt, 5# gilsonite per sack and 3/4% CFR2

LOG

(Figures Indicate Bottom of Formations)

Sand & Clay	75
Shale	1138
Sand	1215
Shale	3478
Shale & Lime	4115
Shale	4240
Shale & Lime	4710
<u>ROTARY TOTAL DEPTH</u>	<u>4710</u>

STATE OF Kansas )

COUNTY OF Sedgwick )

SS:

I, Wilson Rains, President of Rains & Williamson Oil Co., Inc.

*Sub*

STATE CORPORATION COMMISSION OF KANSAS  
OIL & GAS CONSERVATION DIVISION  
WELL COMPLETION OR RECOMPLETION FORM  
ACO-1 WELL HISTORY  
DESCRIPTION OF WELL AND LEASE

Operator: License # 5916  
Name Conoco Inc.  
Address 3817 N.W. Expressway  
City/State/Zip Oklahoma City, OK 73112

Purchaser  
Operator Contact Person Glen Hughes  
Phone (316) 793-7871

Contractor: License #  
Name  
Wellsite Geologist  
Phone

Designate Type of Completion  
New Well Re-Entry Workover  
Oil Gas Dry  
SWD Inj Other (Core, Water Supply etc.)  
Temp Abd Delayed Comp.  
If **OWNO**: old well info as follows:  
Operator  
Well Name  
Comp. Date  
Old Total Depth

WELL HISTORY

Drilling Method:  
Mud Rotary Air Rotary Cable  
4-7-77 4-17-77 10-12-88  
Spud Date Date Reached TD Completion Date  
4710 4678'  
Total Depth PBTD

Amount of Surface Pipe Set and Cemented at.....feet  
Multiple Stage Cementing Collar Used? Yes No  
If yes, show depth set.....feet  
If alternate 2 completion, cement circulated from.....feet depth to.....w/.....SX cmt  
Cement Company Name  
Invoice #

API NO. 15-083-20526  
County Hodgeman  
C NW NW 34 21S 24 East  
..... Sec..... Twp.....Rge..... X West

4620 Ft North from Southeast Corner of Section  
4620 Ft West from Southeast Corner of Section  
(Note: Locate well in section plat below)

Lease Name Smith Well # 3  
Field Name Bindley  
Producing Formation Mississippi  
Elevation: Ground 2400' KB 2410'

Section Plat

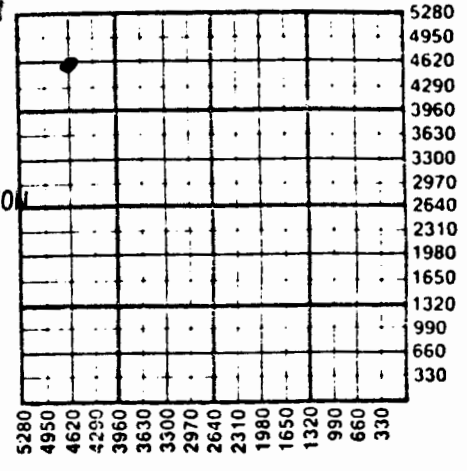

KANSAS GEOLOGICAL SURVEY  
WICHITA BRANCH  
NOV 17 1988  
RECEIVED  
STATE CORPORATION COMMISSION  
NOV 14 1988  
CONSERVATION DIVISION  
Wichita, Kansas

WATER SUPPLY INFORMATION

Disposition of Produced Water: Disposal  
Docket # E-23911 X Repressuring

Questions on this portion of the ACO-1 call:  
Water Resources Board (913) 296-3717  
Source of Water:  
Division of Water Resources Permit #.....  
Groundwater.....Ft North from Southeast Corner (Well) .....Ft West from Southeast Corner of Sec Twp Rge East West  
Surface Water.....Ft North from Southeast Corner (Stream,pond etc).....Ft West from Southeast Corner Sec Twp Rge East West  
Other (explain).....  
(purchased from city, R.W.D. #)

INSTRUCTIONS: This form shall be completed in triplicate and filed with the Kansas Corporation Commission, 200 Colorado Derby Building, Wichita, Kansas 67202, within 120 days of the spud date of any well. Rule 82-3-130, 82-3-107 and 82-3-106 apply. Information on side two of this form will be held confidential for a period of 12 months if requested in writing and submitted with the form. See rule 82-3-107 for confidentiality in excess of 12 months. One copy of all wireline logs and drillers time log shall be attached with this form. Submit CP-4 form with all plugged wells. Submit CP-111 form with all temporarily abandoned wells.

All requirements of the statutes, rules and regulations promulgated to regulate the oil and gas industry have been fully complied with and the statements herein are complete and correct to the best of my knowledge.

Signature *Chris J. Dodson*  
Title Supervisor-Regulatory Affairs Date 11/3/88

Subscribed and sworn to before me this 8th day of November 1988  
Notary Public *Janice Harlett*  
Date Commission Expires April 29, 1989

K.C.C. OFFICE USE ONLY  
F Letter of Confidentiality Attached  
C Wireline Log Received  
C Drillers Timelog Received  
Distribution  
KCC SWD/Rep NGPA  
KGS Plug Other  
(Specify)

Sec 34 Twp 21 Rge 34 W

W 125-15-42

SIDE TWO

Operator Name Conoco Inc. Lease Name Smith Well # 3

Sec. 34 Twp. 21S Rge. 24  East  West County Hodgeman

WELL LOG

INSTRUCTIONS: Show important tops and base of formations penetrated. Detail all cores. Report all drill stem tests giving interval tested, time tool open and closed, flowing and shut-in pressures, whether shut-in pressure reached static level, hydrostatic pressures, bottom hole temperature, fluid recovery, and flow rates if gas to surface during test. Attach extra sheet if more space is needed. Attach copy of log.

Drill Stem Tests Taken  Yes  No  
 Samples Sent to Geological Survey  Yes  No  
 Cores Taken  Yes  No

Formation Description  
 Log  Sample

Name	Top	Bottom
Toronto	3951'	
Lansing KC	3988'	
Marmaton	4452'	
Ft. Scott	4561'	
Miss. dolo	4626'	

CASING RECORD <input type="checkbox"/> New <input type="checkbox"/> Used							
Report all strings set-conductor, surface, intermediate, production, etc.							
Purpose of String	Size Hole Drilled	Size Casing Set (in O.D.)	Weight Lbs/Ft.	Setting Depth	Type of Cement	#Sacks Used	Type and Percent Additives
Surface	12 1/4"	8 5/8"	24#	605'	Common Class H	250	4% GEL 3% CACL
Production	7 7/8"	5 1/2"	14#	4709'	Lite Water Class H	150	2% CACL
						150	None
						150	10% salt, CFR-2

PERFORATION RECORD				Acid, Fracture, Shot, Cement Squeeze Record	
Shots Per Foot	Specify Footage of Each Interval Perforated		(Amount and Kind of Material Used)		Depth
4	4628'	-31'			
4	4634'	-39'			
	4653'	-70'		750 gal. 15% HCl	

TUBING RECORD			
Size	Set At	Packer at	Liner Run <input type="checkbox"/> Yes <input checked="" type="checkbox"/> No
		4580	

Date of First Production	Producing Method				
	<input type="checkbox"/> Flowing <input type="checkbox"/> Pumping <input type="checkbox"/> Gas Lift <input type="checkbox"/> Other (explain).....				
Estimated Production Per 24 Hours	Oil	Gas	Water	Gas-Oil Ratio	Gravity
	Bbls	MCF	Bbls		CFPB

METHOD OF COMPLETION

Production Interval

Disposition of gas:  Vented  Open Hole  Perforation  
 Sold  Other (Specify) .....  
 Used on Lease  Dually Completed .....  
 Commingled .....