

WAYNE LEBSACK
PETROLEUM GEOLOGIST
603 S. Douglas
Lyons, KS 67554

Geological Report

Lebsack Oil Production
Box 489
Hays, Kansas 67601

VanDoren Tr. # 1-14
2310 FSL - 660' FEL
Sec. 14-T21s-R35w
Kearney Co. Ks.

Contractor	Abercrombie RTD
Date Spudded	June 28, 1997
Date Rotary Completed	July 5, 1997
Total Depth	5000'
Casing	Surface 8-5/8" @ 258' Production 5-1/2" @ 4998'
Elevations	Ground Level 3094' Zero K.B. 3099'
Samples	2400' to 2800' 3400' to T.D.
Logs	Gas Detector, Halliburton Micro, Dual Induction & Density-Neutron

Geological Formation Tops

FORMATION	DRILLING DEPTH	ELECTRIC-LOG DEPTH	SUB-SEA DEPTH
Heebner		3940	- 841
Lansing	3990	3991	- 892
Base of K.C.	4462	4466	- 1367
Marmaton	4496	4499	- 1400
Cherokee	4618	4624	- 1525
Morrow Shale	4826	4828	- 1729
Morrow Sand	4878	4880	- 1781
Mississippi	4898	4902	- 1803
T.D.	5000	5004	- 1905

INTERVALS OF INTEREST

Marmaton

- No shows

Morrow Sand

- clear fine grained sand traces of free oil and staining in samples. Log porosity - 20% water saturation - 42%, gas detector logged 25 units

DST No. 1
4859-4897

- packer failure - mis run.

DST No. 2
4825-4897

- testing times 30-30-60-60- there was a strong blow. Recovered 870' gas, 650' gas cut muddy oil.

Pressures: Flow 86/171 & 203/297

Shut in: 674/694

SUMMARY

Structural Comparisons

FORMATION	Van Doren 1-14 this well	Foster D-2 N/offset Morrow oil well	Scott 4-14 NE/offset Morrow oil well
Lansing	-892	-878	- 866
Cherokee	-1525	-1522	-1514
Morrow Sand	-1781	-1780	-1777
Mississippi	-1803	-1803	-1794

The samples, gas detector, drill stem test and electric logs indicate commercial oil production in the Morrow Sand.

5-1/2" casing was cemented to test and complete for production.

Submitted by
Wayne Lebsack

Completion Report

Van Doren #1-14

1. July 14, 1997 - Drilled DV tool at 2879'
2. July 15, 1997 - Ran cement log, top of cement at 3560'
3. Perforated - 4882' - 4892', 2/holes per foot.
swabbed down, with good show of oil 500' off bottom.
4. swab tested 2/hours - recovered 14 B0 - 5/BW
5. July 16, 1997 - overnight fill-up 1300' oil & no water.
6. Tested 4/hours recovered 5 plus B0/per hr & no water.
7. July 17, 1997 - ran 2½' tubing, 7/8 & 3/4 rods,
12' X 1½" insert pump for production

Wayne Lebsack

LEBSACK OIL PRODUCTION, INC.
 VANDOREN TRUST LEASE
 SE.1/4, SECTION 14, T21S, R35W
 KEARNY COUNTY, KANSAS

Notes:

1. Set metal stake @ location site.
2. All flagging Red & Yellow.
3. No overhead power available @ Sec. 14.
4. Kansas One Call System Inc. should be notified before excavation (1-800-344-7233).
5. Caution: Various pipelines in Sec. 14.

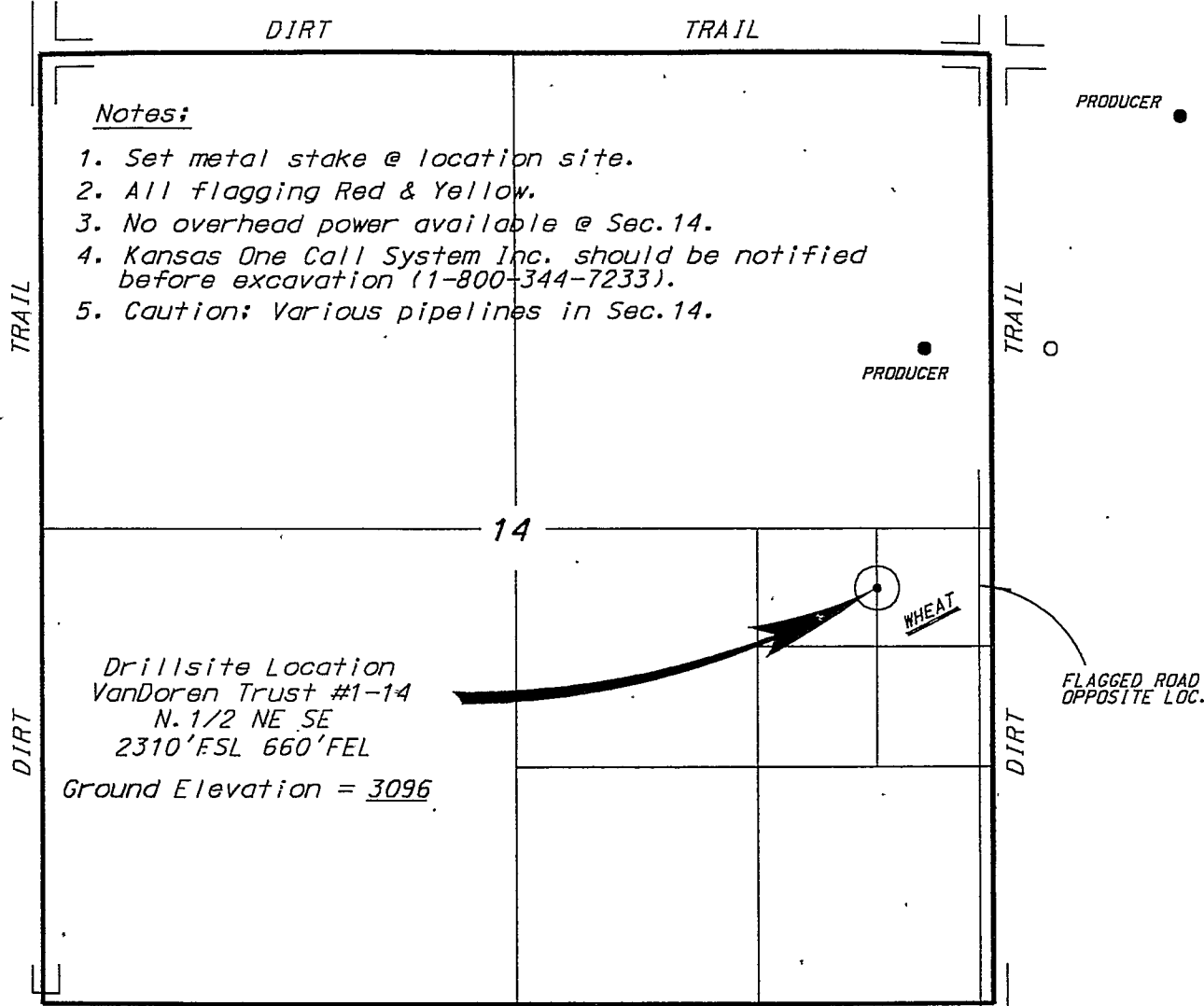

Drillsite Location
 VanDoren Trust #1-14
 N. 1/2 NE SE
 2310'ESL 660'FEL
 Ground Elevation = 3096

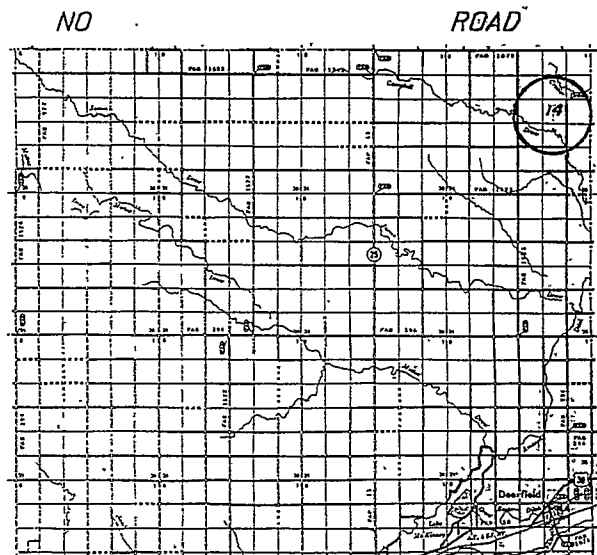

* Controlling data is based upon the best maps and photographs available to us and upon a regular section of land containing 640 acres.
 * Approximate section lines were determined using the normal standard of care of all field surveyors practicing in the state of Kansas. The section corners, which establish the precise section lines, were not necessarily located, and the exact location of the drillsite location in the section is not guaranteed.
 * Elevations derived from National Geodetic Vertical Datum.

Date June 16, 1997

LEBSACK OIL PRODUCTION, INC.

BOX 489

HAYS, KANSAS 67601

(913) 625-5444

<p>DRILLING CONTRACTOR: Abercrombie RTD, Inc. 150 N. Main, Suite #801 Wichita, KS 67202-1383</p> <p>Rig #8 _____, Tool Pusher</p> <p>913-743-5443 Home, (316) 793-2818 Cellular</p> <p>Rig #8 Phone #'s: (316) 793-2808 Doghouse</p>	<p>LOCATION VANDOREN TRUST 1-14 C N/2 NE SE Sec. 14 21s-35w Kearny County, Kansas Field: Christabelle</p> <p>API# _____</p> <p>Elevations: GL = 3096', KB = 4001'</p> <p>Geologist: Wayne Lebsack</p>	<p>DIRECTIONS TO LOCATION:</p> <p>NOTE!!!</p> <p>Stay on Right-of-Way</p>
--	--	--

!!!! Tight Hole !!!

The following are the geological requirements for the referenced well:

SAMPLES: From: 2400' to 2900' - 20' Dry samples are requested.
2900' to TD - 10' Dry samples are requested. Samples should be washed thoroughly, dried and tied in 100' bundles. All bags should be properly labeled.

SPECIAL EQUIPMENT: A Gas/Logging Detector will be used on this well. Have it on location and operating by 2400'. Mark all connections on both charts from 2400' to RTD. Clean out the extractor breather hole every 4 hours, and mark all light plant checks on the graph(s).

DRILLING TIME: Keep a written record of 1' drilling time from 2400' to TD. Complete headings, date each sheet, note all mud checks, and note any roughness in drilling on the drilling time sheet. Make sure the date and the (am/pm) is written on the header of each drilling time sheet. Use 1/2 minutes!

MUD: Have mud in condition for good sample returns by approximately 3700'. We want an 10 or less water loss before entering the Marmaton at 4400'.

CHECK DEPTH: A straight hole check should be run on the first DST. The drill pipe should also be strapped at this time. An additional straight hole test should be run at TD.

CALL DEPTH: Call the geologist when you have reached a depth of 3900'.

STOP POINT: Stop and circulate for samples if the geologist has not been on location by 4800'.

ANTICIPATED TOPS:

2150' Anhydrite	Topeka	3970' Lansing	4880' Morrow SS
2200' B/Anhydrite	3930' Heebner Sh	4428' BKC	4905' Miss.
		4596' Cherokee	5000' Est. RTD

SERVICE COMPANIES:

Cement	Testing	Gas Det.: MBC (316) 873-2953
Pipe	Mud	Logging

PHONE NUMBERS:

1 st call: Wayne Lebsack	(316) 257-3825 (Home)	(316) 938-2396 (Work)	Cellular (316) 793-2198
2 nd call: Steve McClain	(316) 672-5417 (Home)	(316) 672-9508 (Work)	Cellular (316) 546-3253