

P/

IMPORTANT
State Geo. Survey request
samples from this well.
State Geological Survey
WICHITA, BRANCH

KANSAS DRILLERS LOG

API No. 15 — 083 — 20,634
County Number

Operator Brooks Hall Oil Corp.	
Address 101 Park Ave., Suite 600 Oklahoma City, Okla 73102	
Well No. #1	Lease Name Cure, Inc.
Footage Location 660 feet from (N) (S) line 1730 feet from (E) (W) line	
Principal Contractor Slawson Drilling Company	Geologist Nelson R. Thomas
Spud Date January 22, 1979	Total Depth 4477'
Date Completed January 31, 1979	P.B.T.D.
Oil Purchaser None	

S. 34 T. 22 R. 22 E. W
Loc. NW NW
County Hodgeman

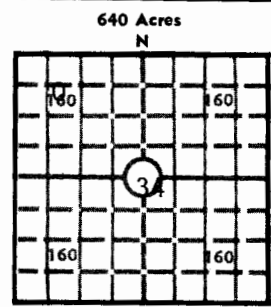

Locate well correctly
Elev.: Gr. 2169'
DF KB 2174'

CASING RECORD

Report of all strings set — surface, intermediate, production, etc.

Purpose of string	Size hole drilled	Size casing set (in O.D.)	Weight lbs/ft.	Setting depth	Type cement	Sacks	Type and percent additives
Surface	12-1/4"	8-5/8"	24	1317'	330 sx lite, 2% gel, 3% CC	200 sx 60	40 poz

LINER RECORD

PERFORATION RECORD

Top, ft.	Bottom, ft.	Sacks cement	Shots per ft.	Size & type	Depth interval

TUBING RECORD

Size	Setting depth	Packer set at

ACID, FRACTURE, SHOT, CEMENT SQUEEZE RECORD

Amount and kind of material used	Depth interval treated

INITIAL PRODUCTION

Date of first production None		Producing method (flowing, pumping, gas lift, etc.)	
RATE OF PRODUCTION PER 24 HOURS	Oil bbls.	Gas MCF	Water bbls.
Disposition of gas (vented, used on lease or sold)		Gas-oil ratio CFPB	
Producing interval(s)			

INSTRUCTIONS: As provided in KCC Rule 82-2-125, within 90 days after completion of a well, one completed copy of this Drillers Log shall be transmitted to the State Geological Survey of Kansas, 4150 Monroe Street, Wichita, Kansas 67209. Copies of this form are available from the Conservation Division, State Corporation Commission, 3830 So. Meridian (P.O. Box 17027), Wichita, Kansas 66217. Phone AC 316-522-2206. If confidential custody

Well No. 1	Lease Name Cure, Inc.
---------------	--------------------------

S 34 T 22SR 22 ^K_W

WELL LOG

Show all important zones of porosity and contents thereof; cored intervals, and all drill-stem tests, including depth interval tested, cushion used, time tool open, flowing and shut-in pressures, and recoveries.

SHOW GEOLOGICAL MARKERS, LOGS RUN, OR OTHER DESCRIPTIVE INFORMATION.

FORMATION DESCRIPTION, CONTENTS, ETC.	TOP	BOTTOM	NAME	DEPTH
Surface	0	510	Heebner	3759
Shale	510	785	Lansing	3820
Sand	785	938	Pawnee	4268
Sh & shells	938	1325	Labette	4338
Shale	1325	2385	Miss Osage	4428
Shale & Lime	2385	2930		
Lime & Shale	2930	3155		
Shale & Lime	3155	3355		
Lime & Shale	3355	3800		
Shale & Lime	3800	3950		
Lime & Shale	3950	4212		
Shale & Lime	4212	4410		
Lime	4410	4437		
Shale & Lime	4437			
Lime	4437	4477		
TD	4477			

USE ADDITIONAL SHEETS, IF NECESSARY, TO COMPLETE WELL RECORD.

Date Received



Signature

Mary J. Myers

Production Clerk

Title

April 16, 1981

Date