

18-22-24W

State Geological Survey
KANSAS WICHITA BRANCH

IMPORTANT
Kans. Geo. Survey request
samples on this well.

S. 18 T. 22 R. 24^{XX} W
Loc. C NW SE
County Hodgeman

API No. 15 — 083 — 20,306
County Number

Operator
Okmar Oil Company

Address 1130 Vickers KSB&T Building
Wichita, Kansas

Well No. #1 Lease Name Cavanaugh

Footage Location
1980 feet from XNO (S) line 1980 feet from (E) XWV line

Principal Contractor DNB Drilling Co., Inc. Geologist Dick Grant

Spud Date July 13, 1973 Total Depth 4660 P.B.T.D.

Date Completed July 23, 1973 Oil Purchaser

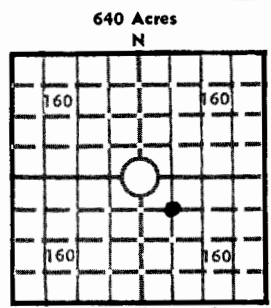

Elev.: Gr. 2482
DF 2484 KB 2487

CASING RECORD

Report of all strings set — surface, intermediate, production, etc.

Purpose of string	Size hole drilled	Size casing set (in O.D.)	Weight lbs./ft.	Setting depth	Type cement	Sacks	Type and percent additives
Surface	12 1/4"	8 5/8"		247	60/40 Poxmix	175	3% C.C.

LINER RECORD

PERFORATION RECORD

Top, ft.	Bottom, ft.	Sacks cement	Shots per ft.	Size & type	Depth interval

TUBING RECORD

Size	Setting depth	Packer set at

ACID, FRACTURE, SHOT, CEMENT SQUEEZE RECORD

Amount and kind of material used	Depth interval treated

INITIAL PRODUCTION

Date of first production		Producing method (flowing, pumping, gas lift, etc.)			
RATE OF PRODUCTION PER 24 HOURS	Oil	Gas	Water	Gas-oil ratio	
	bbls.	MCF	bbls.	CFPB	
Disposition of gas (vented, used on lease or sold)			Producing interval (s)		

INSTRUCTIONS: As provided in KCC Rule 82-2-125, within 90 days after completion of a well, one completed copy of this Drillers Log shall be transmitted to the State Geological Survey of Kansas, 4150 Monroe Street, Wichita, Kansas 67209. Copies of this form are available from the Conservation Division, State Corporation Commission, 3830 So. Meridian (P.O. Box 17027), Wichita, Kansas 66217. Phone AC 316-522-2206. If confidential custody is desired, please note Rule 82-2-125. Drillers Logs will be on open file in the Oil and Gas Division, State Geological Survey of Kansas, Lawrence, Kansas 66044.

Operator		DESIGNATE TYPE OF COMP.: OIL, GAS, DRY HOLE, SWDW, ETC.:
Well No. 1	Lease Name Cavanaugh	Dry Hole
S 18 T 22 R 24 SE W		

WELL LOG

Show all important zones of porosity and contents thereof; cored intervals, and all drill-stem tests, including depth interval tested, cushion used, time tool open, flowing and shut-in pressures, and recoveries.

SHOW GEOLOGICAL MARKERS, LOGS RUN,
OR OTHER DESCRIPTIVE INFORMATION.

FORMATION DESCRIPTION, CONTENTS, ETC.	TOP	BOTTOM	NAME	DEPTH
	SMP TOPS:			
			BLAINE	1065
			SC	1668
			B SC	1700
			HEEB	3924
			LANS	3980
			BKC	4367
			FT S	4518
			CHER	4544
			FRO MISS	4604
			RTD	4660
<p align="center">Sec. 18-22S-24W C NW SE Hodgeman Co., Ks.</p> <p><u>Cavanaugh #1</u></p> <p>DST #1 4460-4545 30/30/30/30 Rec. 25' mud 391/111 55/69 109°</p> <p>DST #2 4596-4639 30/30/30/30 Rec. 20' mud w/few specks oil 298/93 28/37 110°</p> <p>DST #3 4639-4652 30/30/30/30 weak blow Rec. 15' mud 900/706 9/14 110°</p> <p>DST #4 4652-4660 30/30/30/30 Rec. 295' SW 1280/1252 18/139 110°</p>				

USE ADDITIONAL SHEETS, IF NECESSARY, TO COMPLETE WELL RECORD.



Don W. Beauchamp
Signature

Don W. Beauchamp, Geologist
Title

September 14, 1973
Date

DRILLERS' LOG

18-22-24W

OKMAR OIL COMPANY
No. 1 Cavanaugh
C NW SE Sec. 18-22S-24W
Hodgeman County, Kansas



Commenced: 7-13-73
Completed: 7-23-73

Elevation: 2487 K. B.

Surface Casing: 239' of
8-5/8" cemented w/175 sx
cement, 3% cc. 7-13-73

<u>FORMATION</u>	<u>DEPTH</u>
Surface Hole	0 - 247
Shale and Sand	247 - 1065
Blaine Anhydrite	1065 - 1080
Shale and Sand	1080 - 1105
Shale	1105 - 1165
Sand	1165 - 1350
Shale	1350 - 1668
Stone Carral Anhydrite	1668 - 1700
Shale	1700 - 1740
Shale and Lime	1740 - 2500
Lime and Shale	2500 - 4160
Lime	4160 - 4660 T. D.

I do hereby certify that the foregoing statements are true and correct to the best of my knowledge and belief.

D N B DRILLING, INC.

James L. Donelson
James L. Donelson

STATE OF KANSAS: ss

Subscribed and sworn to before me, the undersigned, a Notary Public in and for said State, this 24th day of July, 1973.

Ella Priess

Ella Priess, Notary