

KANSAS CORPORATION COMMISSION

WELL RECORD

23-22-24W

(Mail to Kansas Geological Survey, 4150 Monroe Street, Wichita, Kansas 67209)

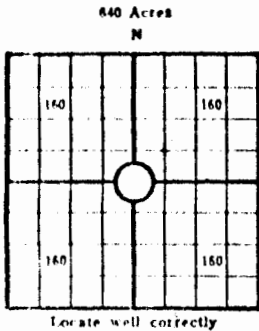

API-15-083-20,215

L

Lease Name: SPRINGER Well No. 5
 Well Located: C. S/2 SW/4 *Hodgeman Cty.*
SEC 23 TWP 22S RGE 0 24W
 Operator: Petroleum, Inc.
 Address: Wichita, Kansas
 Elevation: Ground 2416' D.F. 2418' K.B. 2421'
 Type Well: (Oil, gas, dry hole) Dry Hole
 Contractor: Garvey Drilling Co.

Drilling Commenced: March 8 19 72 Drilling Completed: March 22 19 72
 Well Completed: March 22 19 72 Total Depth RTD 4681' *4682'*
 Initial Production: *Q → A* *well log*

Casing Record

Size: 8-5/8" Set at 563' Size: _____ Set at _____
 Size: _____ Set at _____ Size: _____ Set at _____

Liner Record

Size: _____ Set from _____ To _____

Cementing

Casing Size	Sacks	Type Cement and Additives
<u>8-5/8"</u>	<u>275</u>	<u>Regular, 3% HA5</u>
_____	_____	_____
_____	_____	_____

Perforations

Formation	Perforated Interval and Number Shots
_____	_____
_____	_____
_____	_____
_____	_____

Electric Log Run (Show type log and depths covered)

Dresser Atlas Gamma Ray-Neutron-Laterolog (4682 - 0)

83-88-54

Show Drill Stem Tests,
Well Stimulation and
Production Tests

23-22-24w

Formation	Top	Bottom
<u>E. L. TOPS:</u>		
Heebner	3918	-1497
Toronto	3932	-1511
Lansing	3969	-1548
Fort Scott	4518	-2097
Mississippi	4619	-2198
ELTD	4683	-2262

DST #1: 4622-30: 30-30-30-60; Weak Blow
Throughout Test; 62' Slightly Oil Cut Mud;
1FP 9#-18#, 1BHP 639#, 2FP 18#-27#, 2BHP 722#

DST #2: 4631-40: 30-30-30-30; Good Blow;
120' Oil Cut Mud; 1FP 27#-27#, 1BHP 462#,
2FP 47#-46#, 2BHP 250#

DST #3: 4641-50: 30-30-30-60; 35' Mud
w/Show of Oil; 1FP 9#-18#, 1BHP 574#,
2FP 18#-27#, 2BHP 547#

DST #4: 4651-66: 30-30-30-60; 35' Watery
Mud w/Specks of Oil; 1FP 9#-12#, 1BHP 925#,
2FP 12#-18#, 2BHP 934#

DST #5: 4666-81: 30-30-30-60; Weak Blow;
15' Mud; 1FP 9#-14#, 1BHP 731#, 2FP 14#-18#,
2BHP 1082#

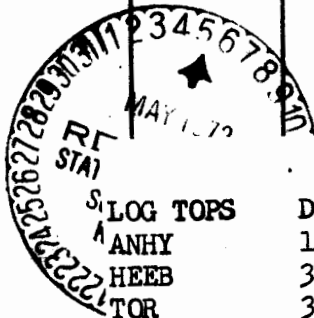

FIGURES INDICATE BOTTOM OF FORMATIONS

LOG TOPS	DEPTH
ANHY	1624
HEEB	3918
TOR	3932
LKC	3969
FT SC	4518
MISS	4619
RTD	4681
LTD	4683

- 50' Surface Clay
- 490' Shale
- 1105' Red Bed & Shale
- 1265' Sand
- 1692' Red Bed
- 2230' Shale
- 2484' Lime & Shale
- 4047' Lime
- 4640' Lime & Chert
- 4650' Chert w/Lime
- 4666' Lime & Chert
- 4682' Lime & Chert
- 4682' RTD