

KANSAS DRILLERS LOG

**State Geological Survey
WICHITA, BRANCH**

S. 26 T. 22S R. 24 ^X/_W

API No. 15 — 0837 — 20,441
County Number

Loc. C NW SE

County Hodgeman

Operator
DANE G HANSEN TRUST

Address
LOGAN, KANSAS 67646

Well No. 2 Lease Name FORD

Footage Location
660 feet from (N) (X) line 660 feet from (W) (X) line

Principal Contractor C-G DRILLING CO Geologist J. JESPERSEN

Spud Date OCTOBER 3, 1975 Total Depth 4660' P.B.T.D.

Date Completed OCTOBER 13, 1975 Oil Purchaser

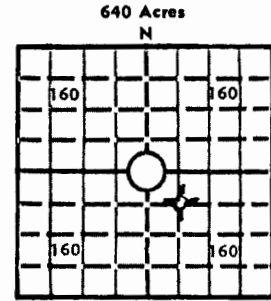

Locate well correctly
Elev.: Gr. 2386

DF 2388 KB 2391

CASING RECORD

Report of all strings set — surface, intermediate, production, etc.

Purpose of string	Size hole drilled	Size casing set (in O.D.)	Weight lbs/ft.	Setting depth	Type cement	Sacks	Type and percent additives
SURFACE	12 1/4"	8 5/8"	32#	403.52'	Common	250	2% GEL 3% CC

LINER RECORD

PERFORATION RECORD

Top, ft.	Bottom, ft.	Sacks cement	Shots per ft.	Size & type	Depth interval

TUBING RECORD

Size	Setting depth	Packer set at

ACID, FRACTURE, SHOT, CEMENT SQUEEZE RECORD

Amount and kind of material used	Depth interval treated

INITIAL PRODUCTION

Date of first production		Producing method (flowing, pumping, gas lift, etc.)			
RATE OF PRODUCTION PER 24 HOURS	OIL	Gas	Water	Gas-oil ratio	
	bbis.	MCF	bbis.	CFPB	
Disposition of gas (vented, used on lease or sold)			Producing interval (s)		

INSTRUCTIONS: As provided in KCC Rule 82-2-125, within 90 days after completion of a well, one completed copy of this Drillers Log shall be transmitted to the State Geological Survey of Kansas, 4150 Monroe Street, Wichita, Kansas 67209. Copies of this form are available from the Conservation Division, State Corporation Commission, 3830 So. Meridian (P.O. Box 17027), Wichita, Kansas 66217. Phone AC 316-522-2206. If confidential custody is desired, please note Rule 82-2-125. Drillers Logs will be on open file in the Oil and Gas Division, State Geological Survey of Kansas, Lawrence, Kansas 66044.

Jpe

DESIGNATION: TYPE OF COMPLETION: OIL, GAS,
DRY HOLE, SWDW, ETC.:

DANE G HANSEN TRUST

DRY HOLE

Well No.

2

Lease Name

FORD

526 T22SR 24^{XX}_W

WELL LOG

Show all important zones of porosity and contents thereof; cored intervals, and all drill-stem tests, including depth interval tested, cushion used, time tool open, flowing and shut-in pressures, and recoveries.

SHOW GEOLOGICAL MARKERS, LOGS RUN, OR OTHER DESCRIPTIVE INFORMATION.

FORMATION DESCRIPTION, CONTENTS, ETC.	TOP	BOTTOM	NAME	DEPTH
SAND & SHALE	0	1180	Anhydrite	1607
SAND	1180	1290	Heebner	3929
RED BED	1290	1607	Toronto	3957
ANHYDRITE	1607	1649	Lansing	3985
SHALE & SHELLS	1649	2185	Base/K.C.	4378
SHALE & LIME	2185	2430	Marmaton	4398
LIME & SHALE	2430	4295	Ft. Scott	4540
LIME	4295	4660	Cherokee	4562
TOTAL DEPTH		4660	Conglomerate RTD	4622 4660

DST #1: 4608-4640' OPEN 30 SI 30
OP 30 SI 30. WEAK BLOW F/10 MIN.
REC 10' MUD. FBHP 154#, IFP 24#,
FFP @24#, IBHP 521#.

USE ADDITIONAL SHEETS, IF NECESSARY, TO COMPLETE WELL RECORD.

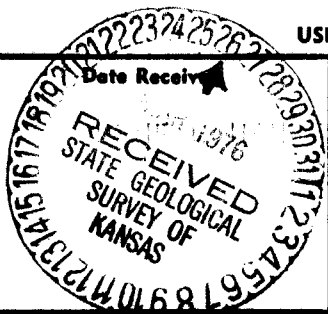

Phyllis Buchanan

Phyllis Buchanan
Office Manager

October 20, 1975

Date