

API No. 15 — 055 — 20,093
 County _____ Number _____

Loc. C NW SE

Operator
I. Wayne Woolsey

County Finney

Address
514 Petroleum Building, Wichita, Kansas 67202

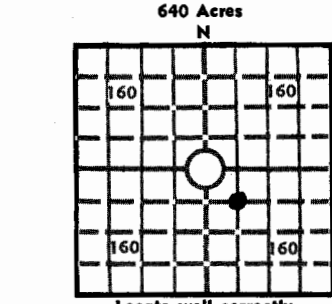

Well No. 3-A Lease Name Stevenson

Footage Location
1980 feet from (N) (S) line 1980 feet from (E) (W) line

Principal Contractor Gabbert-Jones, Inc. Geologist I. Wayne Woolsey

Locate well correctly
 Elev.: Gr. 2898

Spud Date 3-28-72 Total Depth 4800' P.B.T.D. _____

Date Completed 4-29-72 Oil Purchaser The Permian Corporation

DF 2901 KB 2903

CASING RECORD

Report of all strings set — surface, intermediate, production, etc.

Purpose of string	Size hole drilled	Size casing set (in O.D.)	Weight lbs/ft.	Setting depth	Type cement	Sacks	Type and percent additives
Surface		8-5/8"		418		250	
Production		5-1/2"		4796	50-50 Pozmix	100	

LINER RECORD

PERFORATION RECORD

Top, ft.	Bottom, ft.	Sacks cement	Shots per ft.	Size & type	Depth interval
			2	D.P. Jet	4740-43
TUBING RECORD			2	D.P. Jet	4747-50
Size	Setting depth	Packer set at			
2-3/8"	4727	4727			

ACID, FRACTURE, SHOT, CEMENT SQUEEZE RECORD

Amount and kind of material used	Depth interval treated
250 Gal. 15% SME	4740-43; 4747-50
250 Gal. 15% SME	" "
1916 Gal. 28% retarded	" "

INITIAL PRODUCTION

Date of first production <u>4-29-72</u>		Producing method (flowing, pumping, gas lift, etc.) <u>Pumping</u>			
RATE OF PRODUCTION PER 24 HOURS	Oil <u>30</u> bbls.	Gas <u> </u> MCF	Water <u>30</u> bbls.	Gas-oil ratio <u> </u> CFPB	
Disposition of gas (vented, used on lease or sold) <u>Used on Lease</u>			Producing interval (s) <u>4740-43; 4747-50</u>		

INSTRUCTIONS: As provided in KCC Rule 82-2-125, within 90 days after completion of a well, one completed copy of this Drillers Log shall be transmitted to the State Geological Survey of Kansas, 4150 Monroe Street, Wichita, Kansas 67209. Copies of this form are available from the Conservation Division, State Corporation Commission, 3830 So. Meridian (P.O. Box 17027), Wichita, Kansas 66217. Phone AC 316-522-2206. If confidential custody is desired, please note Rule 82-2-125. Drillers Logs will be on open file in the Oil and Gas Division, State Geological Survey of Kansas, Lawrence, Kansas 66044.

Operator I. Wayne Woolsey
 Well No. 3-A Lease Name Stevenson
 Oil
 S 6 T 22 R 33 W

DESIGNATE TYPE OF COMP.: OIL, GAS, DRY HOLE, SWDW, ETC.:

WELL LOG

Show all important zones of porosity and contents thereof; cored intervals, and all drill-stem tests, including depth interval tested, cushion used, time tool open, flowing and shut-in pressures, and recoveries.

SHOW GEOLOGICAL MARKERS, LOGS RUN, OR OTHER DESCRIPTIVE INFORMATION.

FORMATION DESCRIPTION, CONTENTS, ETC.	TOP	BOTTOM	NAME	DEPTH
DST #1 (Morrow-Ste. Gen.) 30-30-30-30 Rec. 5' mud, FP 47-63# SIP 110-78# - Limestone	4632	4720	Chase Heebner Lansing Marmaton Cherokee Morrow Ste. Genevieve	2526 3779 3798 4324 4429 4634 4664
DST #2 (St. Louis) 30-60-45-90 Weak blow, Rec. 2' free oil 5' HOcm, 70' SOcm, FP 63-78, SIP 1164-1164# Oolitic Limestone	4726	4770	St. Louis	4740

USE ADDITIONAL SHEETS, IF NECESSARY, TO COMPLETE WELL RECORD.



I. Wayne Woolsey
 Signature
 Title
 8-24-73
 Date