

**KANSAS DRILLERS LOG**

*State Geological Survey*  
WICHITA BRANCH

S. 35 T. 23S R. 12 ~~W~~

API No. 15 — 185 — 20,932  
County Number

Loc. SW NE NW

County Stafford

Operator  
American Energies Corp.

Address  
575 Fourth Financial Ctr

Well No. 1 Lease Name Hearn

Footage Location  
990 feet from (N) ~~NE~~ line 1650 feet from ~~SE~~ (W) line

Principal Contractor Woodman-Iannitti Geologist Charley V. Shank

Spud Date 7-23-79 Total Depth 3911 P.B.T.D.

Date Completed 8-1-79 Oil Purchaser

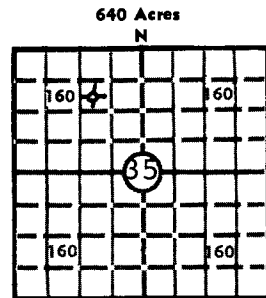

Locate well correctly

Elev.: Gr. 1851

DF 1854 KB 1856

**CASING RECORD**

Report of all strings set— surface, intermediate, production, etc.

Purpose of string	Size hole drilled	Size casing set (in O.D.)	Weight lbs/ft.	Setting depth	Type cement	Sacks	Type and percent additives
Surface	12 1/4"	8 5/8	28#	312	Common	195	2% gel, 3% cc

**LINER RECORD**

**PERFORATION RECORD**

Top, ft.	Bottom, ft.	Sacks cement	Shots per ft.	Size & type	Depth interval

**TUBING RECORD**

Size	Setting depth	Packer set at

**ACID, FRACTURE, SHOT, CEMENT SQUEEZE RECORD**

Amount and kind of material used	Depth interval treated

**INITIAL PRODUCTION**

Date of first production		Producing method (flowing, pumping, gas lift, etc.)			
RATE OF PRODUCTION PER 24 HOURS	Oil bbis.	Gas MCF	Water bbis.	Gas-oil ratio	CFPB
Disposition of gas (vented, used on lease or sold)			Producing interval (s)		

**INSTRUCTIONS:** As provided in KCC Rule 82-2-125, within 90 days after completion of a well, one completed copy of this Drillers Log shall be transmitted to the State Geological Survey of Kansas, 4150 Monroe Street, Wichita, Kansas 67209. Copies of this form are available from the Conservation Division, State Corporation Commission, 3830 So. Meridian (P.O. Box 17027), Wichita, Kansas 66217. Phone AC 316-522-2206. If confidential custody is desired, please note Rule 82-2-125. Drillers Logs will be on open file in the Oil and Gas Division, State Geological Survey of Kansas, Lawrence, Kansas 66044.

Operator American Energies Corp. DESIGNATE TYPE OF COMP.: OIL, GAS, DRY HOLE, SWDW, ETC.: Dry Hole

Well No. 1 Lease Name Hearn

S 35 T 23 R 12 W

**WELL LOG**  
 Show all important zones of porosity and contents thereof; cored intervals, and all drill-stem tests, including depth interval tested, cushion used, time tool open, flowing and shut-in pressures, and recoveries. SHOW GEOLOGICAL MARKERS, LOGS RUN, OR OTHER DESCRIPTIVE INFORMATION.

FORMATION DESCRIPTION, CONTENTS, ETC.	TOP	BOTTOM	NAME	DEPTH
7-28-79 DST#1 2872-2930, 30(30)30(60) Fair to strong blow throughout. Rec. 480' MCW, SIPs 984 & 1010#, FP 132 to 140 & 182-223#. Drilling @ 3328'.				
7-29-79 DST#2 3489-3510', 30(30)30(60). Good blow throughout. Rec. 300' GIP, 180' GCM w/specks oil, 120' MCW, SIPs 1204 & 1214#, FP 91 to 112 & 163-173#. Temp. 105°. DST#3 3536-52 30(30)30(30). Weak blow for 30 min., rec. 180' GIP, 60' GCO Spk Mud, SIPs 58 & 69#, FP 49 to 49 & 58 to 58#. Temp. 105°.				
7-30-79 Drilling @ 3745'.				
7-31-79 Mix mud @ 3854'. DST#4 3834-91' 30(30)30(60). Weak to fair to strong throughout. Rec. 325 GIP, 5' GOWCM w/spots. 250' GC Wtry M. SIP 1278 & 1315#, FP 71 to 102 & 122 to 173#. Temp. 113°.				
8-1-79 T.D. 3911, Plugging.				

Electric Log	
Hb	3230 - 1374 7' low
Lans.	3403 - 1547
B/Ks. City	3677 - 1821
Conglomerate	3716 - 1860
Viola	3742 - 1886
Simp.	3835 - 1979
Arb.	3887 - 2031
Total Depth	3908 - 2052

LTD 3908

RY, TO COMPLETE WELL RECORD.

*Ronald J. Schneider*  
Signature

Operations Manager  
Title

3-5-81  
Date