

**KANSAS DRILLERS LOG**

State Geological Survey  
WICHITA, BRANCH

S. 20 T. 23 R. 19W 

API No. 15 — 047 — 20026-A  
County Number

Loc. C SW NE

County Edwards

Operator  
Sterling Drilling Co.

Address  
P. O. Box 129 Sterling, Kansas 67579

Well No. #1 Lease Name Butterfield - Washdown

Footage Location  
660' feet from ~~SW~~ (S) line 660' feet from ~~SW~~ (W) line

Principal Contractor Kansas-Nebraska Natural Gas Co. Geologist Wayne Lebsack

Spud Date 12-17-76 Total Depth 1363' P.B.T.D.

Date Completed 12-18-76 Oil Purchaser Plugged

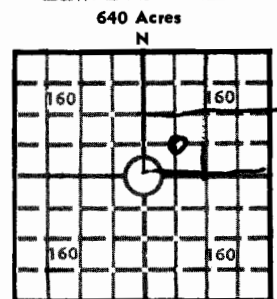

Elev.: Gr. \_\_\_\_\_

DF \_\_\_\_\_ KB \_\_\_\_\_

MAY 18 1977

**CASING RECORD**

Report of all strings set — surface, intermediate, production, etc.

Purpose of string	Size hole drilled	Size casing set (in O.D.)	Weight lbs/ft.	Setting depth	Type cement	Sacks	Type and percent additives
8 5/8" Surface pipe already set				at 290'			

**LINER RECORD**

**PERFORATION RECORD**

Top, ft.	Bottom, ft.	Sacks cement	Shots per ft.	Size & type	Depth interval

**TUBING RECORD**

Size	Setting depth	Packer set at

**ACID, FRACTURE, SHOT, CEMENT SQUEEZE RECORD**

Amount and kind of material used	Depth interval treated

**INITIAL PRODUCTION**

Date of first production Plugged - Got out old hole right after leaving surface pipe.		Producing method (flowing, pumping, gas lift, etc.)			
RATE OF PRODUCTION PER 24 HOURS	Oil bbls.	Gas MCF	Water bbls.	Gas-oil ratio	CFPB
Disposition of gas (vented, used on lease or sold)			Producing interval (s)		

INSTRUCTIONS: As provided in KCC Rule 82-2-125, within 90 days after completion of a well, one completed copy of this Drillers Log shall be transmitted to the State Geological Survey of Kansas, 4150 Monroe Street, Wichita, Kansas 67209. Copies of this form are available from the Conservation Division, State Corporation Commission, 3830 So. Meridian (P.O. Box 17027), Wichita, Kansas 66217. Phone AC 316-522-2206. If confidential custody is desired, please note Rule 82-2-125. Drillers Logs will be on open file in the Oil and Gas Division, State Geological Survey of Kansas, Lawrence, Kansas 66044.

Operator  
Sterling Drilling Company

DESIGNATE TYPE OF COMP.: OIL, GAS,  
DRY HOLE, SWDW, ETC.:  
Dry Hole

Well No.  
#1 WD

Lease Name  
Butterfield #1 WD

S 20 T 23S R 19W ~~EA~~  
W

**WELL LOG**

Show all important zones of porosity and contents thereof; cored intervals, and all drill-stem tests, including depth interval tested, cushion used, time tool open, flowing and shut-in pressures, and recoveries.

SHOW GEOLOGICAL MARKERS, LOGS RUN,  
OR OTHER DESCRIPTIVE INFORMATION.

FORMATION DESCRIPTION, CONTENTS, ETC.	TOP	BOTTOM	NAME	DEPTH

USE ADDITIONAL SHEETS, IF NECESSARY, TO COMPLETE WELL RECORD.

Date Received

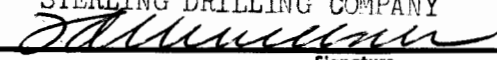
STERLING DRILLING COMPANY  
  
Signature  
F. A. Wuellner, Secretary  
Title  
January 21, 1977  
Date