

KANSAS

State Geological Survey  
WICHITA BRANCH

WELL COMPLETION REPORT AND  
DRILLER'S LOG

S. 2 T. 23 R. 22 E  
W

Loc. 200' N, C W/2 SE/4

County Hodgeman Co., KS

API No. 15 — 083 — 20,875  
County Number

Operator  
Mid-Continent Energy Corporation

Address  
120 S. Market, 120 Bldg., #712, Wichita, KS 67202

Well No. 2 Lease Name Querbach

Footage Location  
1520 feet from (N) ~~XX~~ line 1980 FEL, 660 from CL  
660 feet from (E) ~~XX~~ line

Principal Contractor White & Ellis Drilling Geologist John Rose

Spud Date 7-23-81 Date Completed 8-4-81 Total Depth 4550' P.B.T.D. 4460'

Sectional Deviation Oil and/or Gas Purchaser

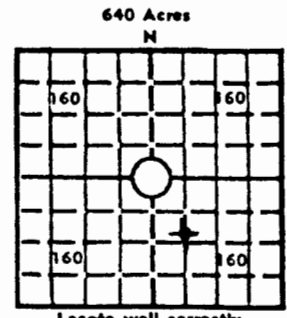

Elev.: Gr. 2236'

DF KB 2241'

CASING RECORD

Report of all strings set — surface, intermediate, production, etc.

Purpose of string	Size hole drilled	Size casing set (in O.D.)	Weight lbs/ft.	Setting depth	Type cement	Socks	Type and percent additives
Surface		8 5/8"	20#	399'	Common	250	2% gel., 3% CC

LINER RECORD

PERFORATION RECORD

Top, ft.	Bottom, ft.	Sacks cement	Shots per ft.	Size & type	Depth interval

TUBING RECORD

Setting depth	Pecker set at

ACID, FRACTURE, SHOT, CEMENT SQUEEZE RECORD

Amount and kind of material used	Depth interval treated

INITIAL PRODUCTION

Date of first production	Producing method (flowing, pumping, gas lift, etc.)				
RATE OF PRODUCTION PER 24 HOURS	Oil	Gas	Water	Gas-oil ratio	
	bbls.	MCF	bbls.	CFPB	
Disposition of gas (vented, used on lease or sold)			Producing interval(s)		

INSTRUCTIONS: As provided in KCC Rule 82-2-125, within 90 days after completion of a well, one completed copy of this Drillers Log shall be transmitted to the State Geological Survey of Kansas, 4150 Monroe Street, Wichita, Kansas 67209. Copies of this form are available from the Conservation Division, State Corporation Commission, 245 No. Water, Wichita, Kansas 67202. Phone AC 316-522-2206. If confidential custody is desired, please note Rule 82-2-125. Drillers Logs will be on an open file in the Oil and Gas Division, State Geological Survey of Kansas, Lawrence, Kansas 66044.

\$7  
SEP

Operator Mid-Continent Energy Corporation DESIGNATE TYPE OF COMP.: OIL, GAS, DRY HOLE, SWDW, ETC.:

Well No. #2 Lease Name Querbach D & A

S 2 T 23 R 22 <sup>NE</sup> W 200' N, C W/2 SE/4

**WELL LOG**  
 Show all important zones of porosity and contents thereof; cored intervals, and all drill-stem tests, including depth interval tested, cushion used, time tool open, flowing and shut-in pressures, and recoveries. SHOW GEOLOGICAL MARKERS, LOGS RUN, OR OTHER DESCRIPTIVE INFORMATION.

FORMATION DESCRIPTION, CONTENTS, ETC.	TOP	BOTTOM	NAME	DEPTH
Refer to attached sheet.				
<u>DST #1:</u> (Ft. Scott-Cherokee) 4413-4450'. 30-30-30-30; wk. blow 20", died; Rec. 10' mud; FP=44-44; SIP=55-55.				
<u>DST #2:</u> (Miss. Osage) 4447-4494'. 30-30-30-30. wk. blow 10", died; Rec. 10' mud, N.S. FP=44-44; SIP=560-484. (had partial plugging action indicated).				
<u>DST #3:</u> (Miss. Osage) 4447-4502', 45-60-45-60; strong blow; Rec. 2240' SOCMW (7% to 1% oil) + 660' wtr. (2900' total fl.); FP=341-1390; SIP=1401-1401; 126°.				

USE ADDITIONAL SHEETS, IF NECESSARY, TO COMPLETE WELL RECORD.

Date Received	
	Signature
	Exploration Manager
	Title
	Date

PI

DRILLERS LOG

OPERATOR: Mid Continent Energy Suite 712 One Twenty Bldg. Wichita, Ks. 67202

CONTRACTOR: **White & Ellis Drilling, Inc., Box 448, El Dorado, Kansas 67042**

Lease Name Querbach Well No. #2

Sec. 2 T. 23 R. 22W Spot W/2 SE

County Hodgeman State Kansas Elevation \_\_\_\_\_

Casing Record:

Surface: 8 5/8 @ 391' with 250 Sxs. 2%gel  
3%cc

Production: \_\_\_\_\_ @ \_\_\_\_\_ with \_\_\_\_\_ Sxs.

Type Well: D & A Total Depth 4550'

Drilling Commenced: 7-23-81 Drilling Completed 8-4-81

Formation	From	To	Tops
Cellar	0	7	
Shale, Lime	7	4020	
Lime	4020	4550	

COMPLETION RECORD

Liner Record: Size \_\_\_\_\_ From \_\_\_\_\_ To \_\_\_\_\_

Cementing Record: \_\_\_\_\_ Sacks \_\_\_\_\_

Perforating Record:

2-23-22W

State Geological Survey

WICHITA BRANCH

JAN 22 1982

# MID-CONTINENT ENERGY Corporation

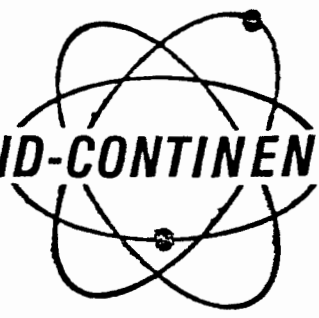

120 Building • Suite 712 • 120 S. Market • Wichita, Kansas 67202 • (316) 265-9501

## ELECTRIC LOG TOPS

### QUERBACH #2

Approx. 200' NW of C W/2 SE/4 of Sec. 2-23-22W  
Hodgeman Co., KS

KB = 2241'  
DF = 2239'  
GL = 2236'

Anhydrite		
Heebner	3817	-1576
Lansing	3890	-1649
Base/KC	4258	-2017
Marmaton	4269	-2028
Pawnee	4334	-2093
Ft. Scott	4420	-2179
Cherokee	4446	-2205
Mississippi	4491	-2250
RTD	4550	-2309
LTD	4555	-2314

*[Faint, illegible text or stamp at the bottom of the page]*