

S. 11 T. 23 R. 22 ^{EX}W

API No. 15 - 083 - 20,267
County Number

Loc. C NW NE
County Hodgeman

Operator

Mack Oil Company

Address

812 Union Center, Wichita, KS 67202

Well No.

#1

Lease Name

Chilson Confidential

Footage Location

660 feet from (N) line 660 feet from (W) line

Principal Contractor

Thomas Drlg. Co.

Geologist

Benny Singleton, Jr.

Spud Date

11-25-72

Total Depth

4495'

P.B.T.D.

Date Completed

12-5-72

Oil Purchaser

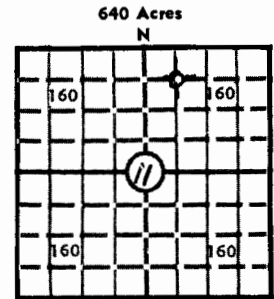

Elev.: Gr. 2212'

DF 2217' KB 2219'

CASING RECORD

Report of all strings set — surface, intermediate, production, etc.

Purpose of string	Size hole drilled	Size casing set (in O.D.)	Weight lbs/ft.	Setting depth	Type cement	Sacks	Type and percent additives
surface pipe		8 5/8"	28#	330'	pozmix	225	3% HA-5

LINER RECORD

PERFORATION RECORD

Top, ft.	Bottom, ft.	Sacks cement	Shots per ft.	Size & type	Depth interval

TUBING RECORD

Size	Setting depth	Packer set at

ACID, FRACTURE, SHOT, CEMENT SQUEEZE RECORD

Amount and kind of material used	Depth interval treated

INITIAL PRODUCTION

Date of first production		Producing method (flowing, pumping, gas lift, etc.)			
RATE OF PRODUCTION PER 24 HOURS		Oil	Gas	Water	Gas-oil ratio
		bbls.	SCF	bbls.	CFPB
Disposition of gas (vented, used on lease or sold)				Producing interval (s)	

INSTRUCTIONS: As provided in KCC Rule 82-2-125, within 90 days after completion of a well, one completed copy of this Drillers Log shall be transmitted to the State Geological Survey of Kansas, 4150 Monroe Street, Wichita, Kansas 67209. Copies of this form are available from the Conservation Division, State Corporation Commission, 3830 So. Meridian (P.O. Box 17027), Wichita, Kansas 66217. Phone AC 316-522-2206. If confidential custody is desired, please note Rule 82-2-125. Drillers Logs will be on open file in the Oil and Gas Division, State Geological Survey of Kansas, Lawrence, Kansas 66044.

erator

Mack Oil Co.

DESIGNATE TYPE OF COMP.: OIL, GAS,
DRY HOLE, SWDW, ETC.:
dry hole

Well No.

1

Lease Name

Chalson

S 11 T 23 R 22 E
W

WELL LOG

Show all important zones of porosity and contents thereof; cored intervals, and all drill-stem tests, including depth interval tested, cushion used, time tool open, flowing and shut-in pressures, and recoveries.

SHOW GEOLOGICAL MARKERS, LOGS RUN,
OR OTHER DESCRIPTIVE INFORMATION.

FORMATION DESCRIPTION, CONTENTS, ETC.	TOP	BOTTOM	NAME	DEPTH
Surface soil & rock	0	40	L-GR-N	330' -4495'
Shale	40	154		
Sand	154	213		
Shale	213	333		
Shale, shells, & redbed	333	810	Heebner	3797 (-1578)
Sand	810	956	Lansing	3871 (-1652)
Shale & Shells	956	1050	B/KC	4168 (-1949)
Shale	1050	1350	Ft. Scott	4397 (-2178)
Anhydrite	1350	1390	Cherokee	4422 (-2203)
Shale	1390	1810	Mississippi	4467 (-2248)
Shale & Lime	1810	2280	Miss. Osage	4474 (-2255)
Lime	2280	3065		
Shale	3065	3255		
Shale & Lime	3255	3440		
Lime	3440	3472		
Shale	3472	3535		
Shale & Lime	3535	3790		
Lime	3790	4495		
<p>DST #1 4474' -4485' 30" -30" 660" -30" Rec. 2120' fluid: 500' SG&OCMW 180' SG&OCW, 120' W w/scum of oil, 1320' SW. BHP's 1401-1401# FP's 11-973#</p>				

USE ADDITIONAL SHEETS, IF NECESSARY, TO COMPLETE WELL RECORD.

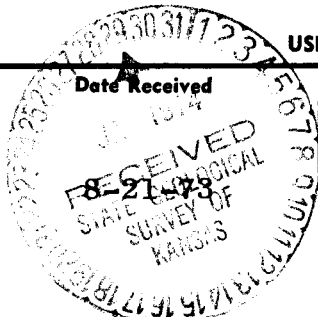

Nancy Laggart
Signature

Secretary

Title

8-21-73

Date

11-23-22W

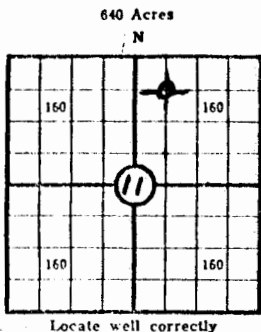

Lease Name: Chilson Well No. 1
 Well Located: Hodgeman County, KS
C NW NE SEC 11 TWP 23S RGE 22W
 Operator: Mack Oil Co.
 Address: 812 Union Center, Wichita, KS 67202
 Elevation: Ground 2212' D.F. 2217' K.B. 2219'
 Type Well: (Oil, gas, dry hole) dry hole

Drilling Commenced: 11-25-72 19 Drilling Completed: 12-5-72 19
 Well Completed: 12-5-72 19 Total Depth 4495'
 Initial Production: dry hole

Casing Record

Size: 8 5/8" Set at 330' Size: _____ Set at _____
 Size: _____ Set at _____ Size: _____ Set at _____

Liner Record

Size: _____ Set from _____ To _____

Cementing

<u>Casing Size</u>	<u>Sacks</u>	<u>Type Cement and Additives</u>
<u>8 5/8"</u>	<u>225 sx.</u>	<u>pozmix, 3% HA-5</u>
_____	_____	_____
_____	_____	_____

Perforations

<u>Formation</u>	<u>Perforated Interval and Number Shots</u>
_____	_____
_____	_____
_____	_____
_____	_____

Electric Log Run (Show type log and depths covered)

Laterolog-Gamma Ray-Neutron 330' - 4495'

(Fill in formation and related information on reverse side)

Show Drill Stem Tests,
Well Stimulation and
Production Tests

Formation	Top	Bottom
Surface soil & rock	0	40
Shale	40	154
Sand	154	213
Shale	213	333
Shale, shells, & redbed	333	810
Sand	810	956
Shale & Shells	956	1050
shale	1050	1350
Anhydrite	1350	1390
Shale	1390	1810
Shale & Lime	1810	2280
Lime	2280	3065
Shale	3065	3255
Shale & Lime	3255	3440
Lime	3440	3472
Shale	3472	3535
Shale & Lime	3535	3790
Lime	3790	4495

DST #1 4474'-4485' 30"-30"-60"-30"
Strong blow, Rec. 2120' fluid: 500' Sli G&O
C MDY W, 180' Sli G&O CW, 120' W w/scum of O,
1320' SW. BHP's 1401#-1401# FP's 11#-973#



11-53-53M