

**WELL COMPLETION REPORT AND DRILLER'S LOG**

API No. 15 — 083 — 20,712  
County Number

State Geological Survey  
 10 T. 23 R. 24 E  
 WICHITA, KANSAS  
 SE NW NE  
 County Hodgeman

Operator  
American Energies Corp.

Address  
575 Fourth Financial Center Wichita, Kansas 67202

Well No. #3 Lease Name Wilson

Footage Location  
990' feet from (N) X line 1650' feet from (E) 2021 line

Principal Contractor Husky Drilling Geologist Donald J. Malone

Spud Date 4-28-80 Date Completed 5-5-80 Total Depth 4625 P.B.T.D.

Directional Deviation Oil and/or Gas Purchaser

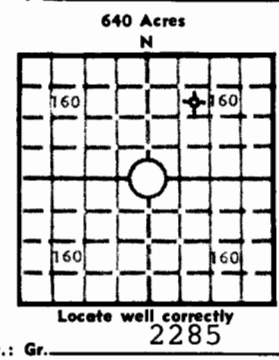

Elev.: Gr. 2290  
 DF 2290 KB 2290

**CASING RECORD**

Report of all strings set — surface, intermediate, production, etc.

Purpose of string	Size hole drilled	Size casing set (in O.D.)	Weight lbs/ft.	Setting depth	Type cement	Sacks	Type and percent additives
Surface	12 1/4"	8 5/8	20#	378	60-40POZ	250	2% gel 3% cc

**LINER RECORD**

**PERFORATION RECORD**

Top, ft.	Bottom, ft.	Sacks cement	Shots per ft.	Size & type	Depth interval

**TUBING RECORD**

Size	Setting depth	Packer set at

**ACID, FRACTURE, SHOT, CEMENT SQUEEZE RECORD**

Amount and kind of material used	Depth interval treated

**INITIAL PRODUCTION**

Date of first production Producing method (flowing, pumping, gas lift, etc.)

RATE OF PRODUCTION PER 24 HOURS	Oil	Gas	Water	Gas-oil ratio

Disposition of gas (vented, used on lease or sold) Producing interval (s)

INSTRUCTIONS: As provided in KCC Rule 82-2-125, within 90 days after completion of a well, one completed copy of this Drillers Log shall be transmitted to the State Geological Survey of Kansas, 4150 Monroe Street, Wichita, Kansas 67209. Copies of this form are available from the Conservation Division, State Corporation Commission, 245 No. Water, Wichita, Kansas 67202. Phone AC 316-522-2206. If confidential custody is desired, please note Rule 82-2-125. Drillers Logs will be on open file in the Oil and Gas Division, State Geological Survey of Kansas, Lawrence, Kansas 66044.

Operator  
American Energies Corporation

DESIGNATE TYPE OF COMP.: OIL, GAS,  
DRY HOLE, SWDW, ETC.:  
D&A

Well No. 3

Lease Name  
Wilson

S 10 T 23 S R 24 <sup>X</sup>E  
W

**WELL LOG**

Show all important zones of porosity and contents thereof; cored intervals, and all drill-stem tests, including depth interval tested, cushion used, time tool open, flowing and shut-in pressures, and recoveries.

SHOW GEOLOGICAL MARKERS, LOGS RUN,  
OR OTHER DESCRIPTIVE INFORMATION.

FORMATION DESCRIPTION, CONTENTS, ETC.	TOP	BOTTOM	NAME	DEPTH
DST#1 4500-4541 30-45-30-60 Weak blow throughout, rec. 120' GIP, 50' HOCM, 2' oil. SIPS 164 & 164#, IFP & FFP 70-70#.				
E-Log				
Anhyd	1475	+ 815		
Heeb	3809	-1519		
Lsg	3856	-1566		
BKC	4278	-1988		
Cgl	4502	-2212		
Miss.	4523	-2233		
RTD	4625			

USE ADDITIONAL SHEETS, IF NECESSARY, TO COMPLETE WELL RECORD.

Date Received

*Ronald J. Schrader*  
Signature  
Operations Manager  
Title  
August 25, 1980  
Date