

KANSAS DRILLERS LOG

State Geological Survey
WICHITA BRANCH

S. 11 T. 23S R. 24 EX
590' FNL & 410' W FWL
Loc. NW/4 11-23S-24W

API No. 15 — 083 — 20,600
County Number

County Hodgeman

Operator
American Energies Corp.

Address
575 Fourth Financial Center

Well No. 1 Lease Name Knoefler

Footage Location
590 feet from (N) line 410 feet from (E) (W) line

Principal Contractor Brandt Drilling Geologist Charley Shank

Spud Date 7-11-78 Total Depth 4590' P.B.T.D.

Date Completed 7-22-78 Oil Purchaser Koch Oil

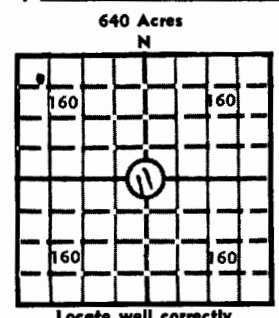

Elev.: Gr. 2276

DF KB 2289

CASING RECORD

Report of all strings set — surface, intermediate, production, etc.

Purpose of string	Size hole drilled	Size casing set (in O.D.)	Weight lbs/ft.	Setting depth	Type cement	Sacks	Type and percent additives
Surface		8 5/8"	24	479	Common	225	3%cc 2% gel
Production		5 1/2"	15 1/2	4593	60/40POZ	100	10% salt

LINER RECORD

None

PERFORATION RECORD

Top, ft.	Bottom, ft.	Sacks cement	Shots per ft.	Size & type	Depth interval
			2		4529-42'

TUBING RECORD

Size	Setting depth	Packer set at
2"	4516	None

ACID, FRACTURE, SHOT, CEMENT SQUEEZE RECORD

Amount and kind of material used	Depth interval treated
1000 Gal. MOD 202 ACID	4529-42'

INITIAL PRODUCTION

Date of first production 9-11-78		Producing method (flowing, pumping, gas lift, etc.) Pumping			
RATE OF PRODUCTION PER 24 HOURS	Oil 36 bbls.	Gas 0 MCF	Water 0 bbls.	Gas-oil ratio -	CFPB
Disposition of gas (vented, used on lease or sold) -			Producing interval(s) 4529-42'		

INSTRUCTIONS: As provided in KCC Rule 82-2-125, within 90 days after completion of a well, one completed copy of this Drillers Log shall be transmitted to the State Geological Survey of Kansas, 4150 Monroe Street, Wichita, Kansas 67209. Copies of this form are available from the Conservation Division, State Corporation Commission, 3830 So. Meridian (P.O. Box 17027), Wichita, Kansas 66217. Phone AC 316-522-2206. If confidential custody is desired, please note Rule 82-2-125. Drillers Logs will be on open file in the Oil and Gas Division, State Geological Survey of Kansas, Lawrence, Kansas 66044.

Operator American Energies Corporation

DESIGNATE TYPE OF COMP.: OIL, GAS, DRY HOLE, SWDW, ETC.:
Oil

Well No. 1 Lease Name Knoefler

S 11 T 23 S 24 W

WELL LOG

Show all important zones of porosity and contents thereof; cored intervals, and all drill-stem tests, including depth interval tested, cushion used, time tool open, flowing and shut-in pressures, and recoveries.

SHOW GEOLOGICAL MARKERS, LOGS RUN, OR OTHER DESCRIPTIVE INFORMATION.

FORMATION DESCRIPTION, CONTENTS, ETC.	TOP	BOTTOM	NAME	DEPTH																																	
<table border="1"> <thead> <tr> <th>FORMATION TOPS</th> <th>LOG</th> <th>SAMPLES</th> </tr> </thead> <tbody> <tr> <td>Anhydrite</td> <td>1475 (+814)</td> <td></td> </tr> <tr> <td>Heebner</td> <td>3804 (-1515)</td> <td>3800 (-1511)</td> </tr> <tr> <td>Lansing</td> <td>3852 (-1563)</td> <td>3848 (-1559)</td> </tr> <tr> <td>Stark</td> <td>4153 (-1864)</td> <td>4149 (-1860)</td> </tr> <tr> <td>B/Kansas City</td> <td>4278 (-1989)</td> <td>4274 (-1985)</td> </tr> <tr> <td>Fort Scott</td> <td>4423 (-2134)</td> <td>4418 (-2129)</td> </tr> <tr> <td>Cherokee</td> <td>4449 (-2160)</td> <td>4446 (-2157)</td> </tr> <tr> <td>Conglomerate</td> <td>4502 (-2213)</td> <td>4499 (-2210)</td> </tr> <tr> <td>Mississippian</td> <td>4527 (-2238)</td> <td>4511 (-2222)</td> </tr> <tr> <td>Total Depth</td> <td>4593 (-2304)</td> <td>4590 (-2301)</td> </tr> </tbody> </table>	FORMATION TOPS	LOG	SAMPLES	Anhydrite	1475 (+814)		Heebner	3804 (-1515)	3800 (-1511)	Lansing	3852 (-1563)	3848 (-1559)	Stark	4153 (-1864)	4149 (-1860)	B/Kansas City	4278 (-1989)	4274 (-1985)	Fort Scott	4423 (-2134)	4418 (-2129)	Cherokee	4449 (-2160)	4446 (-2157)	Conglomerate	4502 (-2213)	4499 (-2210)	Mississippian	4527 (-2238)	4511 (-2222)	Total Depth	4593 (-2304)	4590 (-2301)				
FORMATION TOPS	LOG	SAMPLES																																			
Anhydrite	1475 (+814)																																				
Heebner	3804 (-1515)	3800 (-1511)																																			
Lansing	3852 (-1563)	3848 (-1559)																																			
Stark	4153 (-1864)	4149 (-1860)																																			
B/Kansas City	4278 (-1989)	4274 (-1985)																																			
Fort Scott	4423 (-2134)	4418 (-2129)																																			
Cherokee	4449 (-2160)	4446 (-2157)																																			
Conglomerate	4502 (-2213)	4499 (-2210)																																			
Mississippian	4527 (-2238)	4511 (-2222)																																			
Total Depth	4593 (-2304)	4590 (-2301)																																			

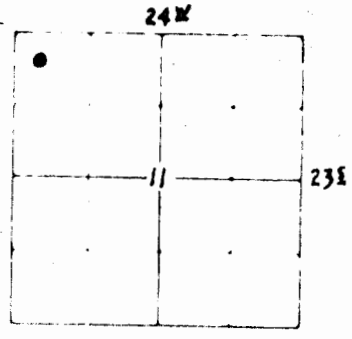

USE ADDITIONAL SHEETS, IF NECESSARY, TO COMPLETE WELL RECORD.

Date Received	<i>Ronald J. Schraede</i>
	Signature
	Operations Manager
	Title
	3-4-81
	Date