

IMPORTANT
Kans. Geo. Survey request
samples on this well.

KANSAS DRILLERS LOG

S. 22 T. 23 R. 34 ^W

Loc. C W2

County Finney

API No. 15 — 055 — 20,294
County Number

Operator
Champlin Petroleum Company

Address
6051 North Brookline, Suite 116, Oklahoma City, Okla 73112

Well No. #8 Lease Name Garden "C"

Footage Location
2640 feet from (N) line 1320 feet from (E) (W) line

Principal Contractor Service Drilling Company Geologist D. Elich

Spud Date August 6, 1979 Total Depth 3015 P.B.T.D. 2974

Date Completed October 19, 1979 Purchaser Gas Kansas-Nebraska

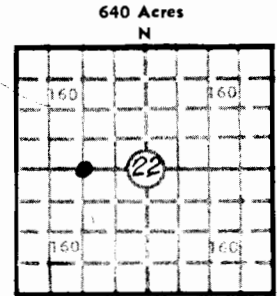

Elev.: Gr. 2950

DF NA KB 2058/5

CASING RECORD

Report of all strings set—surface, intermediate, production, etc.

Purpose of string	Size hole drilled	Size casing set (in O.D.)	Weight lbs/ft.	Setting depth	Type cement	Sacks	Type and percent additives
Surface	12 1/4"	8 5/8"	24#	764	Class H 65-35 poz.	150 225	
Production	7 7/8"	5 1/2"	14#	3014	Litewate	450	

LINER RECORD

PERFORATION RECORD

Top, ft.	Bottom, ft.	Sacks cement	Shots per ft.	Size & type	Depth interval
			3	.38	2766-86'
			1.5	.38	2792-2804
			1.5	.38	2814-2828
			1.5	.38	2832-38

TUBING RECORD

Size	Setting depth	Packer set at
2-3/8"	2857'	

ACID, FRACTURE, SHOT, CEMENT SQUEEZE RECORD

Amount and kind of material used	Depth interval treated
Frac-120,000 gal. 1% KCl, 120,000 lbs. sd.	2766-2838
Acid-500 gal. 15% @ 15 bbl/min.	2766-2838
Acid-5000 gal. 7 1/2%	2766-2838

INITIAL PRODUCTION

Date of first production <u>October 19, 1979</u>	Producing method (flowing, pumping, gas lift, etc.) <u>pumping</u>
RATE OF PRODUCTION PER 24 HOURS	Oil <u>131 MCFD</u> Gas <u>MCF</u> Water <u>126 BLW</u> Gas-oil ratio <u>CFPB</u>
Disposition of gas (vented, used on lease or sold) <u>Vented</u>	Producing interval(s) <u>2766-2838</u>

INSTRUCTIONS: As provided in KCC Rule 82-2-125, within 90 days after completion of a well, one completed copy of this Drillers Log shall be transmitted to the State Geological Survey of Kansas, 4150 Monroe Street, Wichita, Kansas 67209. Copies of this form are available from the Conservation Division, State Corporation Commission, 3830 So. Meridian (P.O. Box 17027), Wichita, Kansas 66217. Phone AC 316-522-2206. If confidential custody is desired, please note Rule 82-2-125. Drillers Logs will be on open file in the Oil and Gas Division, State Geological Survey of Kansas, Lawrence, Kansas 66044.

PI

22-23-34 W

CHAMPLIN PETROLEUM CO.

Garden C-8 Well
Finney County, Kansas

OPERATIONS COMMENCED: 8/6/79
OPERATIONS COMPLETED: 8/10/79

DRILLING LOG

8/6	0 - 764	Sand
8/7	764 - 1429	Red Bed, Sand
8/8	1429 - 2388	Sand, Shale
8/9	2388 - 2852	Shale, Lime
8/10	2852 - 2975	Lime

CASING RECORD

8/7	Ran 21 jts. of 8-5/8", 24# casing. Set @ 764'. Cemented with 225 sacks 65/35 pozmix, 2% C.C. and 150 sacks Class H, 3% C.C.
8/10	Ran 74 jts. of 5-1/2", 14# casing. Set @ 3015'. Cemented with 450 sacks Howco lite and 150 sacks 50/50 pozmix, 18% salt.