

KANSAS WELL LOG BUREAU - KANSAS GEOLOGICAL SOCIETY.  
 Union National Bank Bldg, Wichita, Kansas.

OLSON-SHELL PETRO,  
 J. R. Goering No. B-3

SEC. 35 T. 23S R. 4W.  
 NWc NW  
 330' NL. 330' W.L. NW $\frac{1}{4}$

Total Depth. 3593.  
 Comm. 7-29-34. Comp. 8-27-34.  
 Shot or Treated.  
 Contractor. Olson Drilling Co.  
 Issued. 9-29-34.

County. Reno.

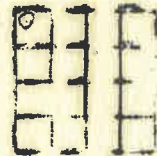

CASING.

133/8" 482' 85/8" 3574'

Elevation.

Figures Indicate Bottom of Formations.

Production. 1939 B. 24 Hr.  
 Potential test.

sand	50	shale	3539
sand and shale	185	shale	3572
shale and shells	205	sand	3575
broken shale	243	chert	3577
lime shells	255	oil stains and show oil	
shale	273	Standardizing.	
shale and shells	586	lime	3581
shale and lime	1045	lime	3586
shale	1090	2000' oil in hole at 3581 10 hrs.	
lime	1110	flowing by heads 3586	
shale and shells	1133	lime and chert	3589
shale	1215	lime and chert	3593 T.D.
shale and shells	1395	Pay (?) oil and gas 3577-89	
shale	1514	flow 220 oil and no water 6 hours.	
shale	1805		
shale and lime	1895		
shale and shells	1995		
shale	2019		
shale and lime	2060		
lime	2068		
broken shale	2096		
shale and lime	2349		
shale and shells	2409		
shale	2490		
shale sdy	2502		
lime	2531		
broken lime	2583		
lime	2628		
broken lime	2669		
lime and shale (br)	2750		
lime	2874		
lime	2900		
lime and shale	2980		
lime	2995		
lime and shale	3011		
shale and shells	3151		
shale	3238		
chat	3433		
lime and shale	3497		