

KANSAS

PL

IMPORTANT  
Kans. Geo. Survey request  
samples on this well.

WELL COMPLETION REPORT AND  
DRILLER'S LOG

API-No. 15

County

Number

SEP 8 0 REC'D

S. 17 T. 24S R. 30W E W

Loc. SE SE SW

County Gray

Operator

Beren Corporation

Address

970 Fourth Financial Center, Wichita, Kansas 67202

Well No.

1

Lease Name

WERNER

Footage Location

feet from (N) (S) line

feet from (E) (W) line

Principal Contractor

Thunderbird Drilling

Geologist

Tyler Sanders

Spud Date

Aug. 10, 1980

Date Completed

Aug. 22, 1980

Total Depth

5200

P.B.T.D.

Directional Deviation

Oil and/or Gas Purchaser

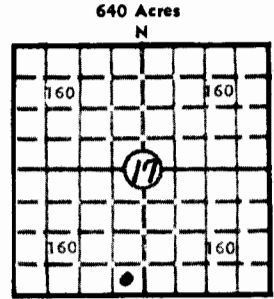

Locate well correctly

2869

Elev.: Gr.

DF

KB

2874

CASING RECORD

Report of all strings set — surface, intermediate, production, etc.

| Purpose of string | Size hole drilled | Size casing set (in O.D.) | Weight lbs/ft. | Setting depth | Type cement  | Sacks | Type and percent additives |
|-------------------|-------------------|---------------------------|----------------|---------------|--------------|-------|----------------------------|
| Surface           | 12-3/4            | 8-5/8                     | 20#            | 476'          | 60-40 pozmix | 300   | 3% CC, 2% gel              |
|                   |                   |                           |                |               |              |       |                            |
|                   |                   |                           |                |               |              |       |                            |
|                   |                   |                           |                |               |              |       |                            |

LINER RECORD

PERFORATION RECORD

| Top, ft. | Bottom, ft. | Sacks cement | Shots per ft. | Size & type | Depth interval |
|----------|-------------|--------------|---------------|-------------|----------------|
|          |             |              |               |             |                |

TUBING RECORD

| Size | Setting depth | Packer set at |
|------|---------------|---------------|
|      |               |               |

ACID, FRACTURE, SHOT, CEMENT SQUEEZE RECORD

| Amount and kind of material used | Depth interval treated |
|----------------------------------|------------------------|
|                                  |                        |
|                                  |                        |
|                                  |                        |

INITIAL PRODUCTION

|  |  |   |     |                        |               |
|--|--|---|-----|------------------------|---------------|
| Date of first production                           |  | Producing method (flowing, pumping, gas lift, etc.) |     |                        |               |
| RATE OF PRODUCTION PER 24 HOURS                    |  | Oil   | Gas | Water                  | Gas-oil ratio |
|  |  | bbls.   | MCF | bbls.                  | CFPB          |
| Disposition of gas (vented, used on lease or sold) |  |   |     | Producing interval (s) |               |

INSTRUCTIONS: As provided in KCC Rule 82-2-125, within 90 days after completion of a well, one completed copy of this Drillers Log shall be transmitted to the State Geological Survey of Kansas, 4150 Monroe Street, Wichita, Kansas 67209. Copies of this form are available from the Conservation Division, State Corporation Commission, 245 No. Water, Wichita, Kansas 67202. Phone AC 316-522-2206. If confidential custody is desired, please note Rule 82-2-125. Drillers Logs will be on open file in the Oil and Gas Division, State Geological Survey of Kansas, Lawrence, Kansas 66044.

Operator Beren Corporation DESIGNATE TYPE OF COMP.: OIL, GAS, DRY HOLE, SWDW, ETC.:

Well No. 1 Lease Name WERNER Dry hole

S 17 T 24S R 30 E W

**WELL LOG**

Show all important zones of porosity and contents thereof; cored intervals, and all drill-stem tests, including depth interval tested, cushion used, time tool open, flowing and shut-in pressures, and recoveries. SHOW GEOLOGICAL MARKERS, LOGS RUN, OR OTHER DESCRIPTIVE INFORMATION.

| FORMATION DESCRIPTION, CONTENTS, ETC. | TOP  | BOTTOM | NAME | DEPTH |
|---------------------------------------|------|--------|------|-------|
| Surface Hole                          | 0    | 446    |      |       |
| Sand and shale                        | 446  | 735    |      |       |
| Shale                                 | 735  | 1100   |      |       |
| Shale and sand and shells             | 1100 | 1432   |      |       |
| Shale and sand                        | 1432 | 1550   |      |       |
| Sand                                  | 1550 | 1710   |      |       |
| Shale, Red bed, & sand                | 1710 | 2026   |      |       |
| Anhydrite                             | 2026 | 2042   |      |       |
| Shale                                 | 2042 | 2160   |      |       |
| Shale and sand                        | 2160 | 2570   |      |       |
| Shale and lime                        | 2570 | 2760   |      |       |
| Shale                                 | 2760 | 2805   |      |       |
| Lime and shale                        | 2805 | 3000   |      |       |
| Shale and lime                        | 3000 | 3370   |      |       |
| Lime and shale                        | 3370 | 3565   |      |       |
| Shale with lime streaks               | 3565 | 3735   |      |       |
| Shale and lime                        | 3735 | 3930   |      |       |
| Lime and shale                        | 3930 | 4360   |      |       |
| Lime                                  | 4360 | 5200   |      |       |
| RTD                                   | 5200 |        |      |       |

USE ADDITIONAL SHEETS, IF NECESSARY, TO COMPLETE WELL RECORD.

Date Received

  
 Signature  
 Don Beauchamp - Geologist  
 Title  
 September 3, 1980  
 Date