

DX 78-1 Stafford

KANSAS

Section 25 Township 25 Range 13W

Well No. #1 Russel

Company D. R. Lauck

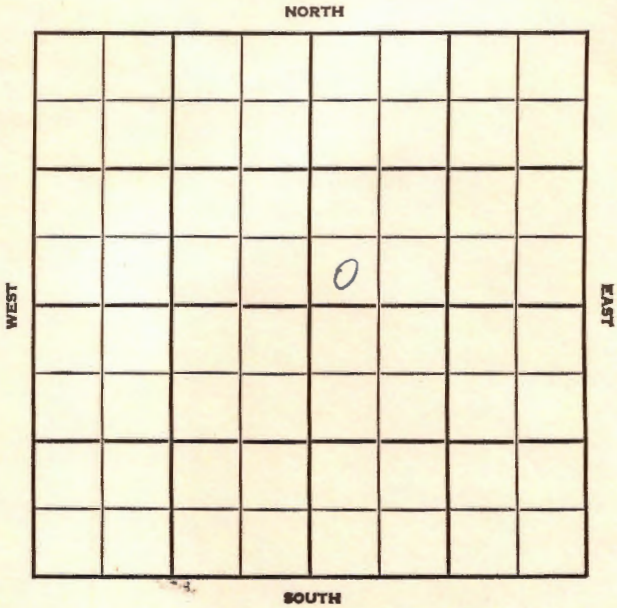

SEC. **HOT FILE** TWP. R. 25 25 S 13 W

WELL NO. # 1 Russell Estate FARM

COMPANY D.R. Lauck Oil Co. Inc. (EXPLORATORY* OBOC)

CONTRACTOR

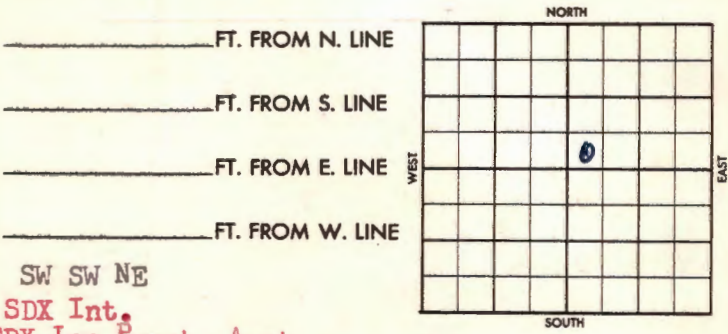

SW SW NE
SDX Int.
SDX-Lse Purch. Agrt.

1956 ELEVATION 1903' RB REPORT (TWH6-BH7)

4400' Arbuckle Test
5/29 Commencement date: ?
Completion date: ?
6/5 Spudded 6-2-56 (FR Tkt)
8-5/8" @ 229 w/205 sax. Anhy. 740'
Drlg. 1985' (Card-Lauck Drlg. Co)
6/6 Drlg. 2465' (DR#111) "
6/7 Drlg. 2925' "
6/8 Drlg. 3240' "
6/9 Drlg. 3540' "
6/10 T. Heebner 3466' (-1563)
T. Brown Lime 3613 (-1710)
T. Lansing 3635' (-1732)
Drlg. 3730' "
6/11 Drlg. 3880' "
6/12 Drlg. 4010' "
6/13 Drlg. 4098' "
6/14 TD 4098'. DST 4088-4098' (DR#116)
6/15 DST #1, 4052-4072', open 30 min, weak
blow 7 min, rec 20' mud. BHP O# 20"
DST #2, 4088-4092', open 1 hr. weak
blow 1 hr, rec 1800' muddy salt wtr.
DST #3, 4180-4190', open 30 min, weak
blow 6 min, rec 15' mud. BHP O# 20".
B.K.C. 3916' (-2013) T. Miss 4050'
(-2147) T. Viola 4087 (-2184)
T. Simpson 4169 (-2266) Drlg. 4190'
(Card- Lauck Drlg.)

OVER

1956
 6/15 Drlg. 4300'
 Top Arbuckle 4224 (-2321) (Card-Lauck)
 6/16 Drlg. 4425' "
 6/17 Drlg. 4555' "
 6/18 TD 4416'. D & A "
 6-21 No report
 6-22 TD 4616'. Plugged & Abandoned
 (DR #122)
 6-28 DST 4057-72, op 30 min, rec 20' mud
 BHP Off in 20 min.
 DST 4088-98', op 1 hr, rec 100' MSW
 BHP 1220#
 DST 4180-90', op 30 min, rec 15' mud
 BHP Off
 D & A
 Log Tops: Heebner 3456', B. Lm. 3621',
 Lans. 3638', B.K.C. 3914', ~~Miss.~~
 Miss. 4044', Vio. 4088',
 Simp. 4154', Arb. 4226'
 TD 4616'

ABANDONED

7/16 Advised Contract Section - D & A

County Stafford Elev. _____
 Sec. 25 Twp. 25 Rge. 13W
 Company D. R. Lauck
 Farm Name Russel No. 1

| TOPS | DEPTH | LOG | DATUM |
|--------|-------|-----|-------|
| Anh. | 710 | | |
| TP. | | | |
| H. | | | |
| Tr. | | | |
| Dg. | | | |
| BL. | | | |
| L. | | | |
| K.C. | | | |
| B.K.C. | | | |
| Ce. | | | |
| C. | | | |
| M. | | | |
| M. | | | |
| K. | | | |
| Mz. | | | |
| Mo. | | | |
| V. | | | |
| S. | | | |
| S. | | | |
| A. | | | |
| R. | | | |
| Pe. | | | |
| G. | | | |
| TD. | | | |

Loc. in Sec. SW SW NE
 Geol. _____
 Contr. _____
 Pool _____

FIRST REPORT
 0
 SDX-Int
 JUN 6 '56

Date Comm. 6-1-56
 8" @ 229/225 drlg. 1028

26
 JUN 8 1956
 M.M.

Co.
 Loc.
 No.
 Sec.
 T.
 R.

26

County Stafford Elev. 1901
 Sec. 25 Twp. 25 Rge. 13W
 Company P. E. Lauck
 Farm Name Russel No. 1

| | DEPTH | LOG | DATUM |
|--------|-------|------|-------|
| | 740 | | |
| H | 3466 | 3456 | |
| Tr. | | | |
| Dg. | | | |
| Bl. | 3613 | 3621 | |
| L. | 3635 | 3638 | |
| K.C. | | | |
| B.K.C. | 3916 | 3914 | |
| Ce. | | | |
| C. | | | |
| M. | 4050 | 4044 | |
| M. | | | |
| K. | | | |
| Mz. | | | |
| Mo | | | |
| V. | 4087 | 4088 | |
| S. | 4169 | 4154 | |
| S. | | | |
| A. | 4224 | 4226 | |
| R. | | | |
| Pe. | | | |
| G. | | | |
| T.D. | | 4616 | |

Loc. in Sec. _____
SW SW NE
 Geol. _____
 Contr. _____
 Pool _____

| | |
|-----------|---|
| ABANDONED | |
| 0 | |
| + | + |

Date Comm. 6-1-56 JUN 20 1956

8" @ 229/225 drl. 1028 JUN 13 '56
~~3972~~ JUN 20 '56 X # ~~3466~~ ~~3613~~
 Miss' 4050 DST 4057-72 gr 30"
 see 20' Md BHP 0/20" V10. 4087
 DST 4088-98 1 hr see 100' MSW BHP
 1220 SP 4169 DST 4180-98 gr 30"
 see 15' Md BHP 0 # ~~4390~~
 D & A