

KANSAS DRILLERS LOG

WICHITA, BRANCH

S. 22 T. 25S R. 14 ^{KX}/_W

API No. 15 — 185 — 20562
 County Number

Loc. _____

County _____

Operator
DYCO PETROLEUM CORPORATION

Address
1700 Philtower Building, Tulsa, Oklahoma 74103

Well No. #1 Lease Name G. L. Smith

Footage Location
2310' feet from (N) XX line 330' feet from (E) XXX line

Principal Contractor Red Tiger Drilling Company Geologist Bill F. Bussey

Spud Date 2/19/75 Total Depth 4380' P.B.T.D. - -

Date Completed 3/03/75 Oil Purchaser - - -

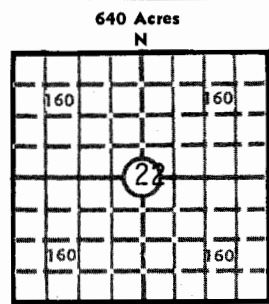

Elev.: Gr. 1973'

DF - KB -

CASING RECORD

Report of all strings set— surface, intermediate, production, etc.

Purpose of string	Size hole drilled	Size casing set (in O.D.)	Weight lbs/ft.	Setting depth	Type cement	Sacks	Type and percent additives
Surface	12 1/4"	8 5/8"	23#	428'	Common	350	2% gel, 3% CaCl

LINER RECORD

PERFORATION RECORD

Top, ft.	Bottom, ft.	Sacks cement	Shots per ft.	Size & type	Depth interval
- -	- -	- -	- -	- -	- -

TUBING RECORD

Size	Setting depth	Packer set at
- -	- -	- -

ACID, FRACTURE, SHOT, CEMENT SQUEEZE RECORD

Amount and kind of material used	Depth interval treated
- - -	

WELL P & A

INITIAL PRODUCTION

Date of first production		Producing method (flowing, pumping, gas lift, etc.)			
RATE OF PRODUCTION PER 24 HOURS	Oil	Gas	Water	Gas-oil ratio	
	bbls.	MCF	bbls.	CFPB	
Disposition of gas (vented, used on lease or sold)			Producing interval (s)		

INSTRUCTIONS: As provided in KCC Rule 82-2-125, within 90 days after completion of a well, one completed copy of this Drillers Log shall be transmitted to the State Geological Survey of Kansas, 4150 Monroe Street, Wichita, Kansas 67209. Copies of this form are available from the Conservation Division, State Corporation Commission, 3830 So. Meridian (P.O. Box 17027), Wichita, Kansas 66217. Phone AC 316-522-2206. If confidential custody is desired, please note Rule 82-2-125. Drillers Logs will be on open file in the Oil and Gas Division, State Geological Survey of Kansas, Lawrence, Kansas 66044.

Operator

DYCO PETROLEUM CORPORATION

DESIGNATE TYPE OF COMP.: OIL, GAS,
DRY HOLE, SWDW, ETC.:

Well No. #1	Lease Name G. L. Smith	Dryhole
----------------	---------------------------	---------

S 22 T 25S R 14 ^{KX}_W**WELL LOG**

Show all important zones of porosity and contents thereof; cored intervals, and all drill-stem tests, including depth interval tested, cushion used, time tool open, flowing and shut-in pressures, and recoveries.

SHOW GEOLOGICAL MARKERS, LOGS RUN,
OR OTHER DESCRIPTIVE INFORMATION.

FORMATION DESCRIPTION, CONTENTS, ETC.	TOP	BOTTOM	NAME	DEPTH
Sod & Sand	0'	204'	DST #1	3864'-3883'
Shale	204'	250'	DST #2	4187'-4225'
Shale & Shells	250'	430'		
Shale	430'	522'		
Redbed & Shale	522'	865'		
Anhydrite	865'	876'		
Shale & Shells	876'	1700'		
Shale	1700'	1800'		
Lime w/Shale	1800'	2273'		
Lime	2273'	2395'		
Shale & Lime	2395'	2641'		
Lime	2641'	4123'		
Lime & Chert	4123'	4186'		
Chert, Lime w/Shale	4186'	4225'		
Lime & Chert	4225'	4380'		
T. D.		4380'		

USE ADDITIONAL SHEETS, IF NECESSARY, TO COMPLETE WELL RECORD.

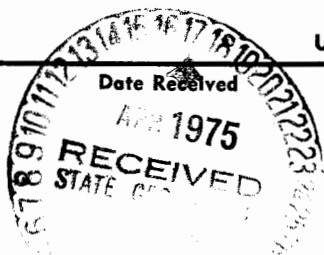

Bill F. Bussey
 Bill F. Bussey, Signature
 Area Exploration Manager
 Title

March 11, 1975

Date

DRILLERS LOG

No. 1 Smith

CASING RECORD:
5/8" @ 428'
350 sx. cmt.

COMPANY: Dyco Petroleum Corp.
CONTRACTOR: Red Tiger Drilling Co.
COMMENCED: 2-19-75
COMPLETED: 3-03-75

DESCRIPTION:
SE SE NE
22-25S-14W
Stafford County,
Kansas

TOTAL DEPTH: 4380'

ELEVATION:

<u>FORMATION</u>	<u>FROM</u>	<u>TO</u>	<u>REMARKS</u>
Sod & Sand	0	204	
Shale	204	250	
Shale & Shells	250	430	
Shale	430	522	
Redbed & Shale	522	865	
Anhydrite	865	876	
Shale & Shells	876	1700	
Shale	1700	1800	
Lime w/Shale	1800	2273	
Lime	2273	2395	
Shale & Lime	2395	2641	
Lime	2641	4123	
Lime & Chert	4123	4186	
Chert, Lime w/Shale	4186	4225	
Lime & Chert	4225	4380	

I certify that this is a true and correct copy of the above log to the best of my knowledge.

RED TIGER DRILLING COMPANY

Linda H. Dickens
Linda H. Dickens

Subscribed and sworn to before me this 6th day of March, 1975.

D. Ann Drennan
Notary Public

My Commission Expires:

December 28, 1977

