

WICHITA BRANCH
KANSAS DRILLERS LOG

API No. 15 ————— OWWO
County Number

S. 22 T. 25 R. 15 ^R/_W
Loc. C NW NW SW
County Stafford

Operator
Barnett Oil, Inc.

Address
1625 Vickers KSB&T Building Wichita, Kansas 67202

Well No. #1 Lease Name Hart "A" OWWO

Footage Location
330 feet from (N) line 330 feet from (W) line of SW/4

Principal Contractor Abercrombie Drilling Co. Geologist None

Spud Date June 27, 1976 Total Depth 4379' P.B.T.D. 4271'

Date Completed July 1, 1976 Oil Purchaser ----- Shut in gas well

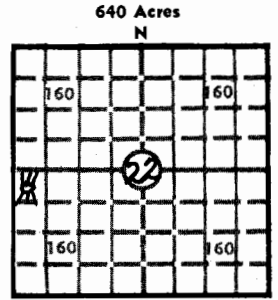

Elev.: Gr. 2022'
DF KB 2027'

CASING RECORD

Report of all strings set — surface, intermediate, production, etc.

Purpose of string	Size hole drilled	Size casing set (in O.D.)	Weight lbs/ft.	Setting depth	Type cement	Sacks	Type and percent additives
Surface	unknown	8 5/8" (already in Place)	unknown	230'	Unknown	Unknown	Unknown
Production	7 7/8"	4 1/2"	10 1/2#	4315'	Common Common	200 150	3% gel Salt-saturated

LINER RECORD

PERFORATION RECORD

Top, ft.	Bottom, ft.	Sacks cement	Shots per ft.	Size & type	Depth interval
			4	Jet	4204'-14'
			4	Jet	4236'-39'

TUBING RECORD

ACID, FRACTURE, SHOT, CEMENT SQUEEZE RECORD

Amount and kind of material used	Depth interval treated
Acidized with 500 gal. mud acid, fractured with 50,000 gallons water + 50,000# sand, three stages	4204'-14' and 4236'-39'

INITIAL PRODUCTION

Date of first production <u>July 10, 1976</u>	Producing method (flowing, pumping, gas lift, etc.) <u>Flowing</u>
RATE OF PRODUCTION PER 24 HOURS	Oil <u>-----</u> bbls. Gas <u>200</u> MCF Water <u>Trace</u> bbls. Gas-oil ratio <u>CFPB</u>
Disposition of gas (vented, used on lease or sold) <u>Shut in gas well</u>	Producing interval (s) <u>4204'-14' & 4236'-39'</u>

INSTRUCTIONS: As provided in KCC Rule 82-2-125, within 90 days after completion of a well, one completed copy of this Drillers Log shall be transmitted to the State Geological Survey of Kansas, 4150 Monroe Street, Wichita, Kansas 67209. Copies of this form are available from the Conservation Division, State Corporation Commission, 3830 So. Meridian (P.O. Box 17027), Wichita, Kansas 66217. Phone AC 316-522-2206. If confidential custody is desired, please note Rule 82-2-125. Drillers Logs will be on open file in the Oil and Gas Division, State Geological Survey of Kansas, Lawrence, Kansas 66044.

Operator Barnett Oil, Inc. DESIGNATE TYPE OF COMP.: OIL, GAS, DRY HOLE, SWDW, ETC.: Gas (Shut in)

Well No. 1 Lease Name Hart A

S 22 T 25 R 15 W

WELL LOG
 Show all important zones of porosity and contents thereof; cored intervals, and all drill-stem tests, including depth interval tested, cushion used, time tool open, flowing and shut-in pressures, and recoveries. SHOW GEOLOGICAL MARKERS, LOGS RUN, OR OTHER DESCRIPTIVE INFORMATION.

FORMATION DESCRIPTION, CONTENTS, ETC.	TOP	BOTTOM	NAME	DEPTH
No open hole log No D.S.T. Cased hole G-R-N & C.B.L. by Welex Mississippi 4201' (-2174) Kinderhook 4235' (-2208)				

USE ADDITIONAL SHEETS, IF NECESSARY, TO COMPLETE WELL RECORD.

Date Received

Signature: *Will F. Jewett*
 Vice President, Operations
 Title
 February 22, 1977
 Date